

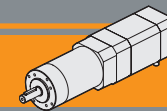

Motoriduttori brushless CC epicicloidali  
**Brushless DC planetary gearmotors**







<b>Indice</b>	<b>Index</b>	Pag. Page
Caratteristiche tecniche	<i>Technical features</i>	<b>AC2</b>
Designazione	<i>Classification</i>	<b>AC2</b>
Simbologia	<i>Symbols</i>	<b>AC2</b>
Lubrificazione	<i>Lubrication</i>	<b>AC2</b>
Carichi radiali	<i>Radial loads</i>	<b>AC3</b>
Rapporti	<i>Ratios</i>	<b>AC3</b>
PK32BB con motore brushless BL005	<i>PK32BB with brushless motor BL005</i>	<b>AC4</b>
PM32 con motore brushless BL005	<i>PM32 with brushless motor BL005</i>	<b>AC4</b>
PM42 con motore brushless BL012.240	<i>PM42 with brushless motor BL012.240</i>	<b>AC6</b>
PM42 con motore brushless BL018.240	<i>PM42 with brushless motor BL018.240</i>	<b>AC6</b>
PM42 con motore brushless BL025.24E	<i>PM42 con motore brushless BL025.24E</i>	<b>AC8</b>
PM52 con motore brushless BL032.240	<i>PM52 con motore brushless BL032.240</i>	<b>AC10</b>
PM52 con motore brushless BL043.240	<i>PM52 con motore brushless BL043.240</i>	<b>AC10</b>
PM62 con motore brushless BL032.240	<i>PM62 with brushless motor BL032.240</i>	<b>AC12</b>
PM62 con motore brushless BL043.240	<i>PM62 with brushless motor BL043.240</i>	<b>AC12</b>
PM62 con motore brushless BL070.480	<i>PM62 with brushless motor BL070.480</i>	<b>AC14</b>

Questa sezione annulla e sostituisce ogni precedente edizione o revisione. Qualora questa sezione non Vi sia giunta in distribuzione controllata, l'aggiornamento dei dati ivi contenuto non è assicurato. **In tal caso la versione più aggiornata è disponibile sul nostro sito internet [www.transtecno.com](http://www.transtecno.com)**

*This section replaces any previous edition and revision. If you obtained this catalogue other than through controlled distribution channels, the most up to date content is not guaranteed. In this case the latest version is available on our web site [www.transtecno.com](http://www.transtecno.com)*

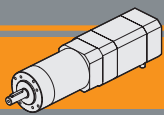

# Motoriduttori brushless CC epicicloidali

## Brushless DC planetary gearmotors

### Caratteristiche tecniche

### Technical features

Le caratteristiche principali dei motoriduttori epicicloidali brushless CC della serie PM sono:

- Alimentazione in bassa tensione 24/36/48 Vcc
- Possibilità di montaggio encoder
- Lubrificazione permanente a grasso

#### Soluzione PM:

- Completamente in metallo
- Doppio cuscinetto su albero di uscita

#### Soluzione PK-BB:

- Mix plastica / metallo
- Doppio cuscinetto su albero di uscita

The main features of brushless DC planetary gearmotors range PM series are:

- Low voltage power supply 24/36/48 Vdc
- Suitable for encoder assembly
- Permanent grease long life lubrication

#### PM solution:

- Completely made out of metal
- Double ball bearing on output shaft

#### PK-BB solution:

- Plastic / metal mix
- Double ball bearing on output shaft

### Designazione

### Classification

RIDUTTORE / GEARBOX					MOTORE / MOTOR			
PM	42	2	46	-	BL012.240	24V	Encoder	
Tipo Type	Grandezza Size	Stadi riduttore Gearbox stages	Rapporto in Ratio in	Versione Version	Tipo Type	Tensione Voltage	Opzioni Options	
PM	32	1 2 3	Vedere tabelle See tables	-	BL005.240 BL012.240 BL018.240 BL025.24E BL032.240 BL043.240 BL070.48E	24V 36V 48V	Encoder  ➔ AA19	
	42							
	52							
	62							
PK	32	1 2 3	Vedere tabelle See tables	BB				

### Simbologia

### Symbols

Ns	n° stadi / No. stages	Pn	[W]	Potenza nominale / Nominal power
in	rapporto nominale / nominal ratio	V	[V]	Tensione / Voltage
ir	rapporto reale / real ratio	I	[A]	Assorbimento / Current
M <sub>n</sub>	[Nm] coppia in uscita in funzionamento continuativo S1 output torque for continuous operation S1	IC		Classe di isolamento termico / Thermal insulation class
Rd	rendimento dinamico / efficiency	FF		Fattore di forma / Form factor
R <sub>2</sub>	[N] massimo carico radiale al centro dell'albero uscita max. radial load at output shaft centre	Mn	[Nm]	Coppia / Torque
A <sub>2</sub>	[N] massimo carico assiale / max. axial load	n <sub>1</sub>	[Rpm]	Giri / Speed
		IP		Grado di protezione / Enclosure protection
		Kg		Peso / Weight

### Lubrificazione

### Lubrication

I riduttori epicicloidali sono lubrificati in modo permanente, non richiedono quindi ulteriore manutenzione.

Questo gli consente di essere installati praticamente ovunque. Temperatura ambiente 0 ÷ 40 °C (in assenza di congelamento ed in assenza di condensa).

Per temperature diverse, contattare nostro UT.

Planetary gearboxes are life-time lubricated with grease, therefore they are maintenance free.

They can be installed in any location. Ambient temperature 0 ÷ 40 °C (in the absence of freezing and condensation).

For temperature outside this range please contact our technical dept.

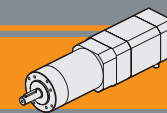

Carichi radiali

Radial loads

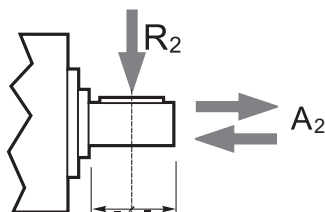

Ns	Carichi Radiali $R_2$ [N] / Radial Load $R_2$ [N]				
	PK32BB	PM32	PM42	PM52	PM62
1	40	40	160	200	240
2	70	70	230	320	360
3	100	100	300	450	520

Ns	Carichi Assiali $A_2$ [N] / Axial Load $A_2$ [N]				
	PK32BB	PM32	PM42	PM52	PM62
1	10	10	50	60	70
2	20	20	80	100	100
3	30	30	110	150	150

Rapporti

Ratios

PK32BB - PM32 - PM42 - PM52 - PM62		
Ns	in	ir
1	<b>4</b>	<b>3.7</b>
	4	4.28
	5	5.18
	<b>7</b>	<b>6.75</b>
2	<b>14</b>	<b>13.73</b>
	16	15.88
	18	18.36
	19	19.2
	22	22.2
	<b>25</b>	<b>25.01</b>
	27	26.85
	29	28.93
	35	34.97
3	<b>46</b>	<b>45.56</b>
	51	50.89
	59	58.85
	68	68.06
	71	71.16
	79	78.71
	<b>93</b>	<b>92.7</b>
	95	95.17
	100	99.5
	107	107.2
	115	115.07
	124	123.97
	130	129.62
	139	139.13
	150	149.9
	<b>169</b>	<b>168.84</b>
181	181.24	
195	195.26	
236	236.09	
<b>308</b>	<b>307.54</b>	

Rapporti preferenziali per PM42, PM52, PM62.  
Preferred ratios for PM42, PM52, PM62.

Disponibile a 4 stadi con rapporti fino a 2076  
Available 4 stages with ratio up to 2076

IP 20

PM

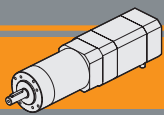

# Motoriduttori brushless CC epicicloidali

## Brushless DC planetary gearmotors

PK32BB - PM32 con motore brushless CC

PK32BB - PM32 with DC brushless motor

P..32			PK32BB + BL005						PM32 + BL005							
			24V						24V							
			n <sub>2</sub> MIN [ rpm ]			n <sub>2</sub> MAX [ rpm ]			n <sub>1</sub> MAX [ rpm ]	n <sub>2</sub> MIN [ rpm ]			n <sub>2</sub> MAX [ rpm ]			n <sub>1</sub> MAX [ rpm ]
Ns	ir	in	M <sub>2</sub> [ Nm ]	sf	M <sub>2</sub> [ Nm ]	sf	M <sub>2</sub> [ Nm ]	sf		M <sub>2</sub> [ Nm ]	sf					
1	3.70	4	100	0.1	4.3	1000	0.1	2.6	3700	100	0.1	7.5	1000	0.1	4.5	3700
	4.28	4	86	0.2	3.7	864	0.2	2.2		86	0.2	6.5	864	0.2	3.9	
	5.18	5	71	0.2	3.0	714	0.2	1.8		71	0.2	5.3	714	0.2	3.2	
	6.75	7	55	0.3	2.3	548	0.3	1.4		55	0.3	4.1	548	0.3	2.5	
2	13.73	14	27	0.5	3.1	269	0.5	1.8		27	0.5	6.4	269	0.5	3.9	
	15.88	16	23	0.6	2.7	233	0.6	1.6		23	0.6	5.6	233	0.6	3.3	
	18.36	18	20	0.6	2.3	202	0.6	1.4		20	0.7	4.8	202	0.7	2.9	
	19.20	19	19	0.7	2.2	193	0.7	1.3		19	0.7	4.6	193	0.7	2.8	
	22.20	22	17	0.8	1.9	167	0.8	1.1		17	0.8	4.0	167	0.8	2.4	
	25.01	25	15	0.9	1.7	148	0.9	1.0		15	0.9	3.5	148	0.9	2.1	
	26.85	27	14	0.9	1.6	138	0.9	0.9		14	1.0	3.3	138	1.0	2.0	
	28.93	29	13	1.0	1.5	128	1.0	0.9		13	1.1	3.1	128	1.1	1.8	
	34.97	35	11	1.2	1.2	106	1.2	0.7		11	1.3	2.5	106	1.3	1.5	
	45.56	46	8.1	1.6	0.9	81	1.2	0.7		8.1	1.7	1.9	81	1.7	1.2	
3	50.89	51	7.3	1.7	1.8	73	1.7	1.1		7.3	1.8	3.7	73	1.8	2.2	
	58.85	59	6.3	1.9	1.5	63	1.9	0.9		6.3	2.1	3.2	63	2.1	1.9	
	68.06	68	5.4	2.2	1.3	54	2.2	0.8		5.4	2.4	2.8	54	2.4	1.7	
	71.16	71	5.2	2.3	1.3	52	2.3	0.8		5.2	2.5	2.7	52	2.5	1.6	
	78.71	79	4.7	2.6	1.2	47	2.6	0.7		4.7	2.8	2.4	47	2.8	1.4	
	92.70	93	4.0	3.0	1.0	40	2.6	0.7		4.0	3.2	2.0	40	3.2	1.2	
	95.17	95	3.9	3.1	1.0	39	2.6	0.7		3.9	3.3	2.0	39	3.3	1.2	
	99.50	100	3.7	3.2	0.9	37	2.6	0.7		3.7	3.5	1.9	37	3.5	1.1	
	107.20	107	3.5	3.5	0.8	35	2.6	0.7		3.5	3.8	1.8	35	3.8	1.1	
	115.07	115	3.2	3.7	0.8	32	2.6	0.7		3.2	4.0	1.6	32	4.0	1.0	
	123.97	124	3.0	4.0	0.7	30	2.6	0.7		3.0	4.3	1.5	30	4.3	0.9	
	129.62	130	2.9	4.0	0.7	29	2.6	0.7		2.9	4.5	1.5	29	4.5	0.9	
	139.13	139	2.7	4.0	0.7	27	2.6	0.7		2.7	4.9	1.4	27	4.9	0.8	
	149.90	150	2.5	4.0	0.7	25	2.6	0.7		2.5	5.2	1.3	25	5.2	0.8	
	168.84	169	2.2	4.0	0.7	22	2.6	0.7	2.2	5.9	1.1	22	5.9	0.7		
	181.24	181	2.0	4.0	0.7	20	2.6	0.7	2.0	6.3	1.0	20	5.9	0.7		
	195.26	195	1.9	4.0	0.7	19	2.6	0.7	1.9	6.8	1.0	19	5.9	0.7		
	236.09	236	1.6	4.0	0.7	16	2.6	0.7	1.6	8.3	0.8	16	5.9	0.7		
307.54	308	1.2	4.0	0.7	12	2.6	0.7	1.2	9.0	0.7	12	5.9	0.7			

**Nota:** le caselle in colore grigio indicano il superamento della coppia massima sopportata dal riduttore per il servizio in S1.

*N.B.:* boxes in grey indicate that maximum torque withstood by gear reducer for service in S1 is exceeded.

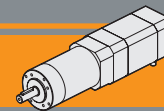

PK32BB - PM32 con motore brushless CC

PK32BB - PM32 with DC brushless motor

Tipo Type	Numero di poli Number of poles	Numero di fasi Number of phase	Tensione Rated voltage [ V ]	Numero di giri Rated speed [ rpm ]	Coppia nominale Rated torque [ mNm ]	Potenza nominale Rated power [ W ]
BL005	4	3	24	3700	50	16
Tipo Type	Coppia massima Peak torque [ Nm ]	Corrente nominale Rated current [ A ]	Resistenza Resistance [ ohm ]	Induttanza Inductance [ mH ]	Corrente massima Peak current [ A ]	Peso Weight [ kg ]
BL005	0.1	1.0	4.67	3.5	2.0	0.208

IP 20

PM

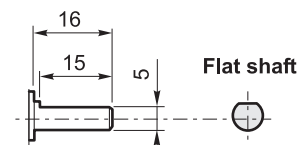
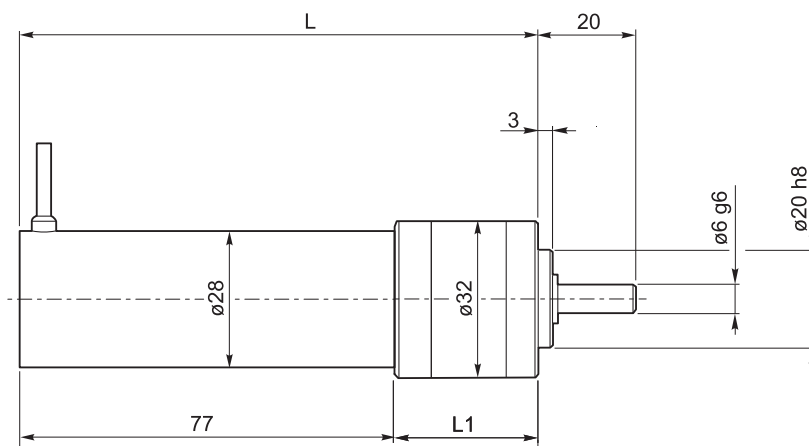
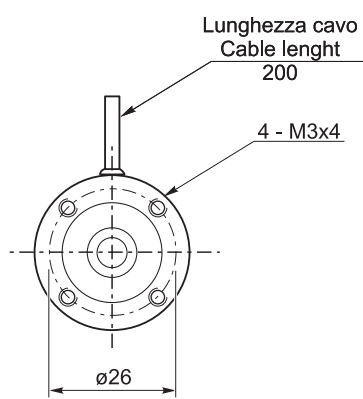

PK32BB PM32			BL005
	Ns	L1	L
	1	36.7	113.7
	2	46.2	123.2
3	55.7	132.7	

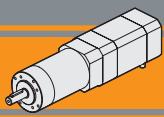

# Motoriduttori brushless CC epicicloidali

## Brushless DC planetary gearmotors

PM42 con motore brushless CC

PM42 with DC brushless motor

PM42			BL012.240						BL018.240							
			24V						24V							
Ns	ir	in	n <sub>2</sub> MIN [rpm]			n <sub>2</sub> MAX [rpm]			n <sub>1</sub> MAX [rpm]	n <sub>2</sub> MIN [rpm]			n <sub>2</sub> MAX [rpm]			n <sub>1</sub> MAX [rpm]
			M <sub>2</sub> [Nm]	sf		M <sub>2</sub> [Nm]	sf			M <sub>2</sub> [Nm]	sf		M <sub>2</sub> [Nm]	sf		
1	3.70	4	108	0.4	12.0	1081	0.4	7.2	4000	108	0.5	8.1	1081	0.5	4.8	4000
	4.28	4	93	0.4	10.3	935	0.4	6.2		93	0.6	7.0	935	0.6	4.2	
	5.18	5	77	0.5	8.5	772	0.5	5.1		77	0.8	5.8	772	0.8	3.5	
	6.75	7	59	0.7	6.6	593	0.7	3.9		59	1.0	4.4	593	1.0	2.7	
2	13.73	14	29	1.3	8.6	291	1.3	5.2	29	1.9	5.8	291	1.9	3.5		
	15.88	16	25	1.5	7.4	252	1.5	4.5	25	2.2	5.0	252	2.2	3.0		
	18.36	18	22	1.7	6.4	218	1.7	3.9	22	2.5	4.3	218	2.5	2.6		
	19.20	19	21	1.8	6.1	208	1.8	3.7	21	2.7	4.2	208	2.7	2.5		
	22.20	22	18	2.1	5.3	180	2.1	3.2	18	3.1	3.6	180	3.1	2.2		
	25.01	25	16	2.3	4.7	160	2.3	2.8	16	3.5	3.2	160	3.5	1.9		
	26.85	27	15	2.5	4.4	149	2.5	2.6	15	3.7	3.0	149	3.7	1.8		
	28.93	29	14	2.7	4.1	138	2.7	2.4	14	4.0	2.8	138	4.0	1.7		
	34.97	35	11.4	3.3	3.4	114	3.3	2.0	11.4	4.9	2.3	114	4.9	1.4		
	45.56	46	8.8	4.3	2.6	88	4.3	1.6	8.8	6.3	1.7	88	6.3	1.0		
3	50.89	51	7.9	4.5	5.0	79	4.5	3.0	7.9	6.6	3.4	79	6.6	2.0		
	58.85	59	6.8	5.1	4.3	68	5.1	2.6	6.8	7.6	2.9	68	7.6	1.7		
	68.06	68	5.9	6.0	3.7	59	6.0	2.2	5.9	8.8	2.5	59	8.8	1.5		
	71.16	71	5.6	6.2	3.6	56	6.2	2.1	5.6	9.2	2.4	56	9.2	1.4		
	78.71	79	5.1	6.9	3.2	51	6.9	1.9	5.1	10.2	2.2	51	10	1.3		
	92.70	93	4.3	8.1	2.7	43	8.1	1.6	4.3	12.0	1.8	43	12	1.1		
	95.17	95	4.2	8.3	2.7	42	8.3	1.6	4.2	12.3	1.8	42	12	1.1		
	99.50	100	4.0	8.7	2.5	40	8.7	1.5	4.0	12.9	1.7	40	13	1.0		
	107.20	107	3.7	9.4	2.4	37	9.4	1.4	3.7	13.9	1.6	37	14	1.0		
	115.07	115	3.5	10	2.2	35	10	1.3	3.5	15	1.5	35	15	0.9		
123.97	124	3.2	11	2.0	32	11	1.2	3.2	16	1.4	32	16	0.8			
129.62	130	3.1	11	1.9	31	11	1.2	3.1	17	1.3	31	17	0.8			
139.13	139	2.9	12	1.8	29	12	1.1	2.9	18	1.2	29	18	0.7			
149.90	150	2.7	13	1.7	27	13	1.0	2.7	19	1.1	27	18	0.7			
168.84	169	2.4	15	1.5	24	15	0.9	2.4	22	1.0	24	18	0.7			
181.24	181	2.2	16	1.4	22	16	0.8	2.2	23	0.9	22	18	0.7			
195.26	195	2.0	17	1.3	20	17	0.8	2.0	25	0.9	20	18	0.7			
236.09	236	1.7	21	1.1	17	18	0.7	1.7	31	0.7	17	18	0.7			
307.54	308	1.3	27	0.8	13.0	18	0.7	1.3	31	0.7	13.0	18	0.7			

**Nota:** le caselle in colore grigio indicano il superamento della coppia massima sopportata dal riduttore per il servizio in S1.

*N.B.: boxes in grey indicate that maximum torque withstood by gear reducer for service in S1 is exceeded.*

**Rapporti preferenziali**  
Preferred ratios



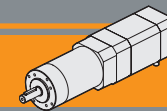

### PM42 con motore brushless CC

### PM42 with DC brushless motor

Tipo Type	Numero di poli Number of poles	Numero di fasi Number of phase	Tensione Rated voltage [ V ]	Numero di giri Rated speed [ rpm ]	Coppia nominale Rated torque [ Nm ]	Potenza nominale Rated power [ W ]
BL012.240	8	3	24	4000	0.125	52.5
BL018.240	8	3	24	4000	0.185	77.5
Tipo Type	Coppia massima Peak torque [ Nm ]	Corrente nominale Rated current [ A ]	Resistenza Resistance [ ohm ]	Induttanza Inductance [ mH ]	Corrente massima Peak current [ A ]	Peso Weight [ kg ]
BL012.240	0.25	3.5	0.8	1.2	7.0	0.45
BL018.240	0.37	5.0	0.55	0.8	10.0	0.65

Azionamenti  
Drives

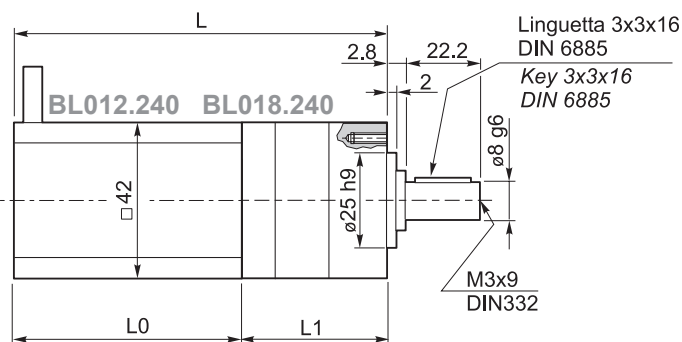
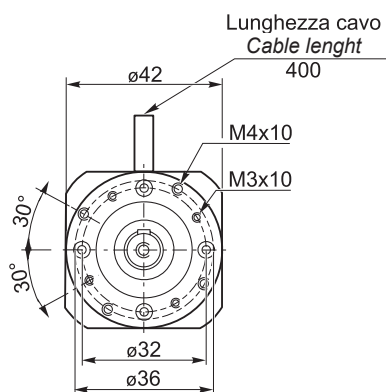

PM42	Ns	L1	BL012.240		BL018.240	
			L0	L	L0	L
	1	67	61	128	81	148
	2	80		141		161
	3	93		154		174

IP 20

PM

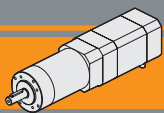

# Motoriduttori brushless CC epicicloidali

## Brushless DC planetary gearmotors

PM42 con motore brushless CC

PM42 with DC brushless motor

PM42			BL025.24E					$n_{1MAX}$ [rpm]
			24V					
Ns	ir	in	$n_{2MIN}$ [rpm]			$n_{2MAX}$ [rpm]		
				$M_2$ [Nm]	sf		$M_2$ [Nm]	sf
1	3.70	4	108	0.7	6.0	1081	0.7	3.6
	4.28	4	93	0.9	5.2	935	0.9	3.1
	5.18	5	77	1.0	4.3	772	1.0	2.6
	6.75	7	59	1.4	3.3	593	1.4	2.0
2	13.73	14	29	2.6	4.3	291	2.6	2.6
	15.88	16	25	3.0	3.7	252	3.0	2.2
	18.36	18	22	3.4	3.2	218	3.4	1.9
	19.20	19	21	3.6	3.1	208	3.6	1.8
	22.20	22	18	4.2	2.7	180	4.2	1.6
	25.01	25	16	4.7	2.4	160	4.7	1.4
	26.85	27	15	5.0	2.2	149	5.0	1.3
	28.93	29	14	5.4	2.0	138	5.4	1.2
	34.97	35	11	6.6	1.7	114	6.6	1.0
	45.56	46	8.8	8.5	1.3	88	8.5	0.8
3	50.89	51	7.9	8.9	2.5	79	8.9	1.5
	58.85	59	6.8	10	2.1	68	10	1.3
	68.06	68	5.9	12	1.9	59	12	1.1
	71.16	71	5.6	12	1.8	56	12	1.1
	78.71	79	5.1	14	1.6	51	14	1.0
	92.70	93	4.3	16	1.4	43	16	0.8
	95.17	95	4.2	17	1.3	42	17	0.8
	99.50	100	4.0	17	1.3	40	17	0.8
	107.20	107	3.7	19	1.2	37	19	0.7
	115.07	115	3.5	20	1.1	35	20	0.7
	123.97	124	3.2	22	1.0	32	20	0.7
	129.62	130	3.1	23	1.0	31	20	0.7
	139.13	139	2.9	24	0.9	29	20	0.7
	149.90	150	2.7	26	0.8	27	20	0.7
	168.84	169	2.4	30	0.7	24	20	0.7
	181.24	181	2.2	30	0.7	22	20	0.7
195.26	195	2.0	30	0.7	20	20	0.7	
236.09	236	1.7	30	0.7	17	20	0.7	
307.54	308	1.3	30	0.7	13	20	0.7	

4000

**Nota:** le caselle in colore grigio indicano il superamento della coppia massima sopportata dal riduttore per il servizio in S1.

*N.B.: boxes in grey indicate that maximum torque withstood by gear reducer for service in S1 is exceeded.*

**Rapporti preferenziali**  
*Preferred ratios*

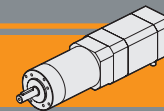

PM42 con motore brushless CC

PM42 with DC brushless motor

Tipo Type	Numero di poli Number of poles	Numero di fasi Number of phase	Tensione Rated voltage [ V ]	Numero di giri Rated speed [ rpm ]	Coppia nominale Rated torque [ Nm ]	Coppia massima Peak torque [ Nm ]
BL025.24E	8	3	24	4000	0.25	0.50
	Potenza nominale Rated power [ W ]	Corrente nominale Rated current [ A ]	Resistenza Resistance [ ohm ]	Induttanza Inductance [ mH ]	Corrente massima Peak current [ A ]	Peso Weight [ kg ]
	105	7	0.3	0.5	14	0.8

IP 20  
PM

Azionamenti Drives

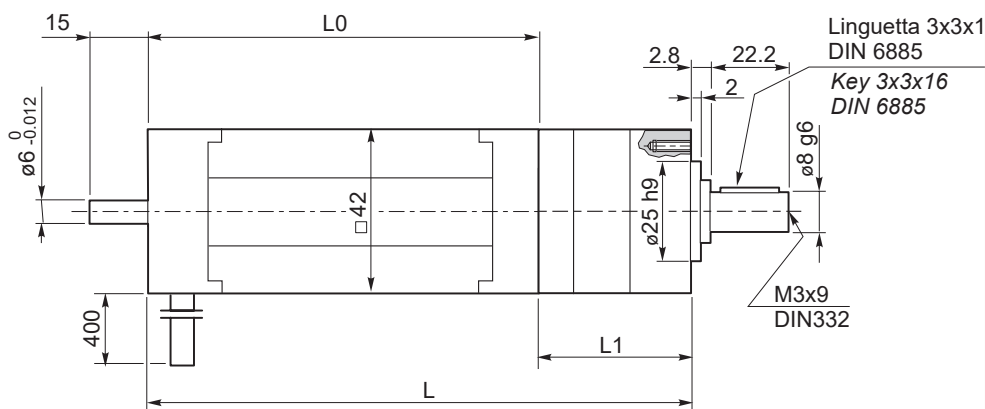
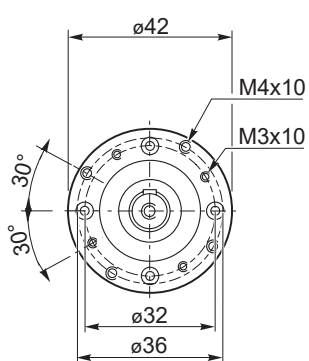

Encoder



PM42	Ns	L1	BL025.24E	
			L0	L
	1	67	101	168
	2	80	101	181
	3	93	101	194

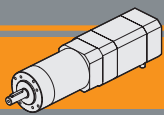

# Motoriduttori brushless CC epicicloidali

## Brushless DC planetary gearmotors

PM52 con motore brushless CC

PM52 with DC brushless motor

PM52			BL032.240						BL043.240					
			24V						24V					
			n <sub>2</sub> MIN [ rpm ]			n <sub>2</sub> MAX [ rpm ]			n <sub>1</sub> MAX [ rpm ]	n <sub>2</sub> MIN [ rpm ]			n <sub>2</sub> MAX [ rpm ]	
Ns	ir	in	M <sub>2</sub> [ Nm ]	sf	M <sub>2</sub> [ Nm ]	sf	M <sub>2</sub> [ Nm ]	sf		M <sub>2</sub> [ Nm ]	sf			
1	3.70	4	108	0.9	6.2	1081	0.9	4.2	108	1.3	4.6	1081	1.3	3.1
	4.28	4	93	1.1	5.4	935	1.1	3.7	93	1.5	4.0	935	1.5	2.7
	5.18	5	77	1.3	4.4	772	1.3	3.0	77	1.8	3.3	772	1.8	2.2
	6.75	7	59	1.7	3.4	593	1.7	2.3	59	2.3	2.5	593	2.3	1.7
2	13.73	14	29	3.3	5.4	291	3.3	3.6	29	4.4	4.0	291	4.4	2.7
	15.88	16	25	3.8	4.6	252	3.8	3.1	25	5.1	3.5	252	5.1	2.3
	18.36	18	22	4.4	4.0	218	4.4	2.7	22	5.9	3.0	218	5.9	2.0
	19.20	19	21	4.6	3.8	208	4.6	2.6	21	6.2	2.9	208	6.2	1.9
	22.20	22	18	5.3	3.3	180	5.3	2.3	18	7.2	2.5	180	7.2	1.7
	25.01	25	16	6.0	2.9	160	6.0	2.0	16	8.1	2.2	160	8.1	1.5
	26.85	27	15	6.4	2.7	149	6.4	1.9	15	8.7	2.0	149	8.7	1.4
	28.93	29	14	6.9	2.5	138	6.9	1.7	14	9.3	1.9	138	9.3	1.3
	34.97	35	11.4	8.4	2.1	114	8.4	1.4	11.4	11	1.6	114	11	1.1
	45.56	46	8.8	11	1.6	88	11	1.1	8.8	15	1.2	88	15	0.8
3	50.89	51	7.9	11	3.2	79	11	2.2	7.9	15	2.4	79	15	1.6
	58.85	59	6.8	13	2.8	68	13	1.9	6.8	18	2.1	68	18	1.4
	68.06	68	5.9	15	2.4	59	15	1.6	5.9	21	1.8	59	21	1.2
	71.16	71	5.6	16	2.3	56	16	1.6	5.6	21	1.7	56	21	1.2
	78.71	79	5.1	18	2.1	51	18	1.4	5.1	24	1.6	51	24	1.1
	92.70	93	4.3	21	1.8	43	21	1.2	4.3	28	1.3	43	28	0.9
	95.17	95	4.2	21	1.7	42	21	1.2	4.2	29	1.3	42	29	0.9
	99.50	100	4.0	22	1.7	40	22	1.1	4.0	30	1.2	40	30	0.8
	107.20	107	3.7	24	1.5	37	24	1.0	3.7	32	1.1	37	32	0.8
	115.07	115	3.5	26	1.4	35	26	1.0	3.5	35	1.1	35	35	0.7
123.97	124	3.2	28	1.3	32	28	0.9	3.2	37	1.0	32	35	0.7	
129.62	130	3.1	29	1.3	31	29	0.9	3.1	39	0.9	31	35	0.7	
139.13	139	2.9	31	1.2	29	31	0.8	2.9	42	0.9	29	35	0.7	
149.90	150	2.7	34	1.1	27	34	0.7	2.7	45	0.8	27	35	0.7	
168.84	169	2.4	38	1.0	24	34	0.7	2.4	51	0.7	24	35	0.7	
181.24	181	2.2	41	0.9	22	34	0.7	2.2	55	0.7	22	35	0.7	
195.26	195	2.0	44	0.8	20	34	0.7	2.0	55	0.7	20	35	0.7	
236.09	236	1.7	53	0.7	17	34	0.7	1.7	55	0.7	17	35	0.7	
307.54	308	1.3	53	0.7	13	34	0.7	1.3	55	0.7	13	35	0.7	

**Nota:** le caselle in colore grigio indicano il superamento della coppia massima sopportata dal riduttore per il servizio in S1.

*N.B.: boxes in grey indicate that maximum torque withstood by gear reducer for service in S1 is exceeded.*

**Rapporti preferenziali**  
Preferred ratios

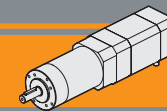

### PM52 con motore brushless CC

### PM52 with DC brushless motor

Tipo Type	Numero di poli Number of poles	Numero di fasi Number of phase	Tensione Rated voltage [ V ]	Numero di giri Rated speed [ rpm ]	Coppia nominale Rated torque [ Nm ]	Potenza nominale Rated power [ W ]
BL032.240	4	3	24	3000	0.32	100
BL043.240	4	3	24	3000	0.43	130
Tipo Type	Coppia massima Peak torque [ Nm ]	Corrente nominale Rated current [ A ]	Resistenza Resistance [ ohm ]	Induttanza Inductance [ mH ]	Corrente massima Peak current [ A ]	Peso Weight [ kg ]
BL032.240	0.64	5.0	0.45	1.4	10.0	1.0
BL043.240	0.86	6	0.35	1	12.0	1.25

IP 20

PM

Azionamenti Drives

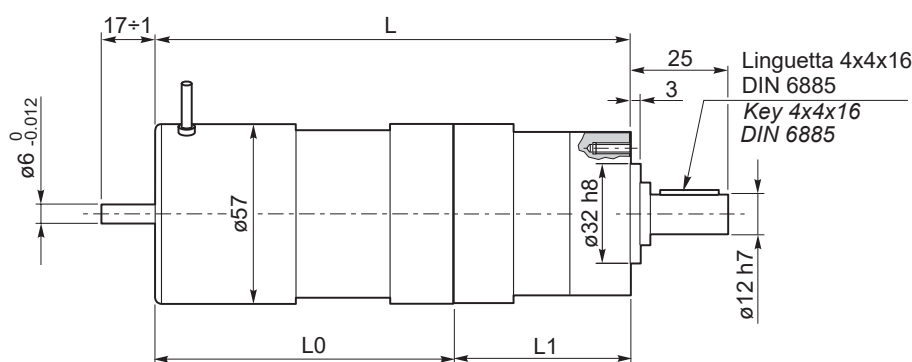
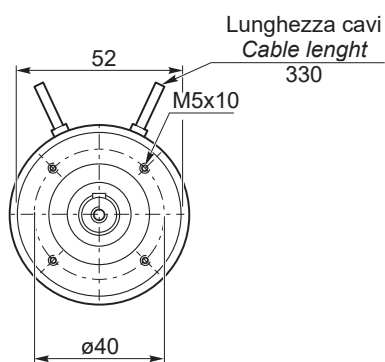

Encoder



Freno / Brake



PM52 C..

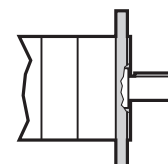

PM52	Ns	L1	BL032.240		BL043.240	
			L0	L	L0	L
	1	78	95	173	115	193
	2	92		187		207
	3	106		201		221

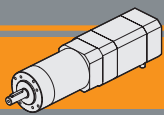

# Motoriduttori brushless CC epicicloidali

## Brushless DC planetary gearmotors

PM62 con motore brushless CC

PM62 with DC brushless motor

PM62			BL032.240						BL043.240							
			24V						24V							
			n <sub>2MIN</sub> [rpm]			n <sub>2MAX</sub> [rpm]			n <sub>1MAX</sub> [rpm]	n <sub>2MIN</sub> [rpm]			n <sub>2MAX</sub> [rpm]			n <sub>1MAX</sub> [rpm]
Ns	ir	in	M <sub>2</sub> [Nm]	sf	M <sub>2</sub> [Nm]	sf	M <sub>2</sub> [Nm]	sf		M <sub>2</sub> [Nm]	sf					
1	3.70	4	108	0.9	12.5	1081	0.9	8.4	3000	108	1.3	9.3	1081	1.3	6.3	3000
	4.28	4	93	1.1	10.8	935	1.1	7.3		93	1.5	8.0	935	1.5	5.4	
	5.18	5	77	1.3	8.9	772	1.3	6.0		77	1.8	6.6	772	1.8	4.5	
	6.75	7	59	1.7	6.8	593	1.7	4.6		59	2.3	5.1	593	2.3	3.4	
2	13.73	14	29	3.3	11.2	291	3.3	7.6	29	4.4	8.3	291	4.4	5.6		
	15.88	16	25	3.8	9.7	252	3.8	6.6	25	5.1	7.2	252	5.1	4.9		
	18.36	18	22	4.4	8.4	218	4.4	5.7	22	5.9	6.2	218	5.9	4.2		
	19.20	19	21	4.6	8.0	208	4.6	5.4	21	6.2	6.0	208	6.2	4.0		
	22.20	22	18	5.3	6.9	180	5.3	4.7	18	7.2	5.1	180	7.2	3.5		
	25.01	25	16	6.0	6.1	160	6.0	4.2	16	8.1	4.6	160	8.1	3.1		
	26.85	27	15	6.4	5.7	149	6.4	3.9	15	8.7	4.3	149	8.7	2.9		
	28.93	29	14	6.9	5.3	138	6.9	3.6	14	9.3	4.0	138	9.3	2.7		
	34.97	35	11.4	8.4	4.4	114	8.4	3.0	11.4	11	3.3	114	11	2.2		
	45.56	46	8.8	11	3.4	88	11	2.3	8.8	15	2.5	88	15	1.7		
3	50.89	51	7.9	11	6.5	79	11	4.4	7.9	15	4.8	79	15	3.3		
	58.85	59	6.8	13	5.6	68	13	3.8	6.8	18	4.2	68	18	2.8		
	68.06	68	5.9	15	4.8	59	15	3.3	5.9	21	3.6	59	21	2.4		
	71.16	71	5.6	16	4.6	56	16	3.1	5.6	21	3.4	56	21	2.3		
	78.71	79	5.1	18	4.2	51	18	2.8	5.1	24	3.1	51	24	2.1		
	92.70	93	4.3	21	3.6	43	21	2.4	4.3	28	2.6	43	28	1.8		
	95.17	95	4.2	21	3.5	42	21	2.3	4.2	29	2.6	42	29	1.7		
	99.50	100	4.0	22	3.3	40	22	2.2	4.0	30	2.5	40	30	1.7		
	107.20	107	3.7	24	3.1	37	24	2.1	3.7	32	2.3	37	32	1.5		
	115.07	115	3.5	26	2.9	35	26	1.9	3.5	35	2.1	35	35	1.4		
	123.97	124	3.2	28	2.7	32	28	1.8	3.2	37	2.0	32	37	1.3		
	129.62	130	3.1	29	2.5	31	29	1.7	3.1	39	1.9	31	39	1.3		
	139.13	139	2.9	31	2.4	29	31	1.6	2.9	42	1.8	29	42	1.2		
	149.90	150	2.7	34	2.2	27	34	1.5	2.7	45	1.6	27	45	1.1		
	168.84	169	2.4	38	1.9	24	38	1.3	2.4	51	1.5	24	51	1.0		
	181.24	181	2.2	41	1.8	22	41	1.2	2.2	55	1.4	22	55	0.9		
195.26	195	2.0	44	1.7	20	44	1.1	2.0	59	1.3	20	59	0.9			
236.09	236	1.7	53	1.4	17	53	0.9	1.7	71	1.0	17	71	0.7			
307.54	308	1.3	69	1.1	13.0	69	0.7	1.3	93	0.8	13.0	71	0.7			

**Nota:** le caselle in colore grigio indicano il superamento della coppia massima sopportata dal riduttore per il servizio in S1.

*N.B.: boxes in grey indicate that maximum torque withstood by gear reducer for service in S1 is exceeded.*

**Rapporti preferenziali**  
Preferred ratios

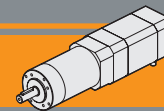

### PM62 con motore brushless CC

### PM62 with DC brushless motor

Tipo Type	Numero di poli Number of poles	Numero di fasi Number of phase	Tensione Rated voltage [ V ]	Numero di giri Rated speed [ rpm ]	Coppia nominale Rated torque [ Nm ]	Potenza nominale Rated power [ W ]
BL032.240	4	3	24	3000	0.32	100
BL043.240	4	3	24	3000	0.43	130
Tipo Type	Coppia massima Peak torque [ Nm ]	Corrente nominale Rated current [ A ]	Resistenza Resistance [ ohm ]	Induttanza Inductance [ mH ]	Corrente massima Peak current [ A ]	Peso Weight [ kg ]
BL032.240	0.64	5.0	0.45	1.4	10.0	1.0
BL043.240	0.86	6	0.35	1	12.0	1.25

IP 20

PM

Azionamenti  
Drives

II 2

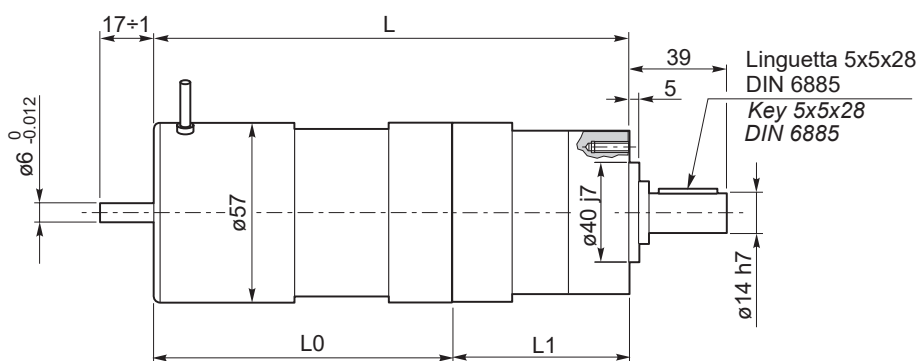
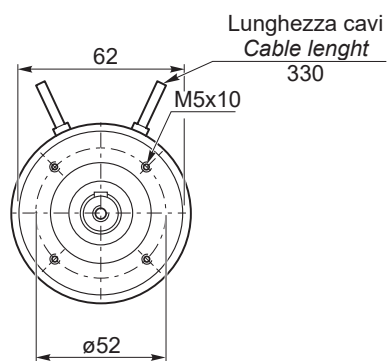

Encoder

AA19

Freno / Brake

AA18

PM62 C..

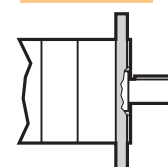

AC14

PM62	Ns	L1	BL032.240		BL043.240	
			L0	L	L0	L
	1	79		174		194
	2	95	95	190	115	210
	3	111		206		226

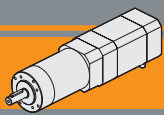

# Motoriduttori brushless CC epicicloidali

## Brushless DC planetary gearmotors

PM62 con motore brushless CC

PM62 with DC brushless motor

PM62			BL070.480						
			24V						
Ns	ir	in	n <sub>2</sub> MIN [rpm]			n <sub>2</sub> MAX [rpm]			n <sub>1</sub> MAX [rpm]
				M <sub>2</sub> [Nm]	sf		M <sub>2</sub> [Nm]	sf	
1	3.70	4	108	2.1	5.7	1081	2.1	3.9	3000
	4.28	4	93	2.4	4.9	935	2.4	3.3	
	5.18	5	77	2.9	4.1	772	2.9	2.8	
	6.75	7	59	3.8	3.1	593	3.8	2.1	
2	13.73	14	29	7.2	5.1	291	7.2	3.5	
	15.88	16	25	8.3	4.4	252	8.3	3.0	
	18.36	18	22	9.6	3.8	218	9.6	2.6	
	19.20	19	21	10	3.7	208	10	2.5	
	22.20	22	18	12	3.2	180	12	2.1	
	25.01	25	16	13	2.8	160	13	1.9	
	26.85	27	15	14	2.6	149	14	1.8	
	28.93	29	14	15	2.4	138	15	1.6	
	34.97	35	11.4	18	2.0	114	18	1.4	
	45.56	46	8.8	24	1.5	88	24	1.0	
3	50.89	51	7.9	25	3.0	79	25	2.0	
	58.85	59	6.8	29	2.6	68	29	1.7	
	68.06	68	5.9	33	2.2	59	33	1.5	
	71.16	71	5.6	35	2.1	56	35	1.4	
	78.71	79	5.1	39	1.9	51	39	1.3	
	92.70	93	4.3	45	1.6	43	45	1.1	
	95.17	95	4.2	47	1.6	42	47	1.1	
	99.50	100	4.0	49	1.5	40	49	1.0	
	107.20	107	3.7	53	1.4	37	53	1.0	
	115.07	115	3.5	56	1.3	35	56	0.9	
	123.97	124	3.2	61	1.2	32	61	0.8	
	129.62	130	3.1	64	1.2	31	64	0.8	
	139.13	139	2.9	68	1.1	29	68	0.7	
	149.90	150	2.7	73	1.0	27	68	0.7	
168.84	169	2.4	83	0.9	24	68	0.7		
181.24	181	2.2	89	0.8	22	68	0.7		
195.26	195	2.0	96	0.8	20	68	0.7		
236.09	236	1.7	105	0.7	17	68	0.7		
307.54	308	1.3	105	0.7	13.0	68	0.7		

**Nota:** le caselle in colore grigio indicano il superamento della coppia massima sopportata dal riduttore per il servizio in S1.

*N.B.: boxes in grey indicate that maximum torque withstood by gear reducer for service in S1 is exceeded.*

**Rapporti preferenziali**  
Preferred ratios



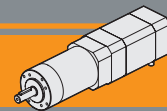

### PM62 con motore brushless CC

### PM62 with DC brushless motor

Tipo Type	Numero di poli Number of poles	Numero di fasi Number of phase	Tensione Rated voltage [ V ]	Numero di giri Rated speed [ rpm ]	Coppia nominale Rated torque [ Nm ]	Potenza nominale Rated power [ W ]
BL070.48E	8	3	48	3000	0.70	220
Tipo Type	Coppia massima Peak torque [ Nm ]	Corrente nominale Rated current [ A ]	Resistenza Resistance [ ohm ]	Induttanza Inductance [ mH ]	Corrente massima Peak current [ A ]	Peso Weight [ kg ]
BL070.48E	1.4	6.5	0.34	1.0	13	2.1

IP 20

PM

Azionamenti  
Drives

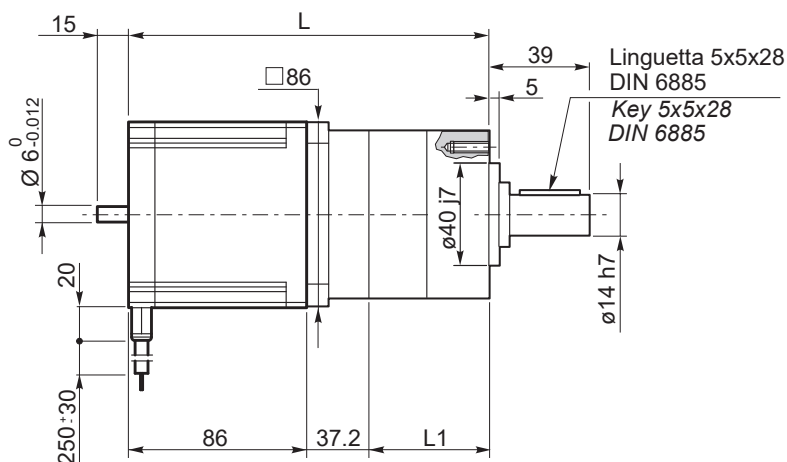
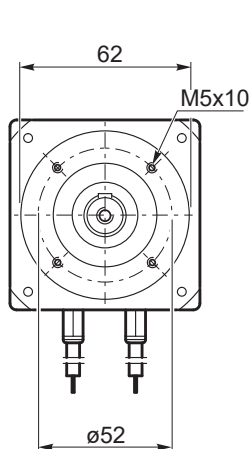

Encoder



Freno / Brake



PM62 C..

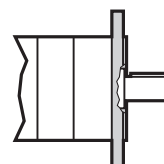

PM62	BL070.48E		
	Ns	L1	L
	1	45.3	168.5
	2	62.2	185.4
3	79.2	202.4	

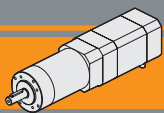

Dimensioni

Dimensions

PM.. C..

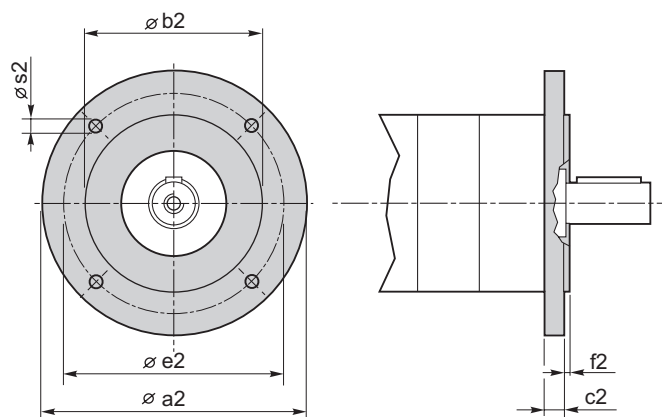

Flange uscita / Output flanges							
PM	a2	b2	c2	e2	f2	s2	Flangia Flange
52	80	50 j7	9	65	2.5	M5	<b>C80</b>
	90	60 j7	9	75	2.5	5.5	<b>C90</b>
	105	70 j7	9	85	2.5	6.5	<b>C105</b>
	120	80 j7	9	100	3.0	6.5	<b>C120</b>
62	80	50 j7	9	65	2.5	M5	<b>C80</b>
	90	60 j7	9	75	2.5	5.5	<b>C90</b>
	105	70 j7	9	85	2.5	6.5	<b>C105</b>
	120	80 j7	9	100	3.0	6.5	<b>C120</b>

 **TRANSTECNO SRL**  
**HEADQUARTERS**

Company subject to the management  
and coordination of INTERPUMP GROUP SPA  
Via Caduti di Sabbiano, 11/D-E  
40011 Anzola dell'Emilia (BO)  
ITALY  
T+39 051 64 25 811  
F +39 051 73 49 43  
sales@transtecno.com  
[www.transtecno.com](http://www.transtecno.com)

  
the modular gearmotor  
MEMBER OF INTERPUMP GROUP



 **HANGZHOU INTERPUMP  
POWER TRANSMISSIONS CO LTD**  
No.4 Xiuyan Road Fengdu Industry Zone  
Pingyao Town Yuhang District  
Hangzhou City, Zhejiang Province  
311115 – CHINA  
T +86 571 86 92 02 60  
info-china@transtecno.cn  
[www.transtecno.cn](http://www.transtecno.cn)

 **TRANSTECNO IBÉRICA  
THE MODULAR GEARMOTOR, S.A.**  
Carrer de la Ciència, 45  
08840 Viladecans (Barcelona) - SPAIN  
T +34 931 598 950  
info@transtecno.es  
[www.transtecno.es](http://www.transtecno.es)

 **TRANSTECNO B.V.**  
Siliciumweg 32  
3812 SX Amersfoort - NETHERLANDS  
T +31(0) 33 45 19 505  
info@transtecno.nl  
[www.transtecno.nl](http://www.transtecno.nl)

 **TRANSTECNO AANDRIJFTECHNIEK B.V.**  
Siliciumweg 32  
3812 SX Amersfoort - NETHERLANDS  
T +31 (0) 33 20 47 006  
info@transtecnoaandrijftechniek.nl  
[www.transtecnoaandrijftechniek.nl](http://www.transtecnoaandrijftechniek.nl)

 **MA TRANSTECNO S.A.P.I. DE C.V.**  
Julián Sepúlveda Dávila #107,  
Parque Industrial SG  
Apodaca, Nuevo León, CP. 66640  
MÉXICO  
T +52 8113340920  
info@transtecno.com.mx  
[www.transtecno.com.mx](http://www.transtecno.com.mx)

 **TRANSTECNO USA**  
8 Creek Parkway,  
Boothwyn PA 19061-8136 - UNITED STATES  
T + 1 (610) 4970154

**TRANSTECNO USA – WEST COAST BRANCH**  
14561 Fryelands Blvd SE  
Monroe, WA 98272 - UNITED STATES  
T +1 360-863-1300  
usaoffice@transtecno.com  
[www.transtecno.com](http://www.transtecno.com)

 **TRANSTECNO CANADA**  
51 B Caldari Road Unit 10  
Vaughan, ON L4K 4G3 - CANADA  
T +1 905 761 0762  
canadaoffice@transtecno.com  
[www.transtecno.com](http://www.transtecno.com)

 **TRANSTECNO INDIA**  
#6A, Sipcot Industrial complex, Phase-1, Elasagiri Road  
Hosur – 635126 Tamilnadu - INDIA  
T +91 4344 274434  
M +91 81443 88800

**TRANSTECNO INDIA – NORTH BRANCH**  
Plot No: 3 A, Sector 2, IIE, Sidcul, Pantnagar  
U.S. Nagar, Uttarakhand – 263153 - INDIA  
indiaoffice@transtecno.com  
[www.transtecno.com](http://www.transtecno.com)

 **TRANSTECNO BRAZIL**  
Rua Gilberto de Zorzi, 525 Forqueta - CEP. 95115-730  
CX Postal 3544 Caxias do Sul RS – BRAZIL

**TRANSTECNO BRAZIL – SÃO PAULO BRANCH**  
R. Mafalda Barnabe Soliane, 314 – CEP. 13347-610  
Indaiatuba, São Paulo - BRAZIL  
T +55 19 3437 2520

**TRANSTECNO BRAZIL – PORTO ALEGRE BRANCH**  
Rua Dr. Freire Alemão 155 / 402 - CEP. 90450-060  
Auxiliadora Porto Alegre RS - BRAZIL  
T +55 51 4042 0916  
M +55 51 811 45 962  
braziloffice@transtecno.com  
[www.transtecno.com.br](http://www.transtecno.com.br)

 **INTERPUMP ANTRIEBSTECHNIK GMBH**  
Büro Stuttgart - GERMANY  
T +49 (0)171 4781909  
germanoffice@transtecno.com  
[www.transtecno.com](http://www.transtecno.com)

 **SALES OFFICE OCEANIA**  
Unit 5, 12 Nyholt Drive, Yatala 4207  
Queensland - AUSTRALIA  
T +61 07 3800 0103  
M +61 04 38060997

UNIT 9, 94 Boundary Rd, Sunshine West 3020  
Victoria - AUSTRALIA  
T +61 9312 4722  
oceaniaoffice@transtecno.com  
[www.transtecno.com.au](http://www.transtecno.com.au)