

MINI  **TECNO**™
small but strong

CMB

AC

Motoriduttori CA ad assi ortogonali
AC Helical bevel gearmotors

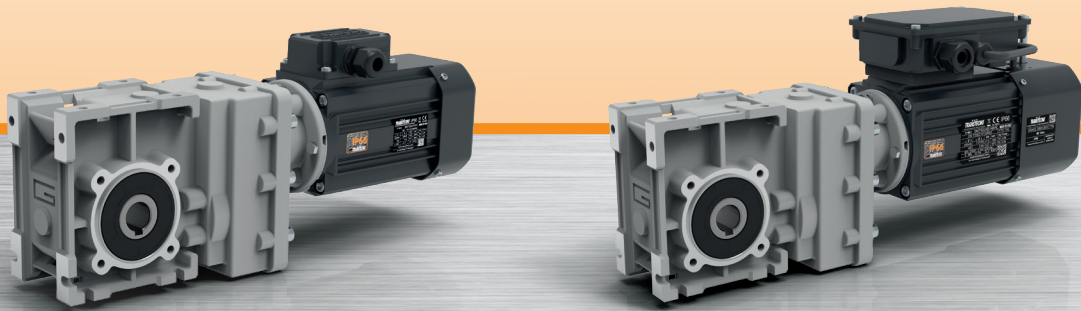

MINI  **TECNO**™ brand of
TRANSTECNO®



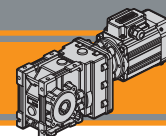

		Pag. Page
Indice	Index	
Caratteristiche tecniche	<i>Technical features</i>	AC2
Designazione	<i>Classification</i>	AC2
Sensi di rotazione	<i>Direction of rotation</i>	AC3
Simbologia	<i>Symbols</i>	AC3
Lubrificazione	<i>Lubrication</i>	AC3
Carichi radiali	<i>Radial loads</i>	AC3
Motori applicabili	<i>Motor adapters</i>	AC4
Dati tecnici	<i>Technical data</i>	AC4
Dimensioni	<i>Dimensions</i>	AC7
Accessori	<i>Accessories</i>	AC8

Questa sezione annulla e sostituisce ogni precedente edizione o revisione. Qualora questa sezione non Vi sia giunta in distribuzione controllata, l'aggiornamento dei dati ivi contenuto non è assicurato. **In tal caso la versione più aggiornata è disponibile sul nostro sito internet www.transtecno.com**

This section replaces any previous edition and revision. If you obtained this catalogue other than through controlled distribution channels, the most up to date content is not guaranteed. In this case the latest version is available on our web site www.transtecno.com

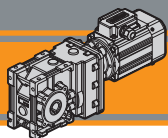

CMB

Motoriduttori CA ad assi ortogonali
AC Helical bevel gearmotors



Caratteristiche tecniche

Technical features

Le caratteristiche principali dei motoriduttori CMB sono:

CMB gearmotor range has the following main features:

- Costruzione compatta
- Motorizzazioni in corrente alternata monofase e trifase
- Carcassa motore estrusa in alluminio anodizzato nero
- Carcasse dei riduttori in pressofusione di alluminio
- Motore elettrico AC con grado di protezione IP66
- Lubrificazione permanente con olio sintetico
- Ingranaggi cilindrici a denti elicoidali, induriti e rettificati
- Disponibili sia nella versione ventilata TEFC (servizio S1) che non ventilata TENV (servizio S3)
- Protezione termica PTO 150°C per le taglie motore 56, 63 e 71.
- SMT56, SMT63 e SMT71 adatti al funzionamento con alimentazione da inverter
- Disponibili nelle versioni autofrenante, servoventilata e con certificazione UL.
- Disponibili con giunto elastico in entrata

- Compact design
- AC single phase and three phase motors available
- Motor extruded aluminum housing black anodized
- Gearbox die-cast aluminum housing
- AC electric motor in IP66 protection Standard
- Permanent synthetic oil long-life lubrication
- Ground-hardened helical gears
- Fan cooled TEFC (duty S1) and not ventilated TENV (duty S3) versions available
- PTO 150°C thermal protection for motor sizes 56, 63 and 71.
- SMT56, SMT63 and SMT71 are suitable for inverter duty
- Brake motors, forced ventilation motors and UL compliance versions available.
- Available with input flexible couplin

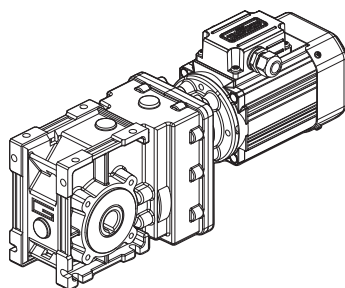

Designazione

Classification

RIDUTTORE / GEARBOX											
CMB	40 2		U	9.81	D20	63	B14	SZDX	BR SX	90	FX
Tipo Type	Grandezza Size	Stadi Stages	Versione Version	Rapporto Ratio	Albero cavo uscita Hollow output shaft	IEC	Forma costruttiva Version	Albero di uscita Output shaft	Braccio di reazione Torque arm	Angolo Angle	Giunto elastico Flexible coupling
	40	2	U FD FS FBD FBS FLD FLS	vedi tabelle see tables	vedi tabelle see tables	 56.. 63.. 71..	B14	SZDX SZSX DZ	BRDX BR SX *	0° 90° 180° 270°	FX 17
Versione Riduttore Gearbox Version			Albero di uscita Output shaft			Braccio di reazione Torque arm *		Angolo Angle			
 U FD FS FLD FBD FBS			 SZDX SZSX DZ			 BRDX BR SX		 90° 90° 180° 0° 270° 270°			

* NOTA: il braccio di reazione viene fornito smontato.
NOTE: the torque arm will be supplied not assembled.

MOTORE TRIFASE / THREE PHASE MOTOR										
SMT	63	2	4	0.18 kW	B14	230-400 V	50 Hz	TEFC	BR	T1
Tipo Type	Grandezza Size	Indicativo potenza Power coefficient	Poli Poles	Potenza Power	Forma costruttiva Version	Tensione Voltage	Frequenza Frequency	Ventilazione Fan cooling	Opzioni Options	Pos. Morsetteria Terminal box pos.
SMT	Vedere tab. See tab.	1-2-3-4-5	4	0.04 kW ... 0.75 kW	B14	230-400 V 460V	50Hz 60Hz	TEFC TENV	 AB1 AC1 AD1	 T1 (Std) T4 T2 T3

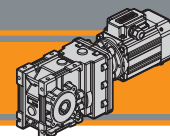

MOTORE MONOFASE / SINGLE PHASE MOTOR										
SMM	63	2	4	0.18 kW	B14	230 V	50 Hz	TEFC	UL-CSA	T1
Tipo Type	Grandezza Size	Indicativo potenza Power coefficient	Poli Poles	Potenza Power	Forma costruttiva Version	Tensione Voltage	Frequenza Frequency	Ventilazione Fan cooling	Opzioni Options	Pos. Morsetteria Terminal box pos.
SMM	Vedere tab. See tab.	1-2-3-4	4	0.04 kW ... 0.55 kW	B14	230V	50Hz	TEFC TENV	AD1	T1 (Std) T4 T2 T3

Sensi di rotazione

Direction of rotation

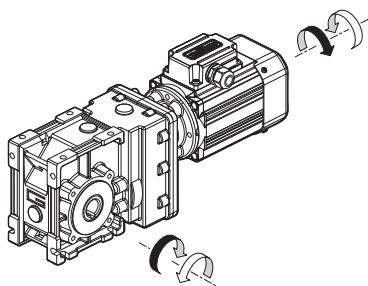

Simbologia

Symbols

n_1 [min ⁻¹]	Velocità in ingresso / <i>Input speed</i>	M_2 [Nm]	Coppia in uscita in funzione di P_1 / <i>Output torque referred to P_1</i>
n_2 [min ⁻¹]	Velocità in uscita / <i>Output speed</i>	sf	Fattore di servizio / <i>Service factor</i>
i	Rapporto di riduzione / <i>Ratio</i>	A_2 [N]	Carico assiale ammissibile in uscita / <i>Permitted output axial load</i>
P_1 [kW]	Potenza in entrata / <i>Input power</i>	R_2 [N]	Carico radiale ammissibile in uscita / <i>Permitted output radial load</i>

Lubrificazione

Lubrication

Tutti i riduttori nelle taglie 402 sono forniti completi di lubrificante sintetico viscosità 320, pertanto possono essere installati in qualunque posizione di montaggio e non necessitano di manutenzione.

Permanent synthetic oil long-life lubrication (viscosity grade 320) makes it possible to use sizes 402 in all mounting positions; for this reason they can be installed in any assembly position and do not require maintenance.

Carichi radiali

Radial loads

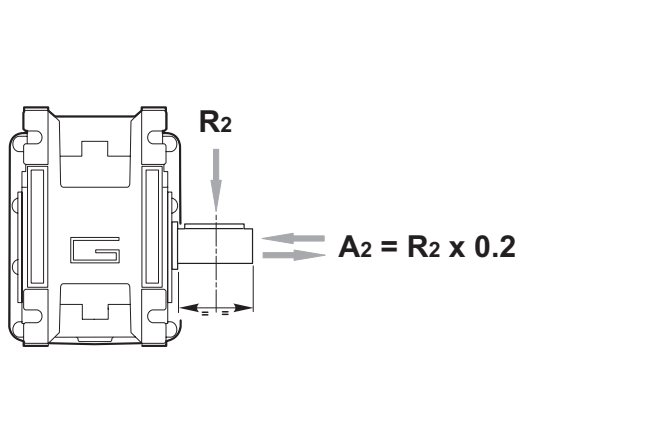

n_2 [min ⁻¹]	R_2 [N]
	CMB 402
400	905
300	996
200	1141
170	1204
140	1414
100	1582
90	1638
60	2047
40	2524
30	2778
20	3180
15	3500
10	3500

Quando il carico radiale risultante non è applicato sulla mezza-ria dell'albero occorre calcolare quello effettivo con la seguente formula:

When the resulting radial load is not applied on the centre line of the shaft it is necessary to calculate the effective load with the following formula:

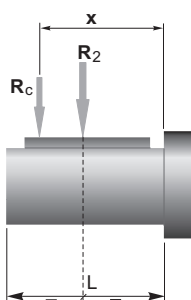

	CMB 402
a	86
b	66
R_{2MAX}	3500

$$R_c = \frac{R_2 \cdot a}{(b + x)} \leq R_{2MAX}$$

$$R \leq R_c$$

*a, b = valori riportati nella tabella
a, b = values given in the table*

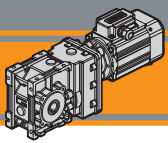

CMB

Motoriduttori CA ad assi ortogonali
AC Helical bevel gearmotors



Motori applicabili

Motor adapters

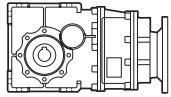
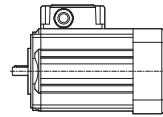

		SMT				SMM			
		5014 5024 5034 5044	5624 5634 5644 5654	6324 6334 6344	7124 7134 7144	5014 5024 5034	5624 5634 5644	6324 6334	7124 7134
CMB	402	6.18 - 72.50							

6.18 - 72.50

Rapporti di riduzione i
Ratio i

Dati tecnici

Technical data

P ₁ [kW]	n ₂ [min ⁻¹]	M ₂ [Nm]	sf	i		P ₁ [kW]	n ₂ [min ⁻¹]	M ₂ [Nm]	sf	i	
0.04						0.06					
SMT5014	227	2	25.3	6.18	CMB402	SMT5024	42	13	5.0	33.57	CMB402
SMM5014	187	2	20.8	7.49		SMM5024	39	14	4.7	35.63	
(1400 min ⁻¹)	152	2	16.9	9.20		(1400 min ⁻¹)	33	16	4.0	42.75	
	118	3	14.8	11.83			25	21	3.1	55.31	
	112	3	14.1	12.48			24	23	2.9	59.06	
	94	4	11.8	14.83			22	25	2.6	64.29	
	79	5	10.0	17.63			19	28	2.3	72.50	
	75	5	11.5	18.60							
	63	6	9.6	22.33							
	59	6	9.0	23.91							
	48	7	8.8	28.89							
	45	8	8.2	30.84							
	42	9	7.5	33.57							
	39	9	7.1	35.63							
	33	11	5.9	42.75							
	25	14	4.6	55.31							
	24	15	4.3	59.06							
	22	16	3.9	64.29							
	19	19	3.5	72.50							
0.06						0.09					
SMT5024	227	2	16.8	6.18	CMB402	SMT5034	227	4	11.2	6.18	CMB402
SMM5024	187	3	13.9	7.49		SMM5034	187	4	9.3	7.49	
(1400 min ⁻¹)	152	4	11.3	9.20		(1400 min ⁻¹)	152	5	7.5	9.20	
	118	5	9.9	11.83			118	7	6.6	11.83	
	112	5	9.4	12.48			112	7	6.2	12.48	
	94	6	7.9	14.83			94	9	5.3	14.83	
	79	7	6.6	17.63			79	10	4.4	17.63	
	75	7	7.7	18.60			75	11	5.1	18.60	
	63	9	6.4	22.33			63	13	4.3	22.33	
	59	9	6.0	23.91			59	14	4.0	23.91	
	48	11	5.8	28.89			48	17	3.9	28.89	
	45	12	5.5	30.84			45	18	3.7	30.84	
							42	19	3.4	33.57	
							39	21	3.2	35.63	
							33	25	2.6	42.75	
							25	32	2.0	55.31	
						24	34	1.9	59.06		
						22	37	1.8	64.29		
						19	42	1.6	72.50		



Motori Motors	SMT		SMM	
		5014 5024 5034	5624	5014 5024 5034
IEC	56 B14		56 B14	

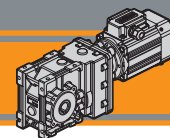

Dati tecnici

Technical data

P ₁ [kW]	n ₂ [min ⁻¹]	M ₂ [Nm]	sf	i	
0.12					
SMT5044	227	5	8.4	6.18	CMB402
SMT5634	187	6	6.9	7.49	
SMM5634	152	7	5.6	9.20	
(1400 min ⁻¹)	118	9	4.9	11.83	
	112	10	4.7	12.48	
	94	11	3.9	14.83	
	79	14	3.3	17.63	
	75	14	3.8	18.60	
	63	17	3.2	22.33	
	59	18	3.0	23.91	
	48	22	2.9	28.89	
	45	24	2.7	30.84	
	42	26	2.5	33.57	
	39	27	2.4	35.63	
	33	33	2.0	42.75	
	25	43	1.5	55.31	
	24	45	1.4	59.06	
	22	49	1.3	64.29	
	19	56	1.2	72.50	

P ₁ [kW]	n ₂ [min ⁻¹]	M ₂ [Nm]	sf	i	
0.18					
SMT5644	227	7	5.6	6.18	CMB402
SMM5644	187	9	4.6	7.49	
SMT6324	152	11	3.8	9.20	
SMM6324	118	14	3.3	11.83	
(1400 min ⁻¹)	112	14	3.1	12.48	
	94	17	2.6	14.83	
	79	20	2.2	17.63	
	75	21	2.6	18.60	
	63	26	2.1	22.33	
	59	28	2.0	23.91	
	48	33	1.9	28.89	
	45	36	1.8	30.84	
	42	39	1.7	33.57	
	39	41	1.6	35.63	
	33	49	1.3	42.75	
	25	64	1.0	55.31	
	24	68	0.95	59.06	
	22	74	0.88	64.29	
	19	84	0.8	72.50	

P ₁ [kW]	n ₂ [min ⁻¹]	M ₂ [Nm]	sf	i	
0.25					
SMT5654	227	10	4.0	6.18	CMB402
SMT6334	187	12	3.3	7.49	
SMM6334	152	15	2.7	9.20	
(1400 min ⁻¹)	118	19	2.4	11.83	
	112	20	2.2	12.48	
	94	24	1.9	14.83	
	79	28	1.6	17.63	
	75	30	1.8	18.60	
	63	36	1.5	22.33	
	59	38	1.4	23.91	
	48	46	1.4	28.89	
	45	49	1.3	30.84	
	42	54	1.2	33.57	
	39	57	1.1	35.63	
	33	69	0.9	42.75	

P ₁ [kW]	n ₂ [min ⁻¹]	M ₂ [Nm]	sf	i	
0.37					
SMT6344	227	15	2.7	6.18	CMB402
SMT7124	187	18	2.3	7.49	
SMM7124	152	22	1.8	9.20	
(1400 min ⁻¹)	118	28	1.6	11.83	
	112	30	1.5	12.48	
	94	35	1.3	14.83	
	79	42	1.1	17.63	
	75	44	1.2	18.60	
	63	53	1.0	22.33	
	59	57	1.0	23.91	
	48	69	0.9	28.89	
	45	73	0.9	30.84	
	42	80	0.8	33.57	

P ₁ [kW]	n ₂ [min ⁻¹]	M ₂ [Nm]	sf	i	
0.55					
SMT7134	227	22	1.8	6.18	CMB402
SMM7134	187	26	1.5	7.49	
(1400 min ⁻¹)	152	32	1.2	9.20	
	118	42	1.1	11.83	
	112	44	1.0	12.48	
	94	52	0.9	14.83	

P ₁ [kW]	n ₂ [min ⁻¹]	M ₂ [Nm]	sf	i	
0.75					
SMT7144	227	30	1.3	6.18	CMB402
(1400 min ⁻¹)	187	36	1.1	7.49	
	152	44	0.9	9.20	



Motori Motors	SMT				SMM		
	5044	5634 5644 5654	6324 6334 6344	7124 7134 7144	5644	6324 6334	7124 7134
IEC	56 B14		63 B14	71 B14	56 B14	63 B14	71 B14

Dati tecnici elettrici

Electrical technical data



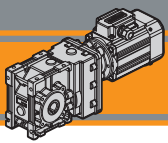

CMB

Motoriduttori CA ad assi ortogonali
AC Helical bevel gearmotors

MINI
TECNO

Dimensioni

Dimensions

CMB 402 U

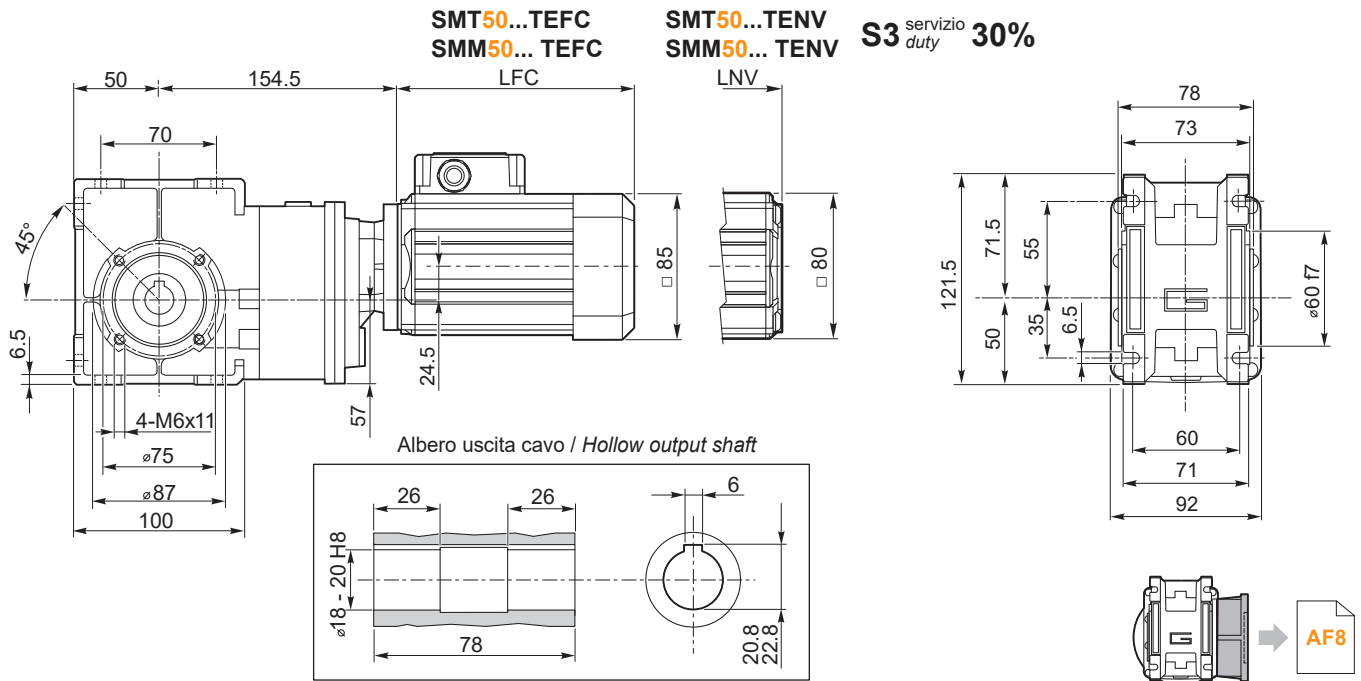

SMT	LFC	LNV	Kg	
5014	135.5	108.5	5.7	
5024	150.5	123.5	6.1	
5034	175.5	148.5	6.9	
5044	200.5	173.5	7.6	

SMM	LFC	LNV	Kg	
5014	150.5	123.5	6.1	
5024	175.5	148.5	6.9	
5034	200.5	173.5	7.6	

Nota:
il condensatore sarà fornito a corredo

Note:
the capacitor will be supplied separately

CMB 402 U

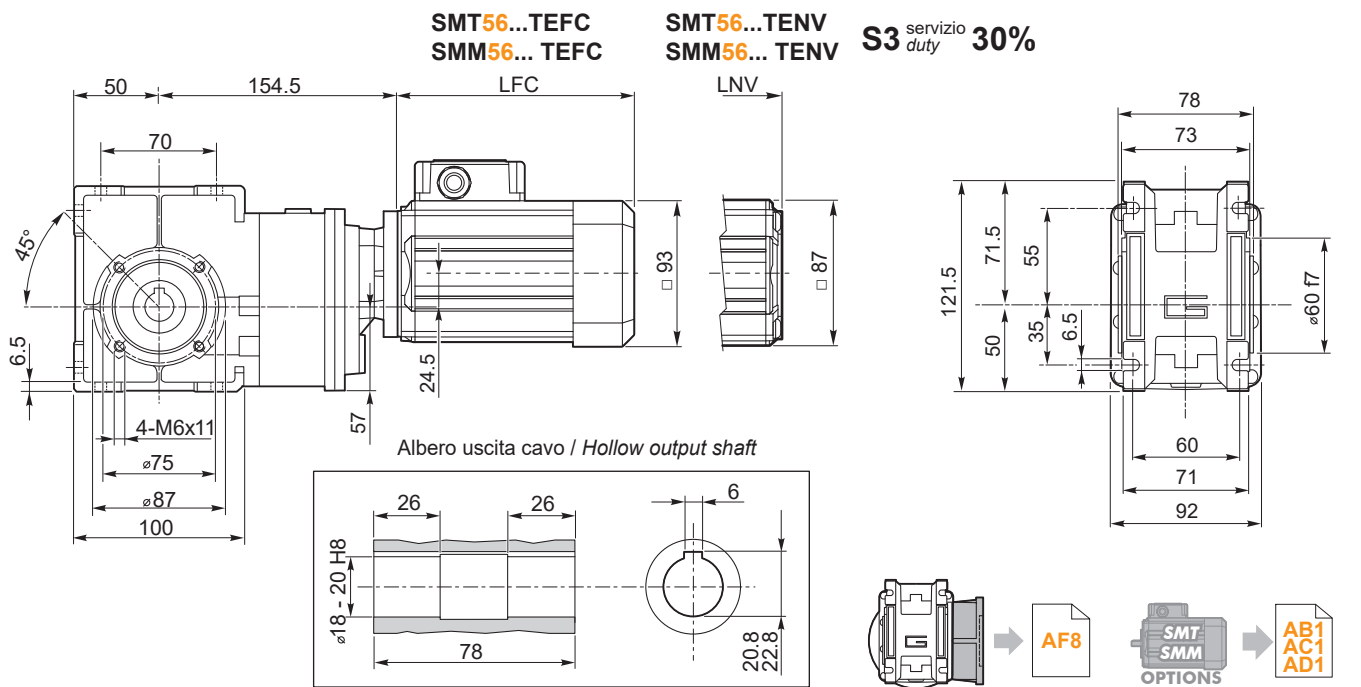

SMT	LFC	LNV	Kg	
5624	141	117	6.2	
5634	151	127	6.6	
5644	186	162	7.8	
5654	206	182	8.5	

SMM	LFC	LNV	Kg	
5624	151	127	6.5	
5634	171	147	7.1	
5644	206	182	8.4	

Nota:
il condensatore sarà fornito a corredo

Note:
the capacitor will be supplied separately

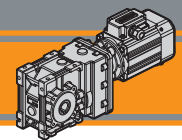

Dimensioni

Dimensions

CMB 402 U

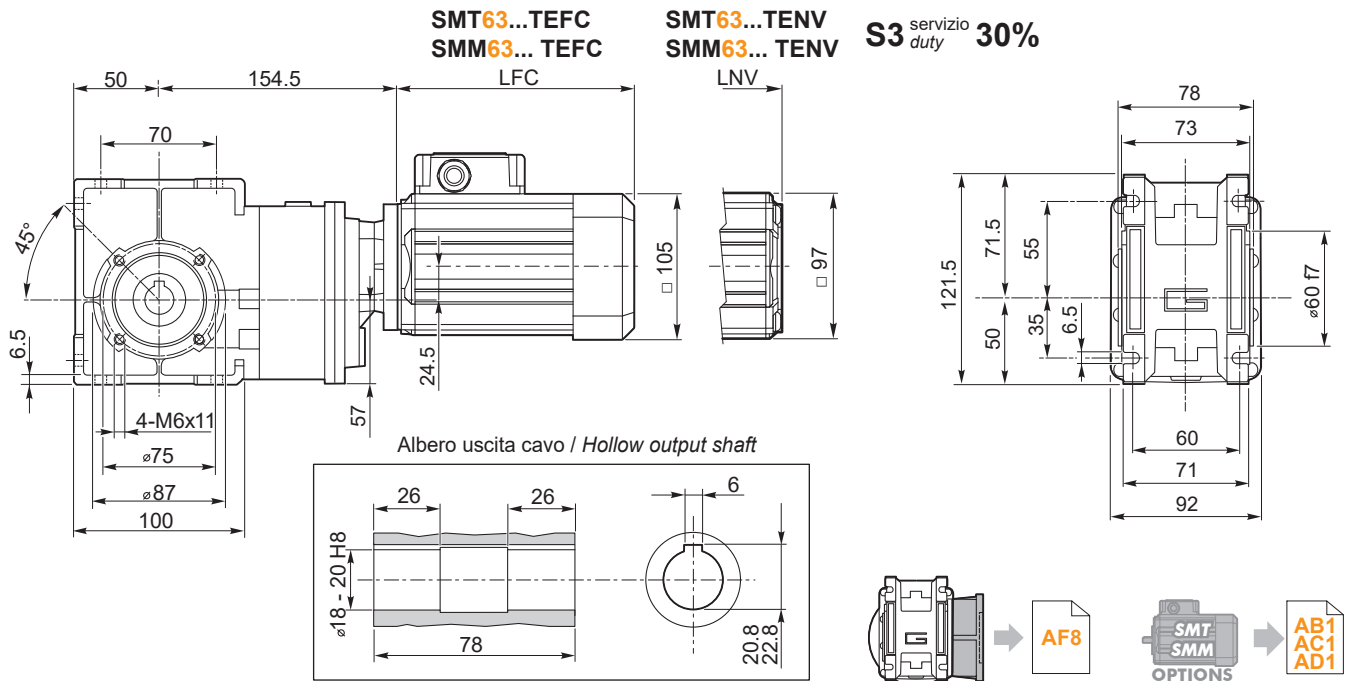

SMT	LFC	LNV	Kg	
6324	165.5	138.5	7.7	
6334	180.5	153.5	8.4	
6344	205.5	178.5	9.6	

SMM	LFC	LNV	Kg	
6324	180.5	153.5	8.5	
6334	205.5	178.5	9.7	

Nota:
il condensatore sarà fornito a corredo

Note:
the capacitor will be supplied separately

CMB 402 U

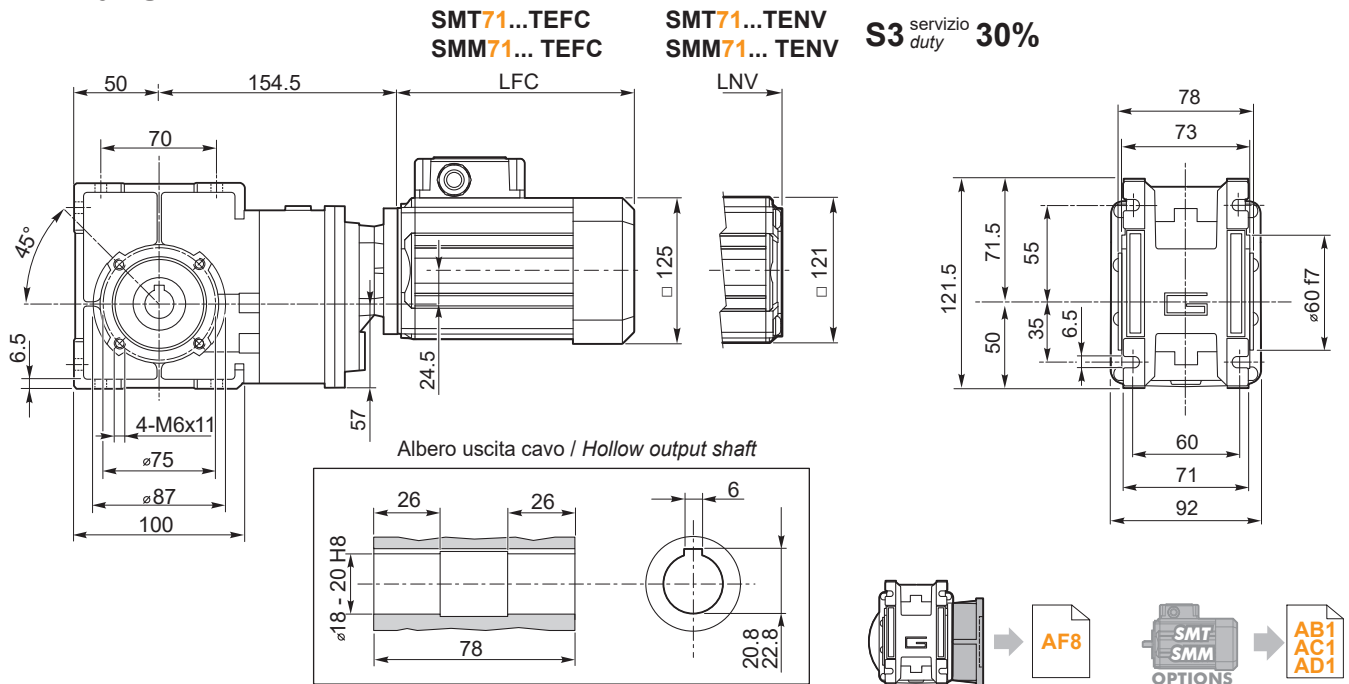

SMT	LFC	LNV	Kg	
7124	174	145.5	9.9	
7134	189	160.5	11	
7144	214	185.5	12.7	

SMM	LFC	LNV	Kg	
7124	189	160.5	10.6	
7134	214	185.5	12.6	

Nota:
il condensatore sarà fornito a corredo

Note:
the capacitor will be supplied separately

AC

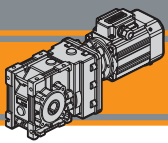

CMB

Motoriduttori CA ad assi ortogonali
AC Helical bevel gearmotors

MINI
TECNO

CMB402/ F... Flange uscita / Output flanges

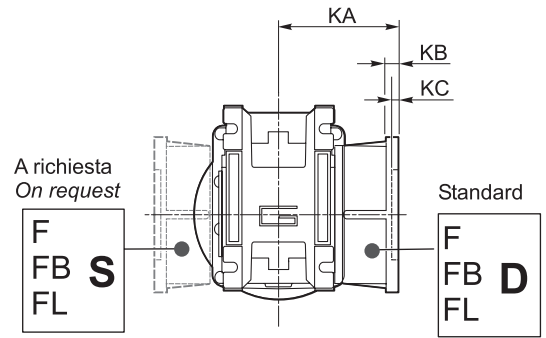
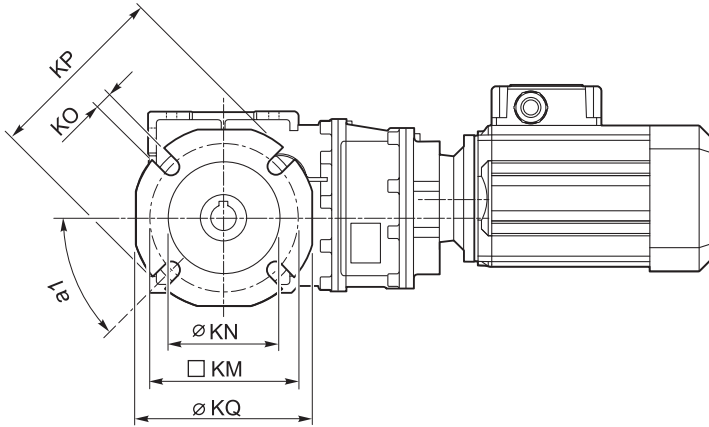

CMB	Flange uscita / Output flanges																										
	F									FL					FB												
	a ₁	KA	KB	KC	KM	KN H8	KO	KP	KQ	a ₁	KA	KB	KC	KM	KN H8	KO	KP	KQ	a ₁	KA	KB	KC	KM	KN H8	KO	KP	KQ
402	45°	67	7.5	4.5	80-95	60	9	110	95	45°	97	7.5	4.5	80-95	60	9	110	95	45°	80	8.5	5	115-125	95	9.5	140	112

Accessori

Accessories

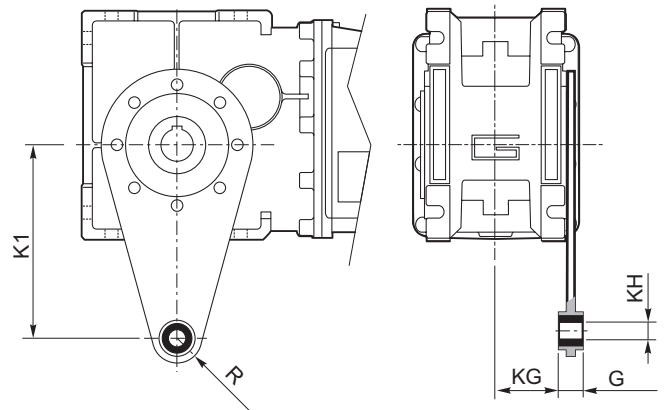
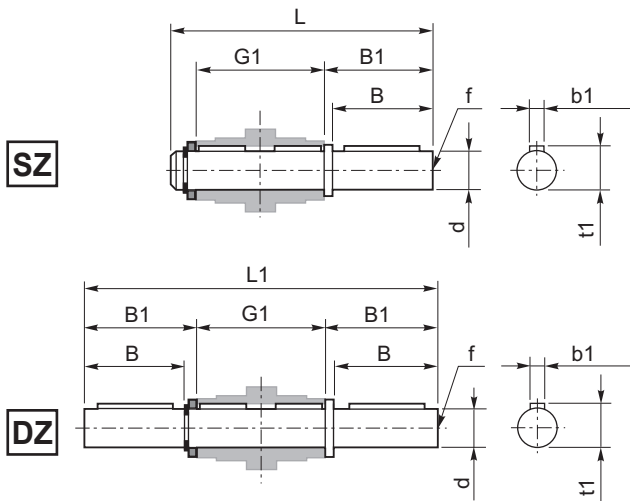

Albero lento / Output shaft

Braccio di reazione / Torque arm

CMB	d h7	B	B1	G1	L	L1	f	b1	t1
402	18	40	43	78	128	164	M6	6	20.5

CMB	K1	G	KG	KH	R
402	100	14	31	10	18

SC - Safety cover

WD - Kit washdown cover

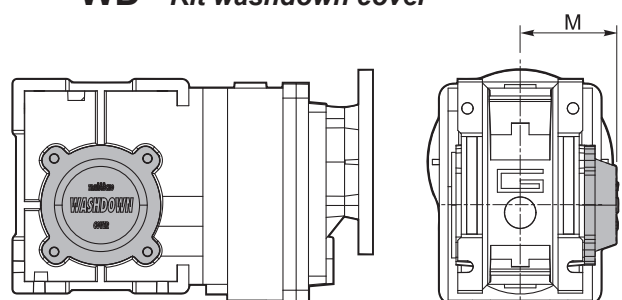
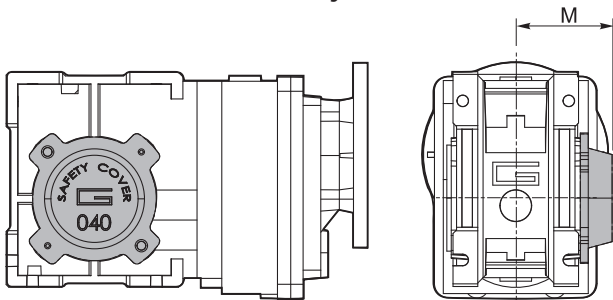

CMB	M
402	54.5

CMB	M
402	55.5

 **TRANSTECNO SRL
HEADQUARTERS**

Company subject to the management
and coordination of INTERPUMP GROUP SPA
Via Caduti di Sabbiano, 11/D-E
40011 Anzola dell'Emilia (BO)
ITALY
T+39 051 64 25 811
F +39 051 73 49 43
sales@transtecno.com
www.transtecno.com

 **TRANSTECNO®**
the modular gearmotor

MEMBER OF INTERPUMP GROUP



 **HANGZHOU TRANSTECNO POWER
TRANSMISSIONS CO LTD**
No.4 Xiuyan Road Fengdu Industry Zone
Pingyao Town Yuhang District
Hangzhou City, Zhejiang Province
311115 - CHINA
T +86 571 86 92 02 60
F +86 571 86 92 18 10
info-china@transtecno.cn
www.transtecno.cn

 **MA TRANSTECNO S.A.P.I. DE C.V.**
Av. Mundial # 176, Parque Industrial
JM Apodaca, Nuevo León,
C.P. 66600 - MEXICO
T +52 8113340920
info@transtecno.com.mx
www.transtecno.com.mx

 **TRANSTECNO IBÉRICA
THE MODULAR GEARMOTOR, S.A.**
Carrer de la Ciència, 45
08840 Viladecans (Barcelona) - SPAIN
T +34 931 598 950
info@transtecno.es
www.transtecno.es

 **TRANSTECNO B.V.**
Siliciumweg 32
3812 SX Amersfoort - NETHERLANDS
T +31(0) 33 45 19 505
F +31(0) 33 45 19 506
info@transtecno.nl
www.transtecno.nl

 **TRANSTECNO AANDRIJFTECHNIEK B.V.**
Siliciumweg 32
3812 SX Amersfoort - NETHERLANDS
T +31 (0) 33 20 4 7 006
info@transtecnoaandrijftechnik.nl
www.transtecnoaandrijftechnik.nl

 **TRANSTECNO USA**
8 Creek Parkway,
Boothwyn PA 19061-8136 - UNITED STATES
T +1 (610) 4970154
F +1 (610) 497 6085

TRANSTECNO USA – WEST COAST BRANCH
14561 Fryelands Blvd SE
Monroe, WA 98272 - UNITED STATES
T +1 360-863-1300
F +1 360-863-1303
usaoffice@transtecno.com
www.transtecno.com

 **TRANSTECNO CANADA**
51 B Caldari Road Unit 10
Vaughan, ON L4K 4G3 - CANADA
T +1 905 761 0762
F +1 905 761 9265
canadaoffice@transtecno.com
www.transtecno.com

 **TRANSTECNO CHILE-PERU**
Av. Los Libertadores 41
Parque Industrial - Los Libertadores 16.500
Santiago, Colina - CHILE
T +56 2 29633870

Carretera Panamericana Sur KM 29.5,
Interior I-3, Z.I. Lurin - PERU
T +51 1 3546259 / + 51 1 3434231
chileoffice@transtecno.com
www.transtecno.com

 **TRANSTECNO INDIA**
#6A, Sipcot Industrial complex, Phase-1, Elasagiri Road
Hosur - 635126 Tamilnadu - INDIA
T +91 4344 274434
M +91 81443 88800

TRANSTECNO INDIA – NORTH BRANCH
Plot No: 3 A, Sector 2, IIE, Sidcul, Pantnagar
U.S. Nagar, Uttarakhand - 263153 - INDIA
indiaoffice@transtecno.com
www.transtecno.com

 **SALES OFFICE BRAZIL**
Rua Dr. Freire Alemão 155 / 402 - CEP. 90450-060
Auxiliadora Porto Alegre RS - BRAZIL
T +55 51 3251 5447
F +55 51 3251 5447
M +55 51 8111 45 962
braziloffice@transtecno.com
www.transtecno.com.br

 **SALES OFFICE OCEANIA**
Unit 5, 12 Nyholt Drive, Yatala 4207
Queensland - AUSTRALIA
T +61 07 3800 0103
M +61 04 38060997
oceaniaoffice@transtecno.com
www.transtecno.com.au

 **SALES OFFICE SOUTH KOREA**
772-41, Bongdong-ro, Bongdong-eup, Wanju-goon
Chonbuk, 55313
SOUTH KOREA
T +82 70 8867 8897
F +82 504 199 2107
M +82 10 5094 2107
koreaoffice@transtecno.com
www.transtecno.com

www.minitecno.com
www.transtecno.com