

TRANSTECNO[®]
the modular gearmotor

ATS

ATS



平行轴式减速机
Helical parallel gearmotors

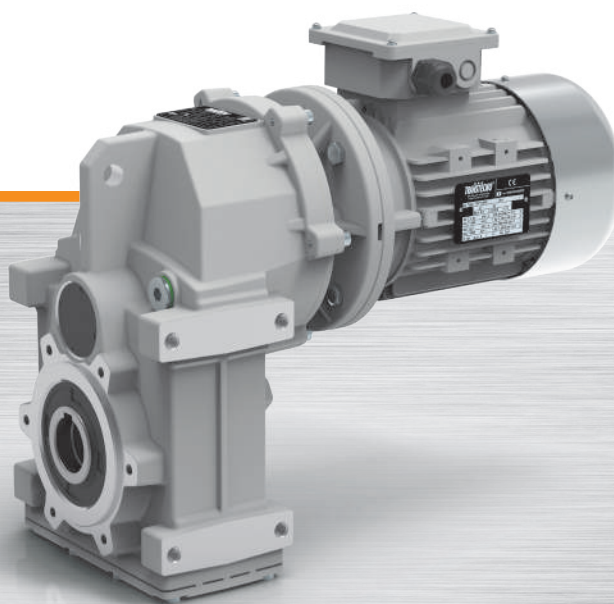

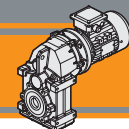

索引

技术特征
选型
运转方向
代号说明
润滑油
径向负荷
电机适配表
技术参数
尺寸参数
附件

Index

Technical features
Classification
Direction of rotation
Symbols
Lubrication
Radial loads
Motors adapters
Technical data
Dimensions
Accessories

页码
Page

E2
E2
E4
E4
E4
E4
E5
E5
E6
E12
E16

ATS

该目录为最新版本，可替代以往的任何版本及修订。如果您是通过非正式渠道取得，不能保证是最新内容，可在本公司网站上查阅 www.transtecno.com

This section replaces any previous edition and revision. If you obtained this catalogue other than through controlled distribution channels, the most up to date content is not guaranteed. In this case the latest version is available on our web site www.transtecno.com

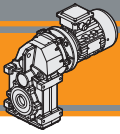

ATS 平行轴式减速机 Helical parallel gearmotors

技术特征

Technical features

ATS平行轴式减速机具有高度模块化的设计特点，可以与输入、输出组件任意组合。

The high degree of modularity is a design feature of ATS helical parallel range. It is possible to set up the version required by using input and output kits.

ATS系列的主要特征：

The main features of ATS range are:

- 压铸铝合金箱体和输入法兰；
- 使用长寿命人工合成润滑油；
- 磨削硬齿面斜齿轮；
- 铸铁输出法兰。

- Die-cast aluminium housings and input flanges
- Permanent synthetic oil long-life lubrication.
- Ground-hardened helical gears.
- Cast iron output flanges.

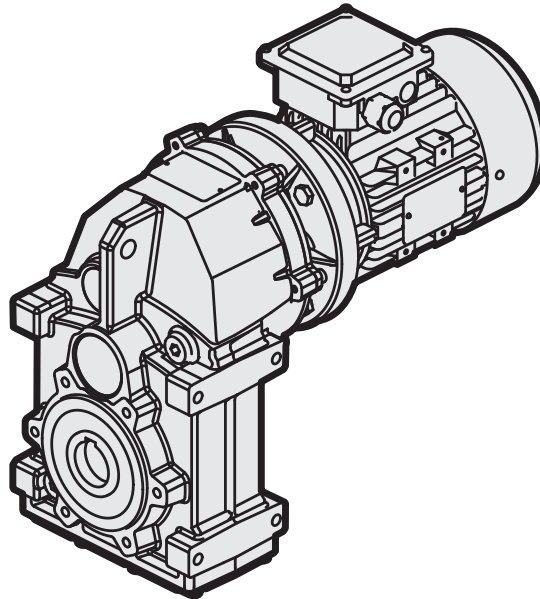

选型

减速机 / GEARBOX

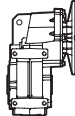
ATS	90	2	U	29.65	D35	90	B5	SZ
类型 Type	型号 Size	级数 Stages	底座/输出法兰型号 Version	速比 Ratio	空心输出轴 Hollow output shaft	IEC 	法兰型号 Version	实心输出轴 Solid output shaft
 ATS	90 91	2 3	U... F...	见表格 see tables	见表格 see tables	63.. — 112..	B5 B14	SZ

底座/输出法兰型式
Gearbox Version

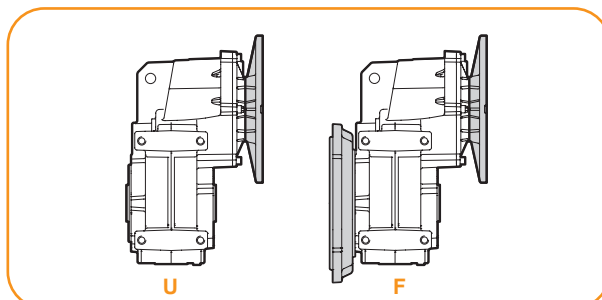

输出轴
Output shaft

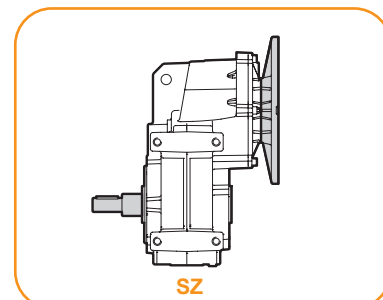

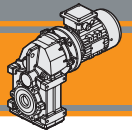

选型

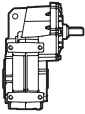
减速机 / GEARBOX						
AT SIS	90	2	U	29.65	D35	SZ
类型 Type	型号 Size	级数 Stages	底座/输出法兰型号 Version	速比 Ratio	空心输出轴 Hollow output shaft	实心输出轴 Solid output shaft
AT SIS	90 91	2 3	U... F...	见表格 see tables	见表格 see tables	SZ
						

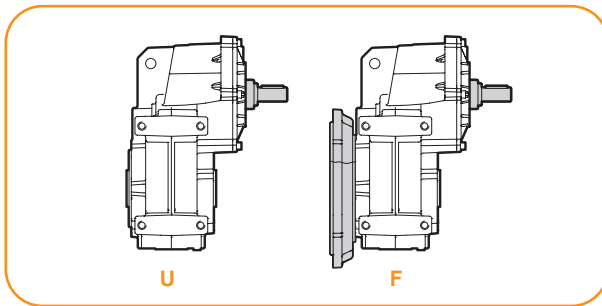

底座/输出法兰型号
Gearbox Version

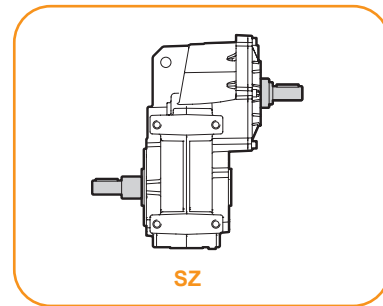

输出轴
Output shaft



ATS

三相电机 / THREE PHASE MOTOR									
TS	63	2	4	0.18 kW	B5	3 ph	230-400 V	50 Hz	T1
类型 Type	型号 Size	功率系数 Power coefficient	极 Poles	功率 Power	法兰型号 Version	相 Phases	电压 Voltage	频率 Frequency	接线盒位置 Terminal box pos.
TS		1-2-3-S L1-L2	4	0.09 kW ... 2.2 kW	B5 B14	3 ph	230-400 V 275-480 V	50Hz 60Hz	

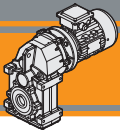

运转方向

Direction of rotation

ATS...2
ATSIS..2

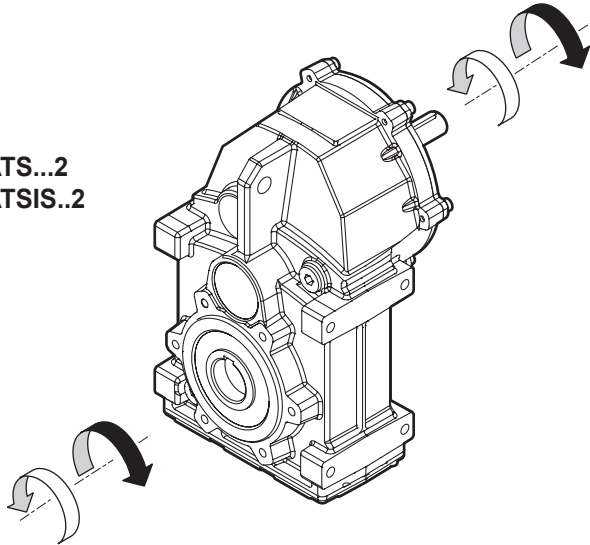

ATS...3
ATSIS..3

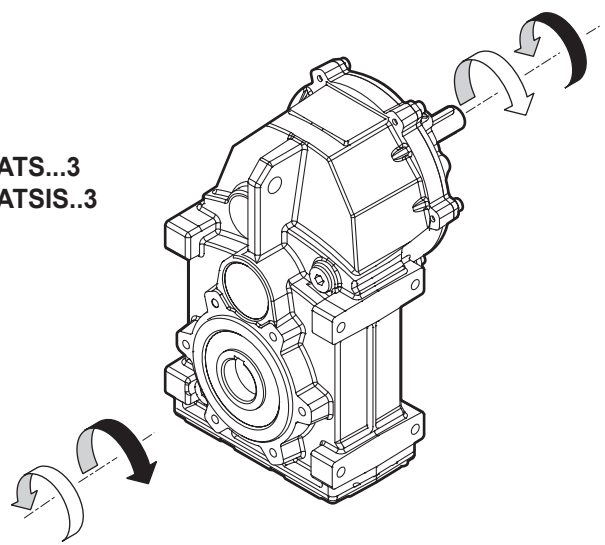

代号说明

Symbols

n_1	[min ⁻¹]	输入转速 / Input speed
n_2	[min ⁻¹]	输出转速 / Output speed
i		速比 / Ratio
P_1	[kW]	输入功率 / Input power
M_2	[Nm]	输出扭矩参照 P_1 / Output torque referred to P_1
P_{n1}	[kW]	额定输入功率 / Nominal input power
M_{n2}	[Nm]	额定输出扭矩参照 P_{n1} / Nominal output torque referred to P_{n1}
 kg	[kg]	减速机重量 / Weight of the gearbox only
sf		服务系数 / Service factor
R_2	[N]	输出端许用径向负荷 / Permitted output radial load
A_2	[N]	输出端许用轴向负荷 / Permitted output axial load

润滑油

Lubrication

使用粘度320的长寿人工合成润滑油，可以在任意安装位置上使用，因此，ATS系列可以在任意位置进行安装并免维护。

Permanent synthetic oil long-life lubrication (viscosity grade 320) makes it possible to use the gearmotors in all mounting positions; for this reason they can be installed in any assembly position and do not require maintenance.

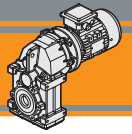

径向负荷

Radial loads

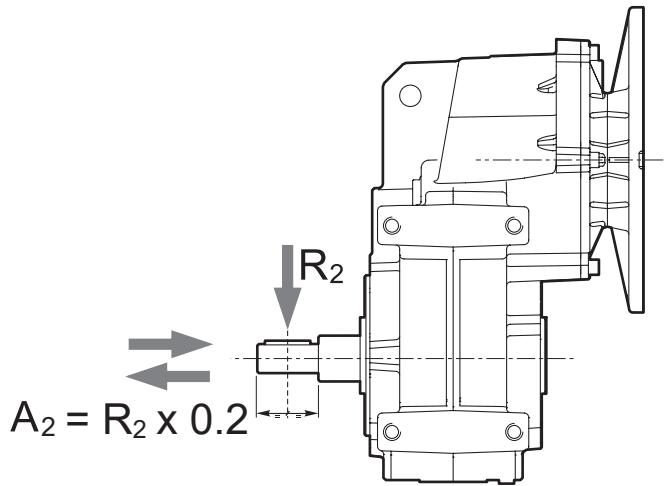

n ₂ [min ⁻¹]	R ₂ [N]	
	ATS 902 ATS 903	ATS 912 ATS 913
240	2400	3600
180	2400	4200
150	2400	4200
120	2500	4600
100	2800	4800
85	3090	5100
70	3150	5250
55	3630	6000
40	4440	6900
30	5100	7800
20	6000	9500
15	6000	10000
10	6000	10000
5	6000	10000

当产生的径向负荷不是作用在传动轴伸出长度的中间位置，必须用以下公式来计算有效负荷：

When the resulting radial load is not applied on the centre line of the shaft it is necessary to calculate the effective load with the following formula:

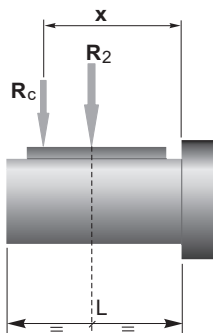

	ATS 902 ATS 903	ATS 912 ATS 913
a	152	174.5
b	97	114.5
R _{2MAX}	6000	10000

$$R_c = \frac{R_2 \cdot a}{(b + x)} \leq R_{2MAX}$$

$$R \leq R_c$$

a, b = 图表中给出的值
a, b = values given in the table

电机适配表

Motors adapters

ATS	TS电机					
	5624	6314 6324 6334	7114 7124 7134 7144	8024 8034	90S4 90L14 90L24	100L14
902						
903						
912						
913						

备注：灰色部分指该型号有适合的电机输入。

N.B. Grey areas indicate motor inputs available on each size of unit.

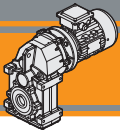

ATS 平行轴式减速机 Helical parallel gearmotors

技术参数

n_1 1400 min⁻¹

Technical data

	n_2 [min ⁻¹]	Mn_2 [Nm]	Pn_1 [kW]	i	IEC 电机适配表 IEC Motor adapters					
					71 B5	80 B5/B14	90 B5/B14	100 B5/B14	112 B5/B14	
ATSIS 902										
	239	200	5.2	5.87	B					
	178	250	4.9	7.87	B					
	148	300	4.8	9.47	B					
	121	350	4.6	11.53	B					
	106	350	4.0	13.26	B					
	89.3	350	3.4	15.68	B					
	84.0	350	3.2	16.68	B					*
	73.3	400	3.2	19.09	B					*
	63.7	400	2.8	21.96	B					*
	52.8	400	2.3	26.50	B					*
	50.7	400	2.2	27.61	B					*
	47.2	400	2.1	29.65	B					*
	41.8	400	1.8	33.49	B			*		*
	39.0	400	1.7	35.87	B			*		*
	36.6	400	1.6	38.29	B			*		*
	31.9	400	1.4	43.88	B			*		*
	28.5	400	1.3	49.09	B			*		*
	26.6	350	1.0	52.71	B			*		*
	25.2	400	1.1	55.45	B			*		*
	22.1	400	0.98	63.41	B			*		*
	19.0	400	0.85	73.64	B			*		*
	16.0	400	0.71	87.27	B			*		*

ATSIS 903					63 B5	71 B5/B14	80 B5/B14	90 B5/B14
	14.0	400	0.62	100.33				*
	11.1	400	0.50	125.89				*
	10.6	400	0.47	131.65				*
	10.0	400	0.45	139.88			*	*
	9.3	400	0.41	151.07			*	*
	8.4	400	0.38	166.13			*	*
	8.1	400	0.36	172.40			*	*
	6.7	400	0.30	208.45			*	*
	6.3	400	0.28	223.41			*	*
	5.6	400	0.25	250.14			*	*
	4.3	400	0.19	323.65		*	*	*
	4.1	400	0.18	345.59		*	*	*
	3.7	400	0.17	376.15		*	*	*
	3.3	400	0.15	424.21		*	*	*

备注:

灰色部分指该型号有适合的电机输入。

B = 金属轴套

N.B.

Highlighted areas indicate motor inputs available on each size of unit.

B = Metal shaft sleeve.



* = 服务系数选择需根据应用情况: 请与我司技术部取得联系。



* = The service factor (sf) has to be selected depending on application: please contact our Technical Department.

减速机选型前请参考E8至E11页的技术参数表格。

Before selecting any gearbox, please read the performance values shown in the tables on page E8 to E11.

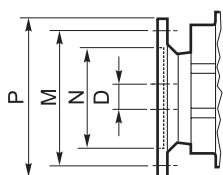

IEC尺寸参数 / IEC Dimensions									
	63 B5	71 B5	71 B14	80 B5	80 B14	90 B5	90 B14	100/112 B5	100/112 B14
N	95	110	70	130	80	130	95	180	110
M	115	130	85	165	100	165	115	215	130
P	140	160	105	200	120	200	140	250	160
D	11	14		19		24		28	

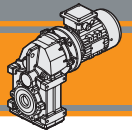

技术参数

n_1 1400 min⁻¹

Technical data

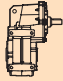
	n_2 [min ⁻¹]	Mn_2 [Nm]	Pn_1 [kW]	i	IEC 电机适配表 IEC Motor adapters					
					71 B5	80 B5/B14	90 B5/B14	100 B5/B14	112 B5/B14	
ATSIS 912										
	245.0	350	9.4	5.71	B					
	183	350	7.0	7.66	B					
	158	400	6.9	8.85	B					
	152	400	6.6	9.22	B					
	125	400	5.4	11.23	B					
	118	400	5.1	11.87	B					
	108	500	5.9	12.92	B					
	98.0	500	5.3	14.29	B					
	86.2	500	4.7	16.24	B					
	80.5	500	4.4	17.39	B					
	70.0	600	4.6	20.01	B					
	66.3	600	4.3	21.10	B					
	55.6	600	3.6	25.16	B					
	54.2	600	3.5	25.81	B					*
	48.5	600	3.2	28.88	B					*
	42.8	600	2.9	32.69	B					*
	37.5	520	2.2	37.30	B					*
	35.0	600	2.3	39.98	B					*
	31.3	600	2.1	44.73	B					*
	27.7	600	1.9	50.53	B			*		*
	24.2	600	1.6	57.77	B			*		*
	20.9	600	1.4	67.09	B			*		*
	17.6	520	1.0	79.52	B			*		*

ATSIS913					63 B5	71 B5/B14	80 B5/B14	90 B5/B14
	17.0	600	1.1	82.28				
	14.9	600	1.0	93.96				
	13.8	600	0.92	101.41				*
	11.4	600	0.76	122.61				*
	10.7	600	0.71	131.41				*
	9.5	600	0.64	147.13				*
	8.9	600	0.60	157.08				*
	7.4	600	0.49	189.92				*
	6.9	600	0.46	203.55			*	*
	6.1	600	0.41	227.91			*	*
	4.7	600	0.32	294.88			*	*
	4.4	600	0.30	314.87			*	*
	4.1	600	0.27	342.72			*	*
	3.6	600	0.24	386.51			*	*

备注:

灰色部分指该型号有适合的电机输入。

B = 金属轴套

N.B.

Highlighted areas indicate motor inputs available on each size of unit.

B = Metal shaft sleeve.



* = 服务系数选择需根据应用情况: 请与我司技术部取得联系。



* = The service factor (sf) has to be selected depending on application: please contact our Technical Department.

减速机选型前请参考E8至E11页的技术参数表格。

Before selecting any gearbox, please read the performance values shown in the tables on page E8 to E11.

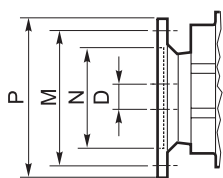

IEC尺寸参数 / IEC Dimensions									
	63 B5	71 B5	71 B14	80 B5	80 B14	90 B5	90 B14	100/112 B5	100/112 B14
N	95	110	70	130	80	130	95	180	110
M	115	130	85	165	100	165	115	215	130
P	140	160	105	200	120	200	140	250	160
D	11	14		19		24		28	

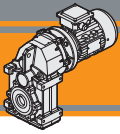





ATS 平行轴式减速机

Helical parallel gearmotors

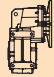
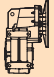
技术参数

Technical data





P_1 [kW]	n_2 [min ⁻¹]	M_2 [Nm]	sf	i		P_1 [kW]	n_2 [min ⁻¹]	M_2 [Nm]	sf	i		
0.12						0.25						
TS6314  (1400 min ⁻¹)	14	77	5.2	100.33	ATS903	TS7114  (1400 min ⁻¹)	239	10	20.8	5.87	ATS902	
	11	97	4.1	125.89			178	13	19.4	7.87		
	11	101	3.9	131.65			148	16	19.3	9.47		
	10	108	3.7	139.88			121	19	18.5	11.53		
	9.3	116	3.4	151.07			106	22	16.1	13.26		
	8.4	128	3.1	166.13			89	26	13.6	15.68		
	8.1	133	3.0	172.40			84	27	12.8	16.68		
	6.7	160	2.5	208.45			73	31	12.8	19.09		
	6.3	172	2.3	223.41			64	36	11.1	21.96		
	5.6	192	2.1	250.14			53	43	9.2	26.50		
	4.3	249	1.6	323.65			51	45	8.8	27.61		
	4.1	266	1.5	345.59			47	49	8.2	29.65		
	3.7	289	1.4	376.15			42	55	7.3	33.49		
	3.3	326	1.2	424.21			39	59	6.8	35.87		
					ATS913	37	61	6.5	38.29			
	6.9	157	3.8	203.55			32	70	5.7	43.88		
	6.1	175	3.4	227.91			29	79	5.1	49.09		
	4.7	227	2.6	294.88			27	84	4.1	52.71		
	4.4	242	2.5	314.87			25	89	4.5	55.45		
	4.1	264	2.3	342.72			22	102	3.9	63.41		
	3.6	297	2.0	386.51			19	118	3.4	73.64		
							16	140	2.9	87.27		
0.18												
TS6324  (1400 min ⁻¹)	14	116	3.5	100.33	ATS903	TS6334  TS7114 (1400 min ⁻¹)	14	161	2.5	100.33	ATS903	
	11	145	2.8	125.89			11	202	2.0	125.89		
	11	152	2.6	131.65			11	211	1.9	131.65		
	10	161	2.5	139.88			10	224	1.8	139.88		
	9.3	174	2.3	151.07			9.3	242	1.7	151.07		
	8.4	192	2.1	166.13			8.4	266	1.5	166.13		
	8.1	199	2.0	172.40			8.1	276	1.4	172.40		
	6.7	241	1.7	208.45			6.7	334	1.2	208.45		
	6.3	258	1.6	223.41			6.3	358	1.1	223.41		
	5.6	289	1.4	250.14			6.3	358	1.1	223.41		
	4.3	374	1.1	323.65			5.6	401	1.0	250.14		
	4.1	399	1.0	345.59								ATS913
	3.7	434	0.9	376.15			14	163	3.7	101.41		
	3.3	490	0.8	424.21			11	197	3.1	122.61		
						11	211	2.8	131.41			
	9.5	170	3.5	147.13	ATS913	9.5	236	2.5	147.13			
	8.9	181	3.3	157.08			8.9	252	2.4	157.08		
	7.4	219	2.7	189.92			7.4	304	2.0	189.92		
	6.9	235	2.6	203.55			6.9	326	1.8	203.55		
	6.1	263	2.3	227.91			6.1	365	1.6	227.91		
	4.7	340	1.8	294.88			4.7	473	1.3	294.88		
	4.4	363	1.7	314.87			4.4	505	1.2	314.87		
	4.1	396	1.5	342.72			4.1	549	1.1	342.72		
	3.6	446	1.3	386.51			3.6	620	1.0	386.51		

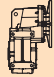
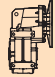

TS		
电机 Motors	6314 6324 6334	7114
IEC	63 B5	71 B5 / B14

技术参数

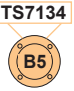
Technical data

P ₁ [kW]	n ₂ [min ⁻¹]	M ₂ [Nm]	sf	i		P ₁ [kW]	n ₂ [min ⁻¹]	M ₂ [Nm]	sf	i	
0.37						0.55					
 TS7124 (1400 min ⁻¹)	239	14	14.1	5.87	ATS902	 TS7134 (1400 min ⁻¹)	239	21	9.5	5.87	ATS902
	178	19	13.1	7.87			178	28	8.8	7.87	
	148	23	13.1	9.47			148	34	8.8	9.47	
	121	28	12.5	11.53			121	42	8.4	11.53	
	106	32	10.9	13.26			106	48	7.3	13.26	
	89	38	9.2	15.68			89	56	6.2	15.68	
	84	40	8.7	16.68			84	60	5.8	16.68	
	73	46	8.6	19.09			73	69	5.8	19.09	
	64	53	7.5	21.96			64	79	5.1	21.96	
	53	64	6.2	26.50			53	95	4.2	26.50	
	51	67	6.0	27.61			51	99	4.0	27.61	
	47	72	5.6	29.65			47	107	3.7	29.65	
	42	81	4.9	33.49			42	121	3.3	33.49	
	39	87	4.6	35.87			39	129	3.1	35.87	
	37	91	4.4	38.29			37	135	3.0	38.29	
	32	104	3.8	43.88			32	155	2.6	43.88	
	29	116	3.4	49.09			29	173	2.3	49.09	
27	125	2.8	52.71	27	186	1.9	52.71				
25	132	3.0	55.45	25	196	2.0	55.45				
22	150	2.7	63.41	22	224	1.8	63.41				
19	175	2.3	73.64	19	260	1.5	73.64				
16	207	1.9	87.27	16	308	1.3	87.27				
TS7124 (1400 min ⁻¹)	14	238	1.7	100.33	ATS903	TS7134 TS8014 (1400 min ⁻¹)	14	354	1.1	100.33	ATS903
	11	299	1.3	125.89			11	444	0.9	125.89	
	11	312	1.3	131.65			11	464	0.9	131.65	
	10	332	1.2	139.88			10	493	0.8	139.88	
	9.3	358	1.1	151.07							
	8.4	394	1.0	166.13							
8.1	409	1.0	172.40								
 TS7124 (1400 min ⁻¹)	24	137	4.4	57.77	ATS912	 TS7134 (1400 min ⁻¹)	31	158	3.8	44.73	ATS912
	21	159	3.8	67.09			28	178	3.4	50.53	
	18	189	2.8	79.52			24	204	2.9	57.77	
TS7124 (1400 min ⁻¹)	17	195	3.1	82.28	ATS913	TS7134 TS8014 (1400 min ⁻¹)	17	290	2.1	82.28	ATS913
	15	223	2.7	93.96			15	331	1.8	93.96	
	14	241	2.5	101.41			14	358	1.7	101.41	
	11	291	2.1	122.61			11	432	1.4	122.61	
	11	312	1.9	131.41			11	463	1.3	131.41	
	9.5	349	1.7	147.13			11	463	1.3	131.41	
	8.9	373	1.6	157.08			9.5	519	1.2	147.13	
	7.4	451	1.3	189.92			8.9	554	1.1	157.08	
	6.9	483	1.2	203.55			8.9	554	1.1	157.08	
	6.1	541	1.1	227.91			7.4	670	0.9	189.92	
	4.7	700	0.9	294.88			6.9	718	0.8	203.55	



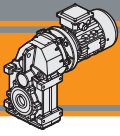

电机 Motors	TS	
	7124 7134	8014
IEC	71 B5 / B14	80 B5 / B14



ATS 平行轴式减速机 Helical parallel gearmotors

技术参数

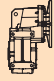
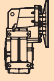
Technical data

P ₁ [kW]	n ₂ [min ⁻¹]	M ₂ [Nm]	sf	i		P ₁ [kW]	n ₂ [min ⁻¹]	M ₂ [Nm]	sf	i			
0.75						1.1							
TS7144  TS8024 (1400 min ⁻¹)	89	77	4.5	15.68	ATS902	TS8034 TS90S4 (1400 min ⁻¹)	47	214	1.9	29.65	ATS902		
	84	82	4.3	16.68			42	241	1.7	33.49			
	73	94	4.3	19.09			39	258	1.5	35.87			
	64	108	3.7	21.96			37	270	1.5	38.29			
	53	130	3.1	26.50			32	310	1.3	43.88			
	51	136	2.9	27.61			29	346	1.2	49.09			
	47	146	2.7	29.65			25	391	1.0	55.45			
	42	164	2.4	33.49			22	447	0.9	63.41			
	39	176	2.3	35.87									
	37	184	2.2	38.29				66	152	3.9		21.10	ATS912
	32	211	1.9	43.88				56	181	3.3		25.16	
	29	236	1.7	49.09				54	186	3.2		25.81	
	27	253	1.4	52.71				48	204	2.9		28.88	
	25	267	1.5	55.45				43	231	2.6		32.69	
		22	305	1.3			63.41		38	263		2.0	37.30
		19	354	1.1	73.64		35	282	2.1	39.98			
		16	420	1.0	87.27		31	315	1.9	44.73			
							28	356	1.7	50.53			
		43	157	3.8	32.69	ATS912	24	407	1.5	57.77			
		38	179	2.9	37.30		21	473	1.3	67.09			
	35	192	3.1	39.98									
	31	215	2.8	44.73			17	580	1.0	82.28			
	28	243	2.5	50.53			15	663	0.9	93.96			
	24	278	2.2	57.77									
	21	323	1.9	67.09									
	18	382	1.4	79.52									
TS7144 TS8024 (1400 min ⁻¹)	17	396	1.5	82.28	ATS913	1.5							
	15	452	1.3	93.96		TS90L14 (1400 min ⁻¹)	239	58	3.5	5.87	ATS902		
	14	488	1.2	101.41			178	77	3.2	7.87			
	11	590	1.0	122.61			148	93	3.2	9.47			
	11	632	0.9	131.41			121	113	3.1	11.53			
				106	130		2.7	13.26					
1.1						89	154	2.3	15.68				
TS8034 TS90S4 (1400 min ⁻¹)	239	42	4.7	5.87	ATS902	84	164	2.1	16.68				
	178	57	4.4	7.87		73	188	2.1	19.09				
	148	68	4.4	9.47		64	216	1.9	21.96				
	121	83	4.2	11.53		53	260	1.5	26.50				
	106	96	3.7	13.26		51	271	1.5	27.61				
	89	113	3.1	15.68		47	291	1.4	29.65				
	84	120	2.9	16.68		42	329	1.2	33.49				
	73	138	2.9	19.09		39	352	1.1	35.87				
	64	158	2.5	21.96		37	368	1.1	38.29				
	53	191	2.1	26.50		32	422	0.9	43.88				
	51	199	2.0	27.61									
							108	127	3.9	12.92	ATS912		
							98	140	3.6	14.29			
							86	160	3.1	16.24			
							80	171	2.9	17.39			
					70	197	3.1	20.01					
					66	207	2.9	21.10					
					56	247	2.4	25.16					



电机 Motors	TS		
	7144	8024 8034	90S4 90L14
IEC	71 B5 / B14	80 B5 / B14	90 B5 / B14

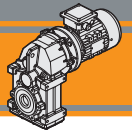

技术参数

Technical data

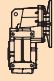
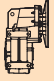
P ₁ [kW]	n ₂ [min ⁻¹]	M ₂ [Nm]	sf	i		P ₁ [kW]	n ₂ [min ⁻¹]	M ₂ [Nm]	sf	i	
1.5						3.0					
TS90L14 (1400 min ⁻¹)	54	254	2.4	25.81	ATS912	TS100L24 (1400 min ⁻¹)	239	115	1.7	5.87	ATS902
	48	278	2.2	28.88			178	155	1.6	7.87	
	43	314	1.9	32.69			148	186	1.6	9.47	
	38	359	1.4	37.30			121	227	1.5	11.53	
	35	385	1.6	39.98			106	261	1.3	13.26	
	31	430	1.4	44.73			89	308	1.1	15.68	
	28	486	1.2	50.53			84	328	1.1	16.68	
	24	556	1.1	57.77			73	375	1.1	19.09	
21	645	0.9	67.09	64	431	0.9	21.96				
2.2						4.0					
TS90L24 TS100L14 (1400 min ⁻¹)	239	85	2.4	5.87	ATS902	TS112M4 (1400 min ⁻¹)	239	154	1.3	5.87	ATS902
	178	113	2.2	7.87			178	206	1.2	7.87	
	148	136	2.2	9.47	ATS912	148	248	1.2	9.47	ATS912	
	121	166	2.1	11.53		121	302	1.2	11.53		
	106	191	1.8	13.26		106	347	1.0	13.26		
	89	226	1.5	15.68		89	411	0.9	15.68		
	84	240	1.5	16.68		245	150	2.3	5.71		
	73	275	1.5	19.09		183	201	1.7	7.66		
	64	316	1.3	21.96		158	232	1.7	8.85		
	53	382	1.0	26.50		152	242	1.7	9.22		
	51	398	1.0	27.61		125	294	1.4	11.23		
	47	427	0.9	29.65		118	311	1.3	11.87		
	245	82	4.3	5.71		108	338	1.5	12.92		
	183	110	3.2	7.66		98	374	1.3	14.29		
	158	128	3.1	8.85		86	425	1.2	16.24		
	152	133	3.0	9.22		80	456	1.1	17.39		
	125	162	2.5	11.23		70	524	1.1	20.01		
	118	171	2.3	11.87		66	553	1.1	21.10		
	108	186	2.7	12.92		56	659	0.9	25.16		
	98	206	2.4	14.29							
	86	234	2.1	16.24							
	80	251	2.0	17.39							
70	288	2.1	20.01								
66	304	2.0	21.10								
56	362	1.7	25.16								
54	372	1.6	25.81								
48	407	1.5	28.88								
43	461	1.3	32.69								
35	564	1.1	39.98								
31	631	1.0	44.73								

ATS



电机 Motors	TS		
	90L14 90L24	100L14 100L24	112M4
IEC	90 B5 / B14	100 B5 / B14	112 B5 / B14

电机技术参数

Electrical technical data

请参见专用页:

Please see the dedicated paragraph:

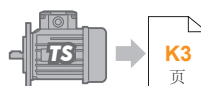

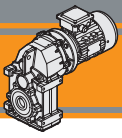

ATS 902

ATS 902 U..

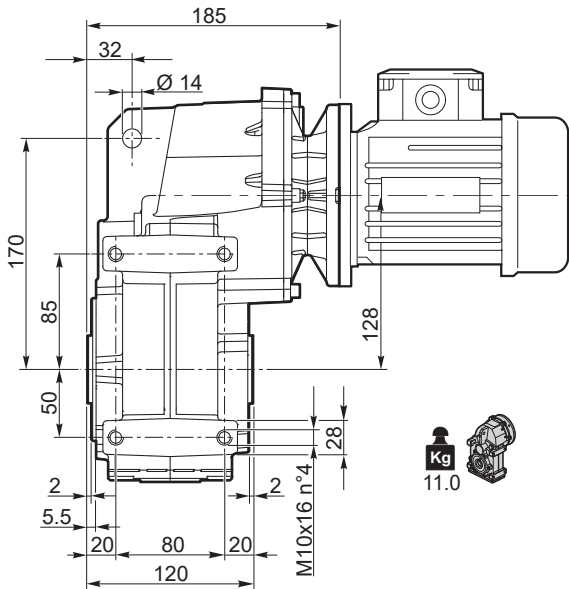

ATSIS 902 U..

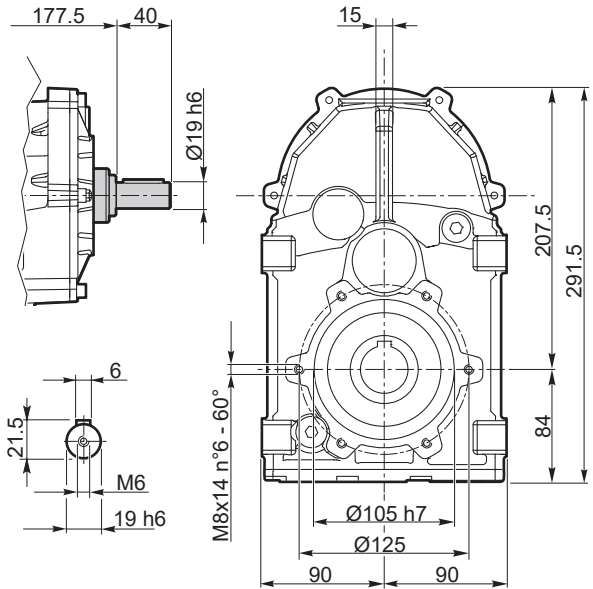

ATS 902 F..

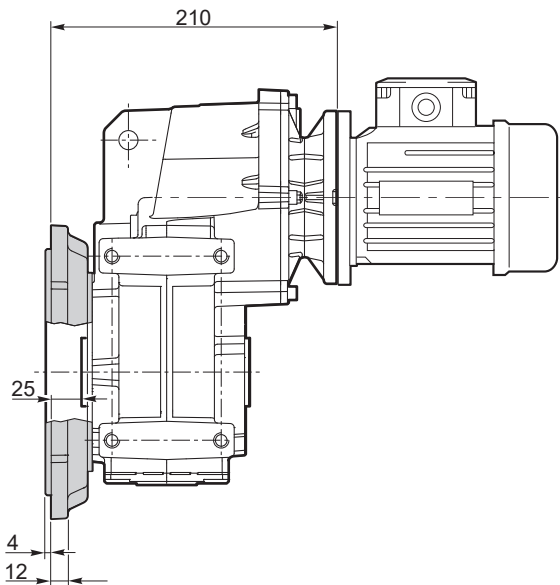

ATSIS 902 F..

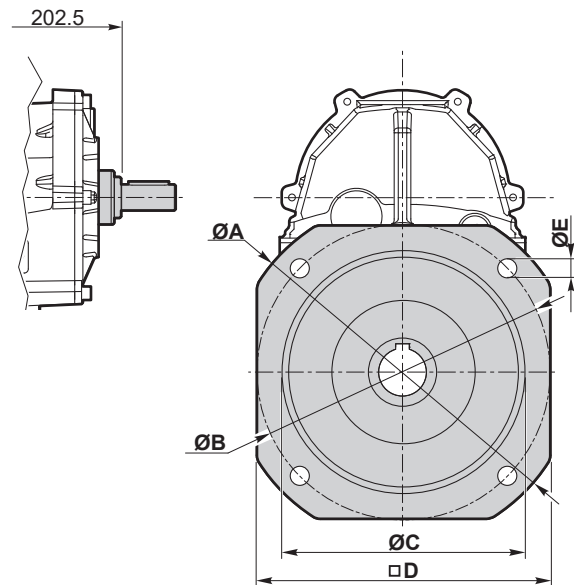

F型 / F Version						法兰 / Flange	
ATS ATSIS	ØA	ØB	ØC f7	□D	ØE	类型 / Type	重量 / Weight [kg]
902	200	165	130	165	11	F200	2
	250	215	180	215	14	F250	3.2

ATS 902.. D35 - ATSIS 902.. D35

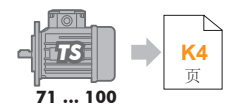
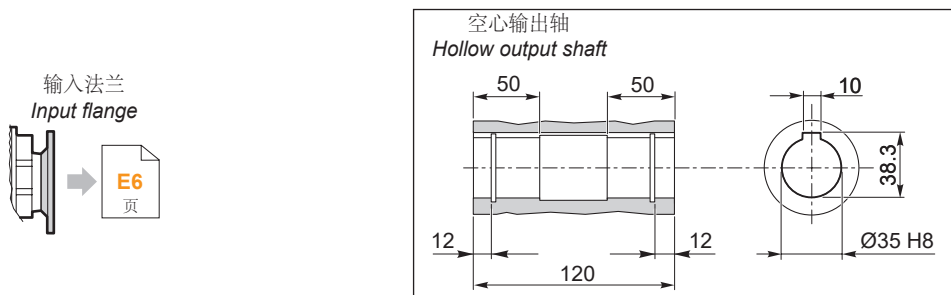

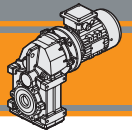

尺寸参数

Dimensions

ATS 903

ATS 903 U..

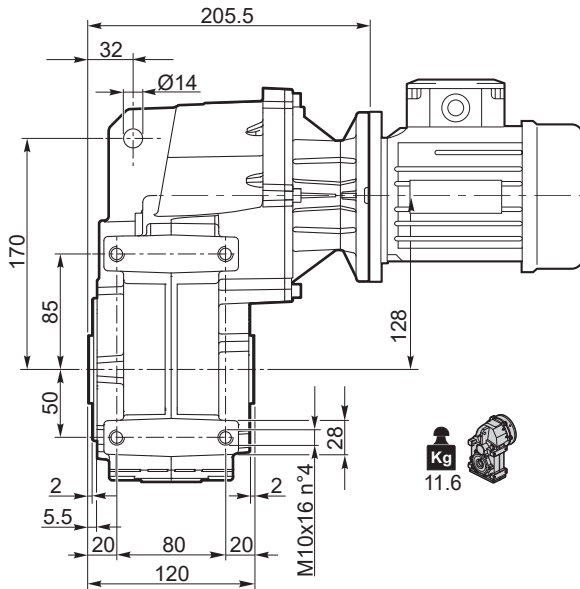

ATSIS 903 U..

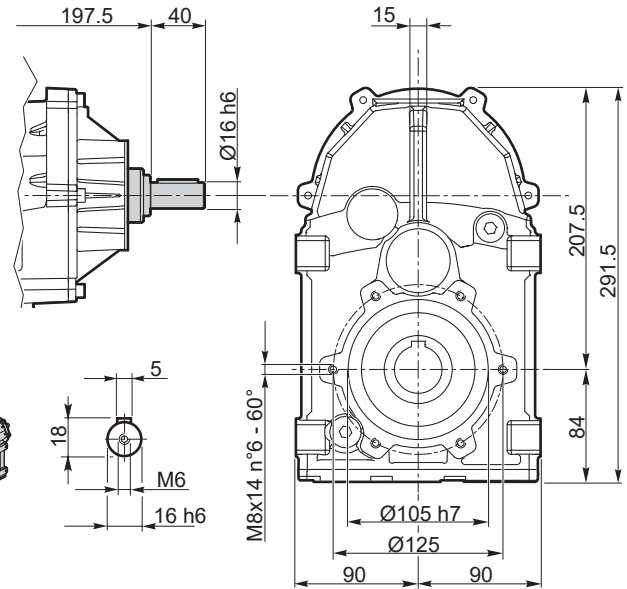

ATS 903 F..

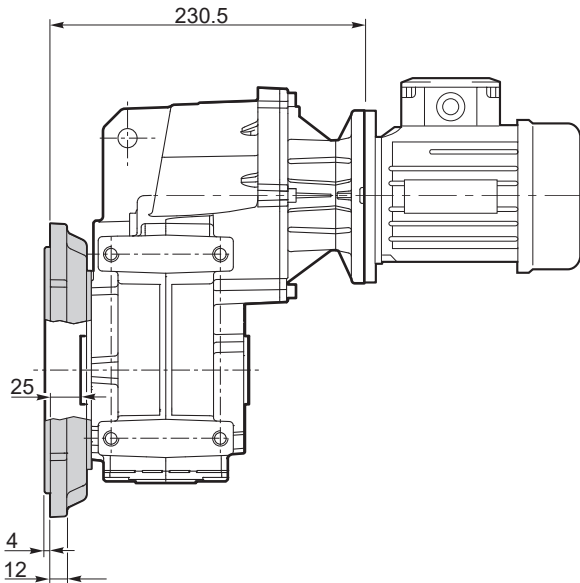

ATSIS 903 F..

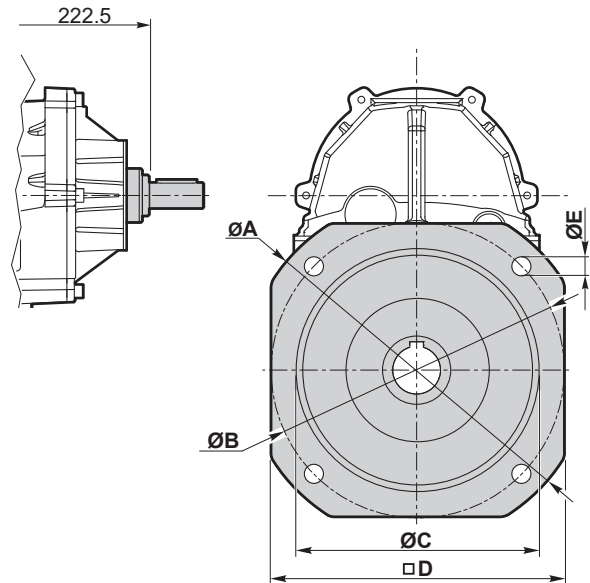

F型 / F Version							
ATS ATSIS	ØA	ØB	ØC f7	□D	ØE	法兰 / Flange	
						类型 / Type	重量 / Weight [kg]
903	200	165	130	165	11	F200	2
	250	215	180	215	14	F250	3.2

ATS 903.. D35 - ATSIS 903.. D35

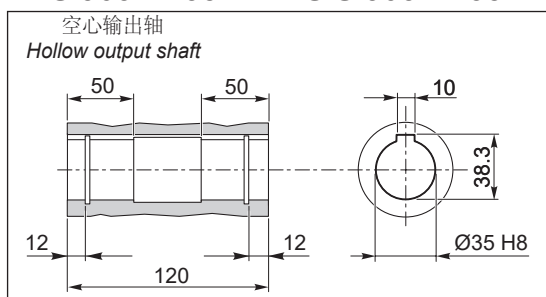

输入法兰
Input flange

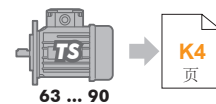

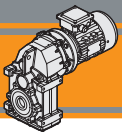

ATS 912

ATS 912 U..

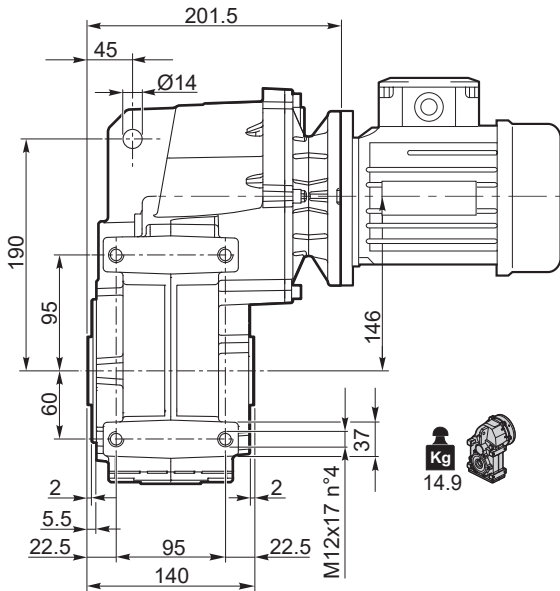

ATSIS 912 U..

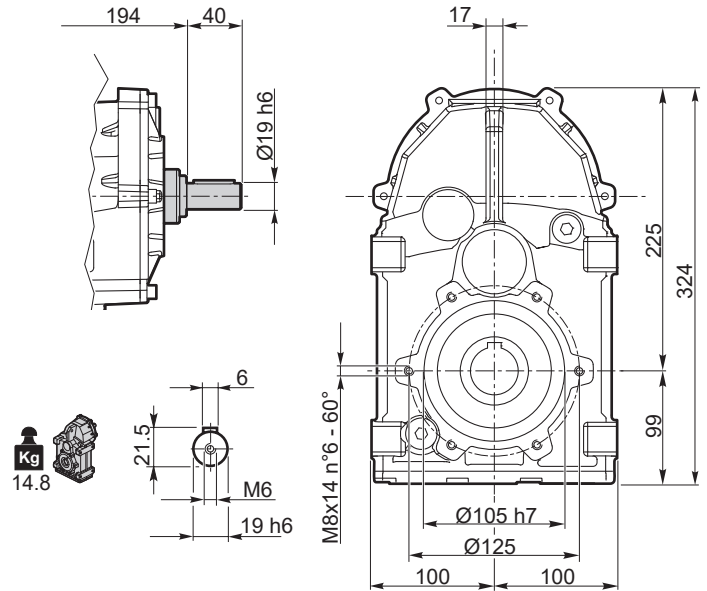

ATS 912 F..

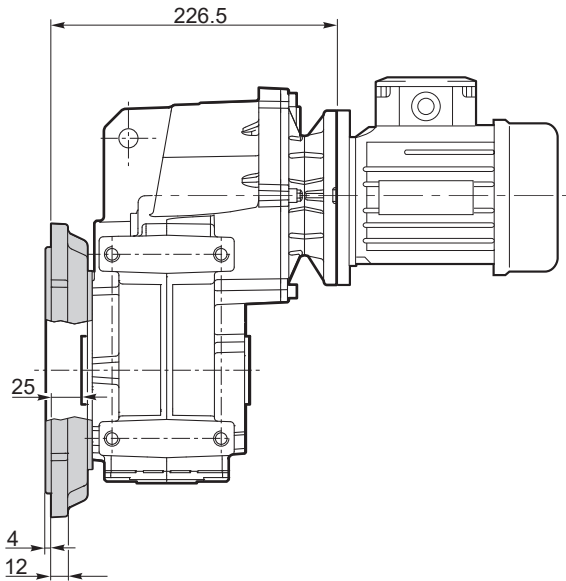

ATSIS 912 F..

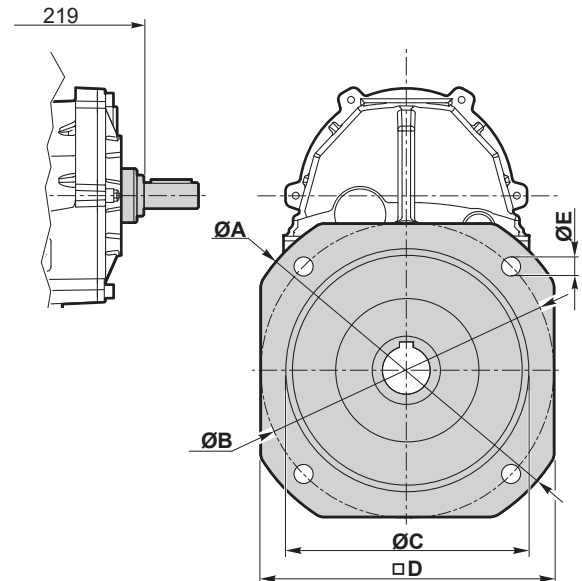

F型 / F Version							
ATS ATSIS	ØA	ØB	ØC f7	□D	ØE	法兰 / Flange	
						类型 / Type	重量 / Weight [kg]
912	200	165	130	165	11	F200	2
	250	215	180	215	14	F250	3.2

ATS 912.. D40 - ATSIS 912.. D40

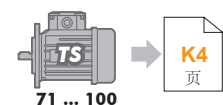
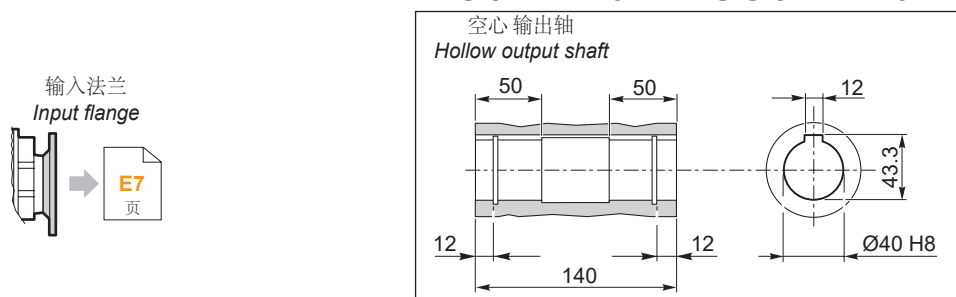

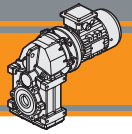

尺寸参数

Dimensions

ATS 913

ATS 913 U..

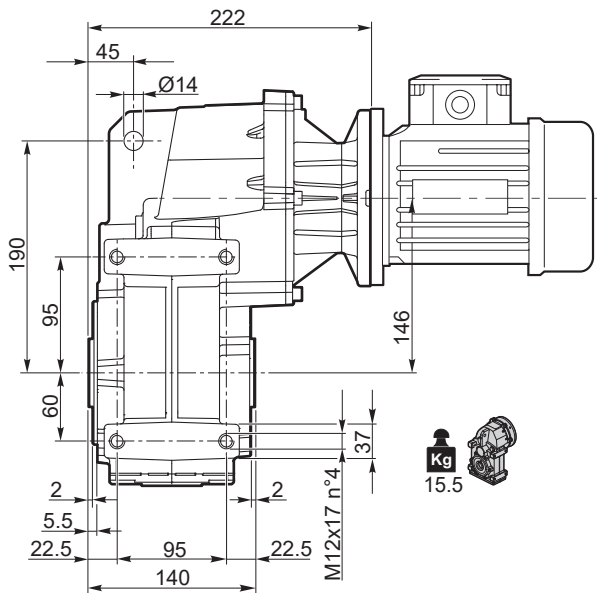

ATSIS 913 U..

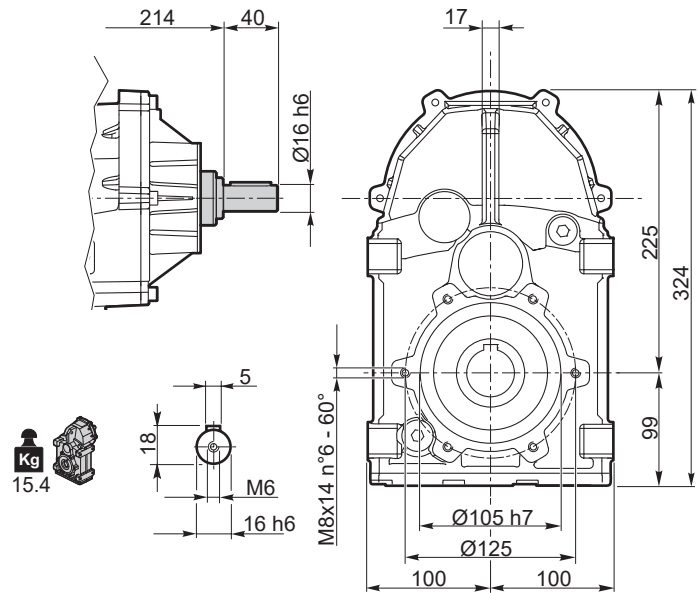

ATS 913 F..

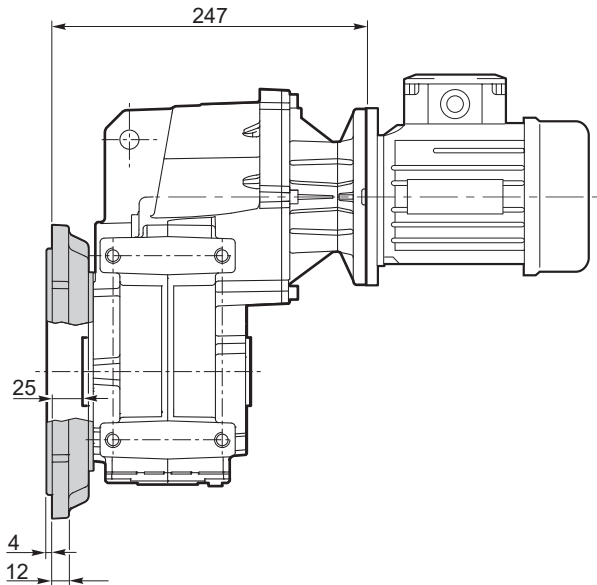

ATSIS 913 F..

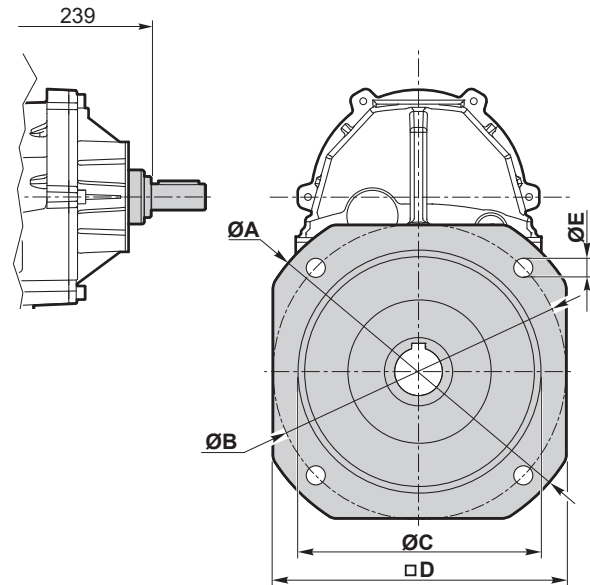

F型 / F Version							
ATS ATSIS	ØA	ØB	ØC f7	□D	ØE	法兰 / Flange	
						类型 / Type	重量 / Weight [kg]
913	200	165	130	165	11	F200	2
	250	215	180	215	14	F250	3.2

ATS 913.. D40 - ATSIS 913.. D40

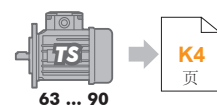
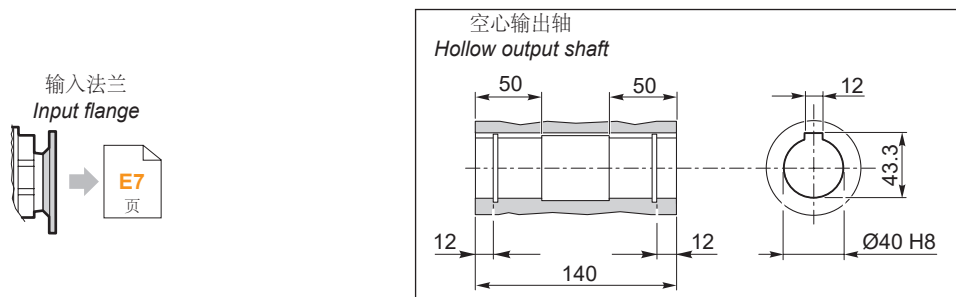

ATS

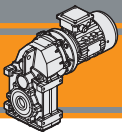

附件

Accessories

单向输出轴

Single output shaft

ATS90... U .. SZ

ATSIS90... U .. SZ

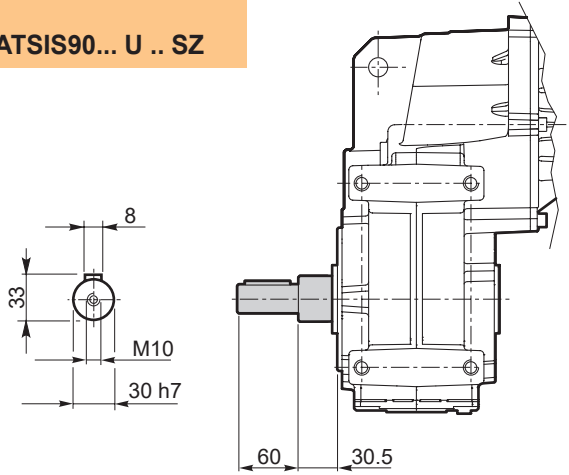

ATS90... F .. SZ

ATSIS90... F .. SZ

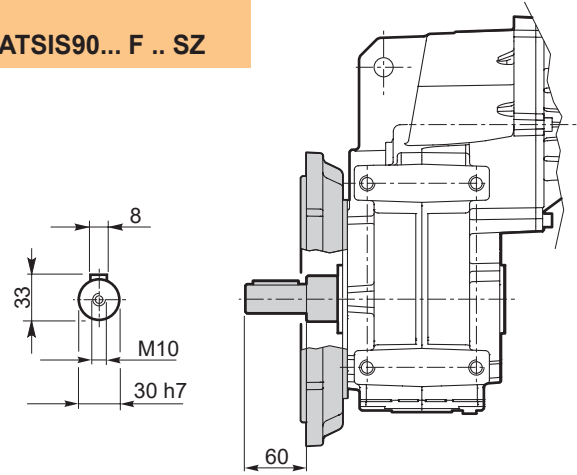

ATS91... U .. SZ

ATSIS91... U .. SZ

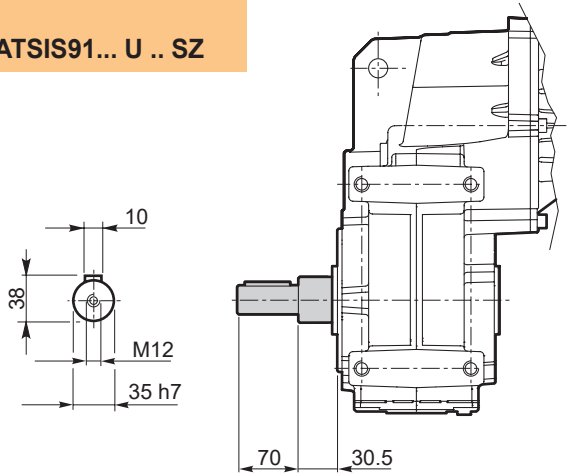

ATS91... F .. SZ

ATSIS91... F .. SZ

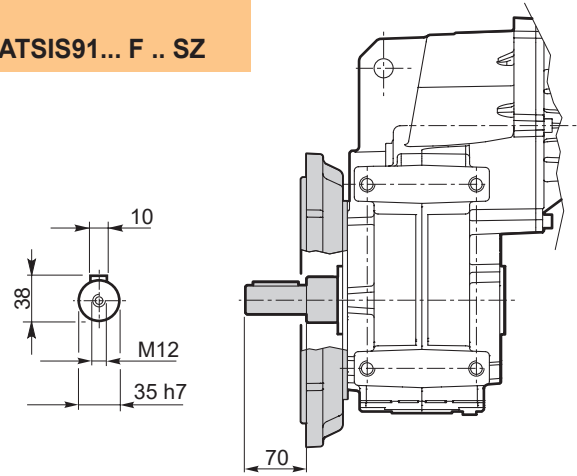

带锁紧盘的输出轴

Output shaft with shrink disk

ATS90... U .. G35

ATSIS90... U .. G35

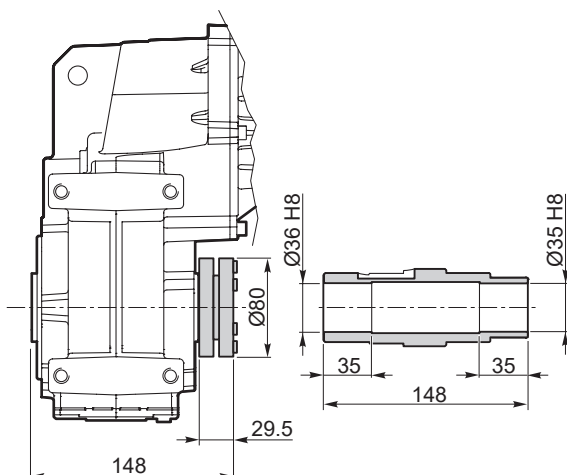

ATS91... U .. G40

ATSIS91... U .. G40

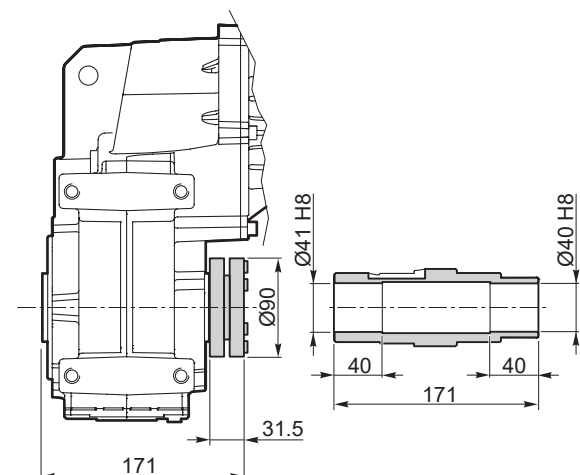

带锁紧盘中空输出轴可按需求订购：
装配指导请联系我司技术部门。

Output shaft kit with shrink disk available on request:
for assembly instructions please contact our Technical Service

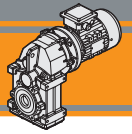

附件

Accessories

输出轴装配组件

Output shaft assembly kit

ATS90...
ATS91...
ATSIS90...
ATSIS91...

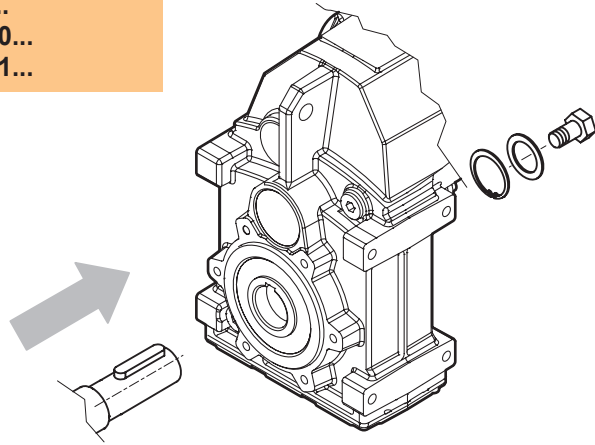

输出轴装配组件可按需求订购：装配指导请联系我司技术部门。

*Output shaft assembly kit available upon request:
for assembly instructions please contact our Technical Assistance*

输出轴拆装组件

Output shaft disassembly kit

ATS90...
ATS91...
ATSIS90...
ATSIS91...

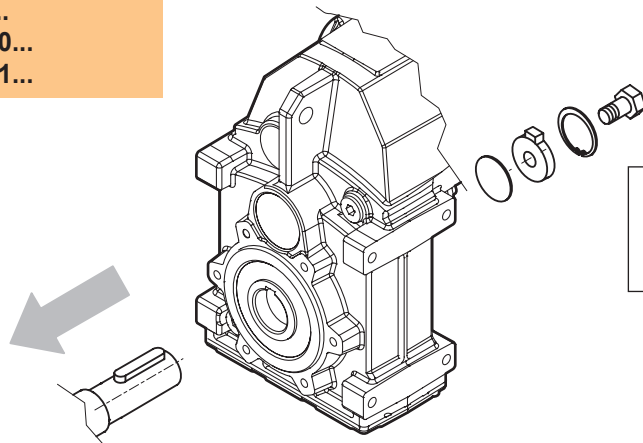

输出轴拆装组件可按需求订购：装配指导请联系我司技术部门。

*Output shaft disassembly kit available upon request:
for assembly instructions please contact our Technical Assistance*

扭力臂组件

Torque arm kit

ATS90...U
ATS91...U
ATSIS90...U
ATSIS91...U

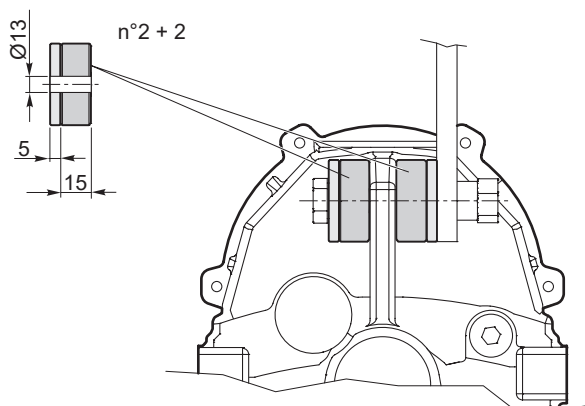

扭力臂可按需求订购：装配指导请联系我司技术部门。

*Torque arm kit available upon request:
for assembly instructions please contact our Technical Assistance*

ATS

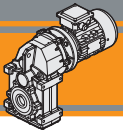

ATS

平行轴式减速机
Helical parallel gearmotors

注释/Notes

 **TRANSTECNO SRL**
HEADQUARTERS

Company subject to the management
and coordination of INTERPUMP GROUP SPA
Via Caduti di Sabbiuno, 11/D-E
40011 Anzola dell'Emilia (BO)
ITALY
T+39 051 64 25 811
F +39 051 73 49 43
sales@transtecno.com
www.transtecno.com

TRANSTECNO®
the modular gearmotor
MEMBER OF INTERPUMP GROUP



 **HANGZHOU INTERPUMP
POWER TRANSMISSIONS CO LTD**
No.4 Xiuyan Road Fengdu Industry Zone
Pingyao Town Yuhang District
Hangzhou City, Zhejiang Province
311115 – CHINA
T +86 571 86 92 02 60
info-china@transtecno.cn
www.transtecno.cn

 **TRANSTECNO IBÉRICA
THE MODULAR GEARMOTOR, S.A.**
Carrer de la Ciència, 45
08840 Viladecans (Barcelona) - SPAIN
T +34 931 598 950
info@transtecno.es
www.transtecno.es

 **TRANSTECNO B.V.**
Siliciumweg 32
3812 SX Amersfoort - NETHERLANDS
T +31(0) 33 45 19 505
info@transtecno.nl
www.transtecno.nl

 **TRANSTECNO AANDRIJFTECHNIEK B.V.**
Siliciumweg 32
3812 SX Amersfoort - NETHERLANDS
T +31 (0) 33 20 47 006
info@transtecnoaandrijftechnik.nl
www.transtecnoaandrijftechnik.nl

 **MA TRANSTECNO S.A.P.I. DE C.V.**
Julián Sepúlveda Dávila #107,
Parque Industrial SG
Apodaca, Nuevo León, CP. 66640
MÉXICO
T +52 8113340920
info@transtecno.com.mx
www.transtecno.com.mx

 **TRANSTECNO USA**
8 Creek Parkway,
Boothwyn PA 19061-8136 - UNITED STATES
T + 1 (610) 4970154

TRANSTECNO USA – WEST COAST BRANCH
14561 Fryelands Blvd SE
Monroe, WA 98272 - UNITED STATES
T +1 360-863-1300
usaoffice@transtecno.com
www.transtecno.com

 **TRANSTECNO CANADA**
51 B Caldari Road Unit 10
Vaughan, ON L4K 4G3 - CANADA
T +1 905 761 0762
canadaoffice@transtecno.com
www.transtecno.com

 **TRANSTECNO INDIA**
#6A, Sipcot Industrial complex, Phase-1,Elasagiri Road
Hosur – 635126 Tamilnadu - INDIA
T +91 4344 274434
M +91 81443 88800

TRANSTECNO INDIA – NORTH BRANCH
Plot No: 3 A, Sector 2, IIE, Sidcul, Pantnagar
U.S. Nagar, Uttarakhand – 263153 - INDIA
indiaoffice@transtecno.com
www.transtecno.com

 **TRANSTECNO BRAZIL**
Rua Gilberto de Zorzi, 525 Forqueta - CEP. 95115-730
CX Postal 3544 Caxias do Sul RS – BRAZIL

TRANSTECNO BRAZIL – SÃO PAULO BRANCH
R. Mafalda Barnabe Soliane, 314 – CEP. 13347-610
Indaiatuba, São Paulo - BRAZIL
T +55 19 3437 2520

TRANSTECNO BRAZIL – PORTO ALEGRE BRANCH
Rua Dr. Freire Alemão 155 / 402 - CEP. 90450-060
Auxiliadora Porto Alegre RS - BRAZIL
T +55 51 4042 0916
M +55 51 811 45 962
braziloffice@transtecno.com
www.transtecno.com.br

 **INTERPUMP ANTRIEBSTECHNIK GMBH**
Büro Stuttgart - GERMANY
T +49 (0)171 4781909
germanoffice@transtecno.com
www.transtecno.com

 **SALES OFFICE OCEANIA**
Unit 5, 12 Nyholt Drive, Yatala 4207
Queensland - AUSTRALIA
T +61 07 3800 0103
M +61 04 38060997

UNIT 9, 94 Boundary Rd, Sunshine West 3020
Victoria - AUSTRALIA
T +61 9312 4722
oceaniaoffice@transtecno.com
www.transtecno.com.au