

**TRANSTECNO**<sup>®</sup>  
the modular gearmotor

**CMPU**

CMPU

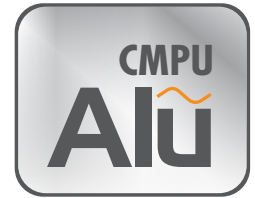

蜗轮蜗杆减速电机配PU前置级  
**PU pre-stage wormgearmotors**

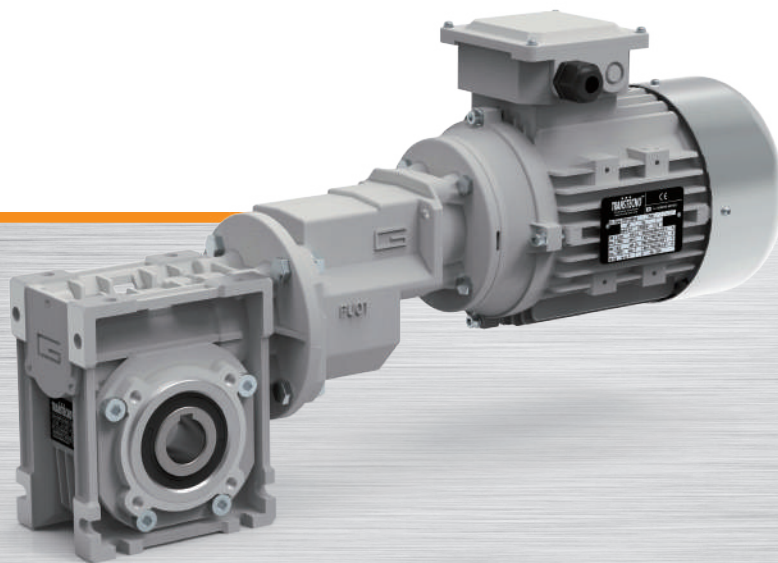



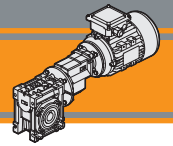

索引	<i>Index</i>	页码 <i>Page</i>
技术特征	<i>Technical features</i>	<b>J2</b>
选型	<i>Classification</i>	<b>J2</b>
运转方向	<i>Direction of rotation</i>	<b>J3</b>
代号说明	<i>Symbols</i>	<b>J3</b>
润滑油	<i>Lubrication</i>	<b>J4</b>
径向负荷	<i>Radial loads</i>	<b>J4</b>
IEC电机适配法兰	<i>IEC Motor adapters</i>	<b>J4</b>
技术参数	<i>Technical data</i>	<b>J6</b>
尺寸参数	<i>Dimensions</i>	<b>J10</b>
附件	<i>Accessories</i>	<b>J12</b>
可选项	<i>Options</i>	<b>J13</b>

该目录为最新版本，可替代以往的任何版本及修订。如果您是通过非正式渠道取得，不能保证是最新内容，可在本公司网站上查阅  
[www.transtecno.com](http://www.transtecno.com)

*This section replaces any previous edition and revision. If you obtained this catalogue other than through controlled distribution channels, the most up to date content is not guaranteed. In this case the latest version is available on our web site [www.transtecno.com](http://www.transtecno.com)*

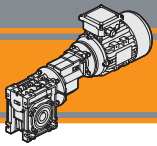

# CMPU 蜗轮蜗杆减速电机配PU前置级

## PU Pre-stage wormgearmotors

### 技术特征

### Technical features

CMPU系列减速电机具有高度模块化的设计特点，可以与输入输出组件任意组合。

The high degree of modularity is a design feature of CMPU wormgearmotors range thanks to a wide selection of input and output kits.

CMPU系列的主要特征:

Main features of CMPU range are:

- 采用压铸铝合金箱体;
- 型号CM090使用成对圆锥滚柱轴承;
- 使用长寿命人工合成润滑油。

- Die cast aluminium housing
- Double taper roller bearing on size 090
- Permanent synthetic oil long life lubrication

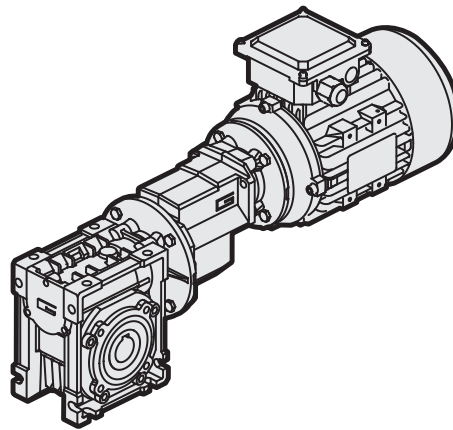

### 选型

前置蜗轮蜗杆减速机组 / PRE-STAGE WORMGEARBOX

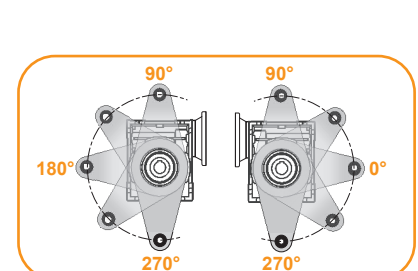
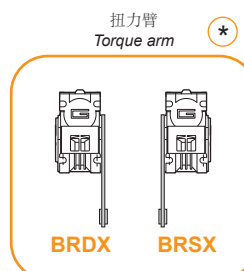
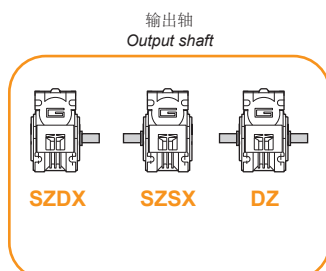
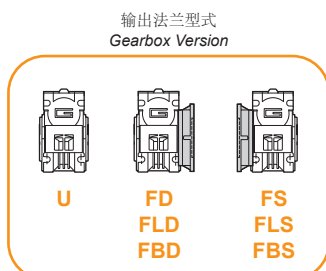
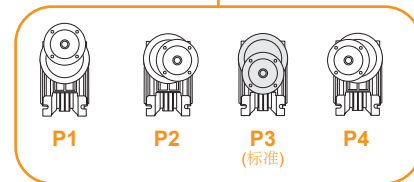

CMPU	01/050	U	57	71	B14	SZDX	BRSX	90	P4	M1	VS
类型 Type	型号 Size	输出法兰型式 Gearbox Version	速比 Ratio	IEC 	法兰型号 Version	输出轴 Output shaft	扭力臂 Torque arm	角度 Angle	前置级安装位置 Pre stage mounting position	安装位置 Mounting position	可选项 Options
	01/050 01/063 01/070 01/075 01/090	U FD FS FLD FLS FBD FBS	见表格 See tables	63 71 80	B5 B14	SZDX SZSX DZ	BRDX BRSX	0° 90° 180° 270°	P1 P2 P3 (标准) P4	M1 (B3) M2 (V6) M3 (B8) M4 (V5) M6 (B6) M5 (B7)	VS

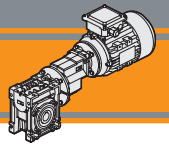

\* 注意: 扭力臂将不组装, 单独提供。  
NOTE: the torque arm will be supplied not assembled.



选型

三相电机 / THREE PHASE MOTOR									
TS	63	2	4	0.18 kW	B5	3 ph	230-400 V	50 Hz	T1
类型 Type	型号 Size	功率系数 Power coefficient	极 Poles	功率 Power	法兰型号 Version	相 Phases	电压 Voltage	效率 Frequency	接线盒位置 Terminal box pos.
TS		1-2-3-S L1-L2	4	0.09 kW ... 2.2 kW	B5 B14	3 ph	230-400 V 275-480 V	50Hz 60Hz	

运转方向

Direction of rotation

CMPU

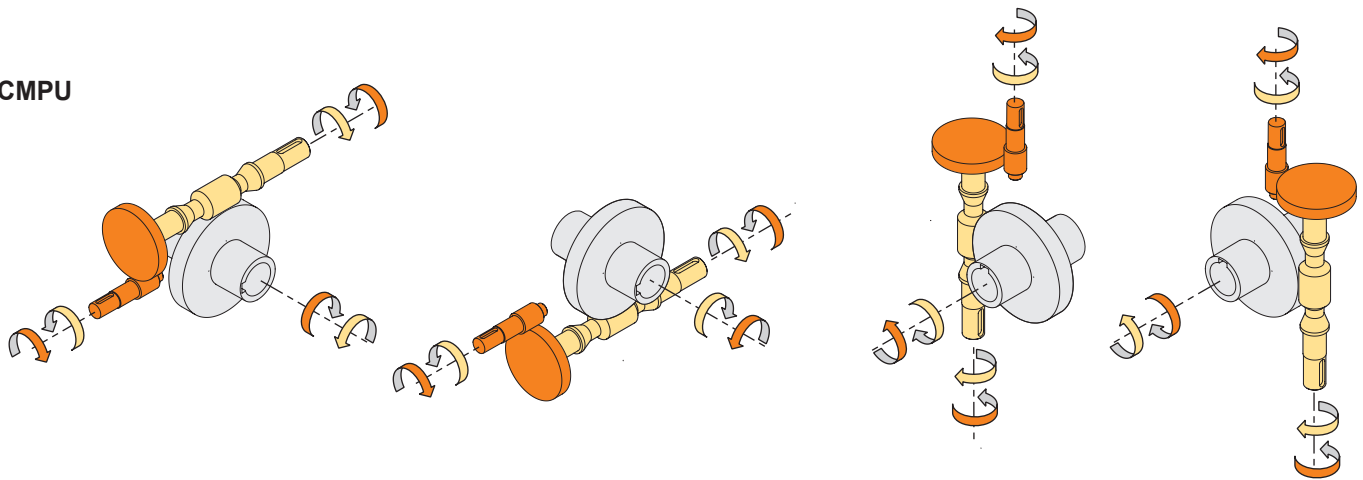

代号说明

Symbols

- $n_1$  [ $\text{min}^{-1}$ ] 输入转速 / Input speed
- $n_2$  [ $\text{min}^{-1}$ ] 输出转速 / Output speed
- $i$  速比 / Ratio
- $P_1$  [kW] 输入功率 / Input power
- $M_2$  [Nm] 输出扭矩参照 $P_1$  / Output torque referred to  $P_1$
- $sf$  服务系数 / Service factor
- $R_2$  [N] 输出端许用径向负荷 / Permitted output radial load
- $A_2$  [N] 输出端许用轴向负荷 / Permitted output axial load
-  [kg] 减速机重量 / Weight of the gearbox only



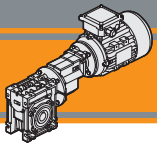

# CMPU 蜗轮蜗杆减速电机配PU前置级 PU Pre-stage wormgearmotors

## 润滑油

## Lubrication

使用粘度320的长寿命人工合成润滑油，可以在任意安装位置上使用。因此，该系列可以在任意位置进行安装并免维护。

*Permanent synthetic oil long-life lubrication (viscosity grade 320) makes it possible to use the gearmotors in all mounting positions; for this reason they can be installed in any assembly position and do not require maintenance.*

## 径向负荷

## Radial loads

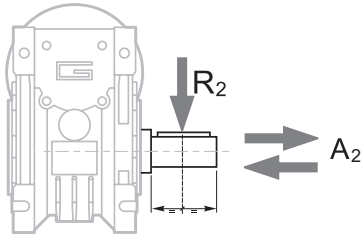

$$A_2 = R_2 \times 0.2$$

n <sub>2</sub> [min <sup>-1</sup> ]	R <sub>2</sub> [N]				
	CMPU 01/050	CMPU 01/063	CMPU 01/070	CMPU 01/075	CMPU 01/090
47	2805	3874	4141	4475	5009
35	3095	4273	4568	4937	5526
28	3334	4603	4921	5318	5953
23	3559	4915	5254	5678	6356
18	3862	5334	5702	6162	6897
14	4200	5800	6200	6700	7500

当产生的径向负荷不是作用在传动轴的中间位置，必须用以下公式来计算有效负荷：

*When the resulting radial load is not applied on the centre line of the shaft it is necessary to calculate the effective load with the following formula:*

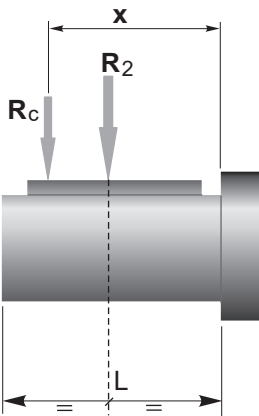

	CMPU				
	01/050	01/063	01/070	01/075	01/090
a	101	120	122	131	182
b	76	95	92	101	122
R <sub>2MAX</sub>	4200	5800	6200	6700	7500

$$R_c = \frac{R_2 \cdot a}{(b + x)} \leq R_{2MAX}$$

$$R \leq R_c$$

a, b = 图标中给出的值  
a, b = values given in the table

## IEC电机适配法兰

## IEC Motor adapters

CMPU01/...	TS		
	6314 6324 6334	7114 7124 7134 7144	8024 8034

备注：灰色部分指该型号有适合的电机输入。

*N.B. Grey areas indicate motor inputs available on each size of unit.*

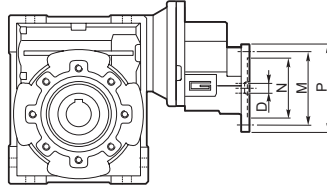
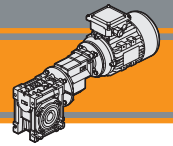

CMPU	IEC	N	M	P	D	i (i <sub>1</sub> x i <sub>2</sub> )									
						28.5 (5,7x5)	42.75 (5,7x7,5)	57 (5,7x10)	64.28 (8,57x7,5)	85.5 (5,7x15)	85.7 (8,57x10)	114 (5,7x20)	128.55 (8,57x15)	142.5 (5,7x25)	171 (5,7x30)
01/050	63B5	95	115	140	11	BS	BS	BS	BS	BS	BS	BS	BS	BS	BS
	63B14	60	75	90											
	71B5	110	130	160	14	B	B	B	B	B	B	B	B	B	
	71B14	70	85	105											
	80B5	130	165	200	19										
80B14	80	100	120												
01/063	63B5	95	115	140	11	BS	BS	BS	BS	BS	BS	BS	BS	BS	
	63B14	60	75	90											
	71B5	110	130	160	14	B	B	B	B	B	B	B	B		
	71B14	70	85	105											
	80B5	130	165	200	19										
80B14	80	100	120												
01/070	63B5	95	115	140	11	-	BS	BS	BS	BS	BS	BS	BS	BS	
	63B14	60	75	90											
	71B5	110	130	160	14	-	B	B	B	B	B	B	B		
	71B14	70	85	105											
	80B5	130	165	200	19	-									
80B14	80	100	120												
01/075	63B5	95	115	140	11	-	BS	BS	BS	BS	BS	BS	BS	BS	
	63B14	60	75	90											
	71B5	110	130	160	14	-	B	B	B	B	B	B	B		
	71B14	70	85	105											
	80B5	130	165	200	19	-									
80B14	80	100	120												
01/090	63B5	95	115	140	11	-	BS	BS	BS	BS	BS	BS	BS	BS	
	63B14	60	75	90											
	71B5	110	130	160	14	-	B	B	B	B	B	B	B		
	71B14	70	85	105											
	80B5	130	165	200	19	-									
80B14	80	100	120												

CMPU	IEC	N	M	P	D	i (i <sub>1</sub> x i <sub>2</sub> )									
						228 (5,7x40)	257.1 (8,57x30)	285 (5,7x50)	342.8 (8,57x40)	428.5 (8,57x50)	456 (5,7x80)	514.2 (8,57x60)	570 (5,7x100)	685.6 (8,57x80)	857 (8,57x100)
01/050	63B5	95	115	140	11		BS								
	63B14	60	75	90											
	71B5	110	130	160	14		B								
	71B14	70	85	105											
	80B5	130	165	200	19										
80B14	80	100	120												
01/063	63B5	95	115	140	11	BS	BS	BS	BS	BS		BS			
	63B14	60	75	90											
	71B5	110	130	160	14	B	B	B	B	B		B			
	71B14	70	85	105											
	80B5	130	165	200	19										
80B14	80	100	120												
01/070	63B5	95	115	140	11	BS	BS	BS	BS	BS	BS	BS	BS		
	63B14	60	75	90											
	71B5	110	130	160	14	B	B	B	B	B	B	B			
	71B14	70	85	105											
	80B5	130	165	200	19										
80B14	80	100	120												
01/075	63B5	95	115	140	11	BS	BS	BS	BS	BS	BS	BS	BS		
	63B14	60	75	90											
	71B5	110	130	160	14	B	B	B	B	B	B	B			
	71B14	70	85	105											
	80B5	130	165	200	19										
80B14	80	100	120												
01/090	63B5	95	115	140	11	BS	BS	BS	BS	BS	BS	BS	BS		
	63B14	60	75	90											
	71B5	110	130	160	14	B	B	B	B	B	B	B			
	71B14	70	85	105											
	80B5	130	165	200	19										
80B14	80	100	120												

备注：灰色部分指该型号有适合的电机输入。

N.B. Grey areas indicate motor inputs available on each size of unit.

B/BS = 金属轴套

B/BS = Metal shaft sleeve

CMPU

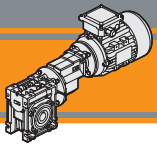

# CMPU 蜗轮蜗杆减速电机配PU前置级 PU Pre-stage wormgearmotors

## 技术参数

## Technical data

P <sub>1</sub> [kW]	n <sub>2</sub> [min <sup>-1</sup> ]	M <sub>2</sub> [Nm]	sf	i	
------------------------	--	------------------------	----	---	---

P <sub>1</sub> [kW]	n <sub>2</sub> [min <sup>-1</sup> ]	M <sub>2</sub> [Nm]	sf	i	
------------------------	--	------------------------	----	---	---

0.12					
TS6314 (1400 min <sup>-1</sup> )	49	18	8.5	28.50	<b>CMPU01/050</b>
	33	27	5.8	42.75	
	25	35	4.5	57.00	
	22	41	3.8	64.28	
	16	49	3.3	85.50	
	16	52	3.0	85.70	
	12	62	2.2	114.00	
	11	74	2.2	128.55	
	10	73	1.7	142.50	
	8	80	2.0	171.00	
	6.5	110	1.1	214.25	
	5.4	120	1.4	257.10	
	6.5	108	2.1	214.25	<b>CMPU01/063</b>
	6.1	99	2.6	228.00	
	5.4	124	2.5	257.10	
	4.9	114	2.0	285.00	
	4.1	148	1.8	342.80	
	3.3	172	1.3	428.50	
	2.7	190	1.1	514.20	<b>CMPU01/070</b>
	3.3	172	2.0	428.50	
	3.1	146	1.9	456.00	
	2.7	190	1.7	514.20	
	2.5	165	1.4	570.00	
	2.0	220	1.2	685.60	
1.6	247	0.9	857.00	<b>CMPU01/075</b>	
2.5	165	1.8	570.00		
2.0	220	1.5	685.60		
1.6	247	1.2	857.00		
2.0	242	2.2	685.60	<b>CMPU01/090</b>	
1.6	268	1.8	857.00		

0.18					
TS6324 (1400 min <sup>-1</sup> )	49	27	5.6	28.50	<b>CMPU01/050</b>
	33	41	3.8	42.75	
	25	52	3.0	57.00	
	22	61	2.6	64.28	
	16	74	2.2	85.50	
	16	78	2.0	85.70	
	12	93	1.5	114.00	
	11	111	1.4	128.55	
	10	110	1.1	142.50	
	8	119	1.4	171.00	
	5	179	0.9	257.10	
	12	92	2.8	114.00	
	11	110	2.8	128.55	
	10	108	2.1	142.50	
	8	123	2.5	171.00	
	6.5	162	1.4	214.25	
	6.1	148	1.8	228.00	
	5.4	186	1.7	257.10	<b>CMPU01/070</b>
	4.9	171	1.4	285.00	
	4.1	223	1.2	342.80	
	3.3	258	0.9	428.50	
	6.5	168	2.0	214.25	
	6.1	148	2.6	228.00	
	5.4	186	2.4	257.10	<b>CMPU01/075</b>
4.9	171	2.0	285.00		
4.1	223	1.7	342.80		
3.3	258	1.3	428.50		
3.1	219	1.2	456.00	<b>CMPU01/090</b>	
2.7	285	1.1	514.20		
2.5	247	0.9	570.00		
3.3	258	1.6	428.50		
3.1	219	1.5	456.00		
2.7	291	1.3	514.20		
2.5	247	1.2	570.00	<b>CMPU01/075</b>	
2.0	330	1.0	685.60		
2.7	316	2.0	514.20		
2.5	267	1.8	570.00		
2.0	363	1.5	685.60	<b>CMPU01/090</b>	
1.6	402	1.2	857.00		



电机 Motors	TS
	6314 6324
IEC	63 B5 / B14



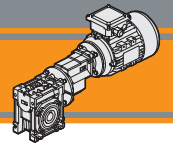

技术参数

Technical data

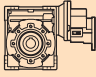
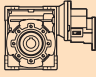
$P_1$ [kW]	$n_2$ [min <sup>-1</sup> ]	$M_2$ [Nm]	sf	i		$P_1$ [kW]	$n_2$ [min <sup>-1</sup> ]	$M_2$ [Nm]	sf	i		
<b>0.25</b>						<b>0.37</b>						
TS6334	<b>49</b>	38	4.1	28.50	<b>CMPU01/050</b>	TS7124	<b>49</b>	56	2.7	28.50	<b>CMPU01/050</b>	
TS7114	<b>33</b>	56	2.8	42.75		(1400 min <sup>-1</sup> )	<b>33</b>	84	1.9	42.75		
(1400 min <sup>-1</sup> )	<b>25</b>	72	2.1	57.00		<b>25</b>	107	1.4	57.00			
	<b>22</b>	85	1.8	64.28		<b>22</b>	126	1.2	64.28			
	<b>16</b>	103	1.6	85.50		<b>16</b>	152	1.1	85.50			
	<b>16</b>	109	1.4	85.70		<b>16</b>	161	1.0	85.70			
	<b>12</b>	130	1.1	114.00								
	<b>11</b>	155	1.0	128.55			<b>25</b>	109	2.6	57.00		<b>CMPU01/063</b>
	<b>10</b>	152	0.8	142.50			<b>22</b>	127	1.9	64.28		
	<b>8</b>	166	1.0	171.00			<b>16</b>	150	2.0	85.50		
						<b>16</b>	163	1.8	85.70			
	<b>16</b>	110	2.6	85.70	<b>CMPU01/063</b>	<b>12</b>	189	1.4	114.00			
	<b>12</b>	128	2.0	114.00			<b>11</b>	226	1.3	128.55		
	<b>11</b>	153	2.0	128.55			<b>10</b>	222	1.0	142.50		
	<b>10</b>	150	1.5	142.50			<b>8</b>	254	1.2	171.00		
	<b>8</b>	171	1.8	171.00			<b>6.5</b>	334	0.7	214.25		
	<b>6.5</b>	226	1.0	214.25			<b>6.1</b>	305	0.9	228.00		
	<b>6.1</b>	206	1.3	228.00								
	<b>5.4</b>	258	1.2	257.10			<b>12</b>	192	2.0	114.00	<b>CMPU01/070</b>	
	<b>4.9</b>	238	1.0	285.00			<b>11</b>	229	1.9	128.55		
							<b>10</b>	229	1.5	142.50		
						<b>8</b>	254	1.8	171.00			
	<b>10</b>	155	2.2	142.50	<b>CMPU01/070</b>	<b>6.5</b>	344	1.0	214.25			
	<b>8</b>	171	2.6	171.00			<b>6.1</b>	305	1.2	228.00		
	<b>6.5</b>	233	1.5	214.25			<b>5.4</b>	382	1.2	257.10		
	<b>6.1</b>	206	1.8	228.00			<b>4.9</b>	352	1.0	285.00		
	<b>5.4</b>	258	1.8	257.10								
	<b>4.9</b>	238	1.4	285.00			<b>6.5</b>	344	1.2	214.25	<b>CMPU01/075</b>	
	<b>4.1</b>	309	1.2	342.80			<b>6.1</b>	310	1.5	228.00		
	<b>3.3</b>	358	0.9	428.50			<b>5.4</b>	382	1.4	257.10		
	<b>3.1</b>	305	0.9	456.00			<b>4.9</b>	352	1.1	285.00		
	<b>4.9</b>	238	1.7	285.00		<b>CMPU01/075</b>	<b>4.1</b>	466	1.0	342.80		
	<b>4.1</b>	315	1.5	342.80								
	<b>3.3</b>	358	1.1	428.50			<b>6.5</b>	366	1.9	214.25	<b>CMPU01/090</b>	
	<b>3.1</b>	305	1.1	456.00			<b>6.1</b>	327	2.5	228.00		
	<b>2.7</b>	404	0.9	514.20			<b>5.4</b>	401	2.4	257.10		
							<b>4.9</b>	381	1.8	285.00		
	<b>4.1</b>	332	2.4	342.80	<b>CMPU01/090</b>		<b>4.1</b>	492	1.7	342.80		
	<b>3.3</b>	387	1.8	428.50				<b>3.3</b>	572	1.2	428.50	
	<b>3.1</b>	335	1.6	456.00				<b>3.1</b>	496	1.1	456.00	
	<b>2.7</b>	438	1.4	514.20				<b>2.7</b>	649	1.0	514.20	
	<b>2.5</b>	372	1.3	570.00			<b>2.5</b>	550	0.9	570.00		
	<b>2.0</b>	504	1.1	685.60								
	<b>1.6</b>	559	0.9	857.00								

CMPU



电机 Motors	<b>TS</b>	
	6334	7114 7124
<b>IEC</b>	63 B5 / B14	71 B5 / B14

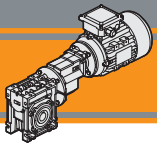

# CMPU 蜗轮蜗杆减速电机配PU前置级 PU Pre-stage wormgearmotors

## 技术参数

## Technical data

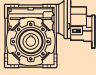
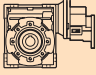
$P_1$ [kW]	$n_2$ [min <sup>-1</sup> ]	$M_2$ [Nm]	sf	i		$P_1$ [kW]	$n_2$ [min <sup>-1</sup> ]	$M_2$ [Nm]	sf	i	
<b>0.55</b>						<b>0.75</b>					
TS7134	<b>49</b>	84	1.8	28.50	<b>CMPU01/050</b>	TS7144	<b>49</b>	114	1.4	28.50	<b>CMPU01/050</b>
TS8014	<b>33</b>	124	1.3	42.75		TS8024	<b>33</b>	169	0.9	42.75	
(1400 min <sup>-1</sup> )	<b>25</b>	159	1.0	57.00		(1400 min <sup>-1</sup> )	<b>49</b>	116	1.8	28.50	
	<b>49</b>	85	2.4	28.50	<b>CMPU01/063</b>	<b>33</b>	171	1.7	42.75		
	<b>33</b>	126	2.3	42.75		<b>25</b>	220	1.3	57.00		
	<b>25</b>	161	1.8	57.00		<b>22</b>	258	0.9	64.28		
	<b>22</b>	189	1.3	64.28		<b>16</b>	304	1.0	85.50		
	<b>16</b>	223	1.4	85.50		<b>16</b>	331	0.9	85.70		
	<b>16</b>	243	1.2	85.70		<b>CMPU01/070</b>	<b>33</b>	174	1.8	42.75	
	<b>12</b>	281	0.9	114.00			<b>25</b>	223	1.9	57.00	
	<b>11</b>	336	0.9	128.55			<b>22</b>	261	0.9	64.28	
	<b>22</b>	191	1.3	64.28	<b>16</b>		309	1.4	85.50		
	<b>16</b>	226	1.9	85.50	<b>16</b>		335	0.9	85.70		
	<b>16</b>	246	1.3	85.70	<b>CMPU01/070</b>	<b>12</b>	389	1.0	114.00		
	<b>12</b>	285	1.4	114.00		<b>11</b>	464	0.9	128.55		
	<b>11</b>	340	1.3	128.55		<b>8</b>	514	0.9	171.00		
	<b>10</b>	341	1.0	142.50		<b>CMPU01/075</b>	<b>22</b>	261	0.9	64.28	
	<b>8</b>	377	1.2	171.00			<b>16</b>	313	1.7	85.50	
	<b>12</b>	289	1.6	114.00			<b>16</b>	335	0.9	85.70	
	<b>11</b>	345	1.3	128.55			<b>12</b>	394	1.2	114.00	
	<b>10</b>	341	1.2	142.50			<b>11</b>	470	0.9	128.55	
	<b>8</b>	377	1.5	171.00		<b>CMPU01/075</b>	<b>10</b>	464	0.9	142.50	
	<b>6.5</b>	512	0.8	214.25			<b>8</b>	514	1.1	171.00	
	<b>6.1</b>	461	1.0	228.00	<b>CMPU01/090</b>		<b>16</b>	322	2.7	85.50	
	<b>5.4</b>	567	1.0	257.10			<b>16</b>	348	0.9	85.70	
	<b>11</b>	354	1.3	128.55			<b>12</b>	412	2.0	114.00	
	<b>10</b>	362	2.0	142.50		<b>11</b>	483	0.9	128.55		
	<b>8</b>	396	2.4	171.00		<b>10</b>	493	1.4	142.50		
	<b>6.5</b>	544	1.3	214.25	<b>CMPU01/090</b>	<b>8</b>	540	1.7	171.00		
	<b>6.1</b>	486	1.7	228.00		<b>6.5</b>	741	1.0	214.25		
	<b>5.4</b>	596	1.3	257.10		<b>6.1</b>	663	1.2	228.00		
	<b>4.9</b>	566	1.2	285.00		<b>5.4</b>	812	0.9	257.10		
	<b>4.1</b>	731	1.1	342.80		<b>4.9</b>	772	0.9	285.00		



电机 Motors	TS	
	7134 7144	8014 8024
IEC	71 B5 / B14	80 B5 / B14

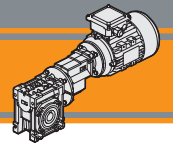

技术参数

Technical data

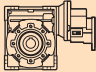
$P_1$ [kW]	$n_2$ [min <sup>-1</sup> ]	$M_2$ [Nm]	sf	i	
<b>1.1</b>					
TS8034 (1400 min <sup>-1</sup> )	<b>49</b>	168	0.9	28.50	<b>CMPU01/050</b>
	<b>49</b>	170	1.2	28.50	<b>CMPU01/063</b>
	<b>33</b>	251	1.2	42.75	
	<b>25</b>	323	0.9	57.00	
	<b>33</b>	255	1.2	42.75	<b>CMPU01/070</b>
	<b>25</b>	327	1.2	57.00	
	<b>16</b>	453	1.0	85.50	
	<b>33</b>	255	1.2	42.75	<b>CMPU01/075</b>
	<b>25</b>	327	1.2	57.00	
	<b>16</b>	459	1.2	85.50	
	<b>33</b>	261	1.2	42.75	<b>CMPU01/090</b>
	<b>25</b>	340	1.2	57.00	
	<b>16</b>	472	1.2	85.50	
	<b>12</b>	604	1.2	114.00	
	<b>10</b>	723	1.0	142.50	
	<b>8</b>	792	1.2	171.00	



电机 Motors	TS
	8034
IEC	80 B5 / B14

CMPU

电机技术参数

请见专用页面:

Electrical technical data

Please see the dedicated paragraph:

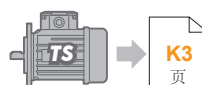

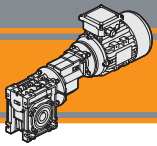

# CMPU 蜗轮蜗杆减速电机配PU前置级 PU Pre-stage wormgearmotors

尺寸参数

Dimensions

CMPU.. - CMPU..F - CMPU..FB - CMPU..FL														
	A	C	D <sub>H8</sub>	E	F	G1	H	HX	I	K	L	M	N <sub>H8</sub>	N1
01/050	80	120	25	144	49	92	60	36.5	50	70	85	85	70	43.5
01/063	100	144	25	174	67	112	72	36.5	63	85	104	95	80	53
01/070	110	160	28	195	64	120	80	36.5	70	90	104	115	95	57
01/075	120	172	28	205	72	120	86	36.5	75	90	112	115	95	57
01/090	140	208	35	238	74	140	103	36.5	90	100	130	130	110	67

CMPU.. - CMPU..F - CMPU..FB - CMPU..FL													
	O	P	Q	R	S	T	V	Z	KE	a	b	t	kg <sup>(*)</sup>
01/050	8.5	98	64	84	7	30	40	210	M8x10(n.4)	45°	8	28.3 (27.3)	6.0
01/063	8.5	110	80	102	8	36	50	228	M8x14(n.8)	45°	8	28.3	8.7
01/070	9	130	91	115	9	40	55	238	M8x14(n.8)	45°	8	31.3	10.0
01/075	11	140	93	119	10	40	60	243	M8x14(n.8)	45°	8	31.3	11.5
01/090	13	160	102	135	11	45	70	260	M10x18(n.8)	45°	10	38.3	15.5

(\*) 注释: 重量Kg仅指减速机的重量  
Note: The weight in kg is referred to only the gearmotor

	CMPU..F								CMPU..FB								CMPU..FL							
	a1	KA	KB	KC	KM	KN <sub>H8</sub>	KO	KP	KQ	KA	KB	KC	KM	KN <sub>H8</sub>	KO	KP	KA	KB	KC	KM	KN <sub>H8</sub>	KO	KP	KQ
01/050	45°	90	9	5	90-110	70	11(n.4)	125	110	89	9	5	130-145	110	9.5(n.4)	160	120	9	5	90-110	70	11(n.4)	125	110
01/063	45°	82	10	6	150-160	115	11(n.4)	180	142	98	10	5	165-180	130	11(n.4)	200	112	10	6	150-160	115	11(n.4)	180	142
01/070	45°	111	13	6	165-180	130	14(n.4)	200	170	—	—	—	—	—	—	—	—	—	—	—	—	—	—	—
01/075	45°	111	13	6	165-180	130	14(n.4)	200	170	—	—	—	—	—	—	—	—	—	—	—	—	—	—	—
01/090	45°	111	13	6	175-190	152	14(n.4)	210	200	—	—	—	—	—	—	—	—	—	—	—	—	—	—	—

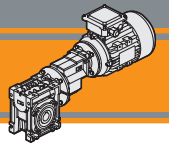

尺寸参数

Dimensions

CMPU..U

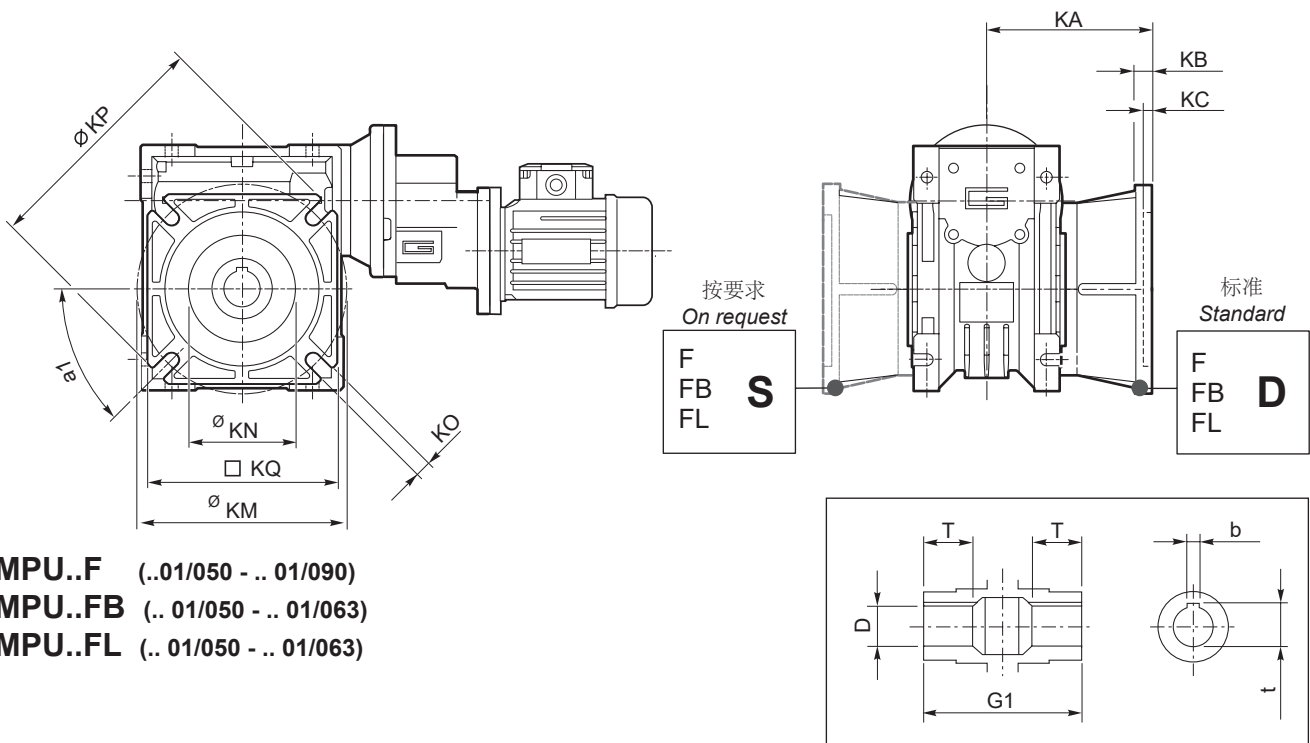
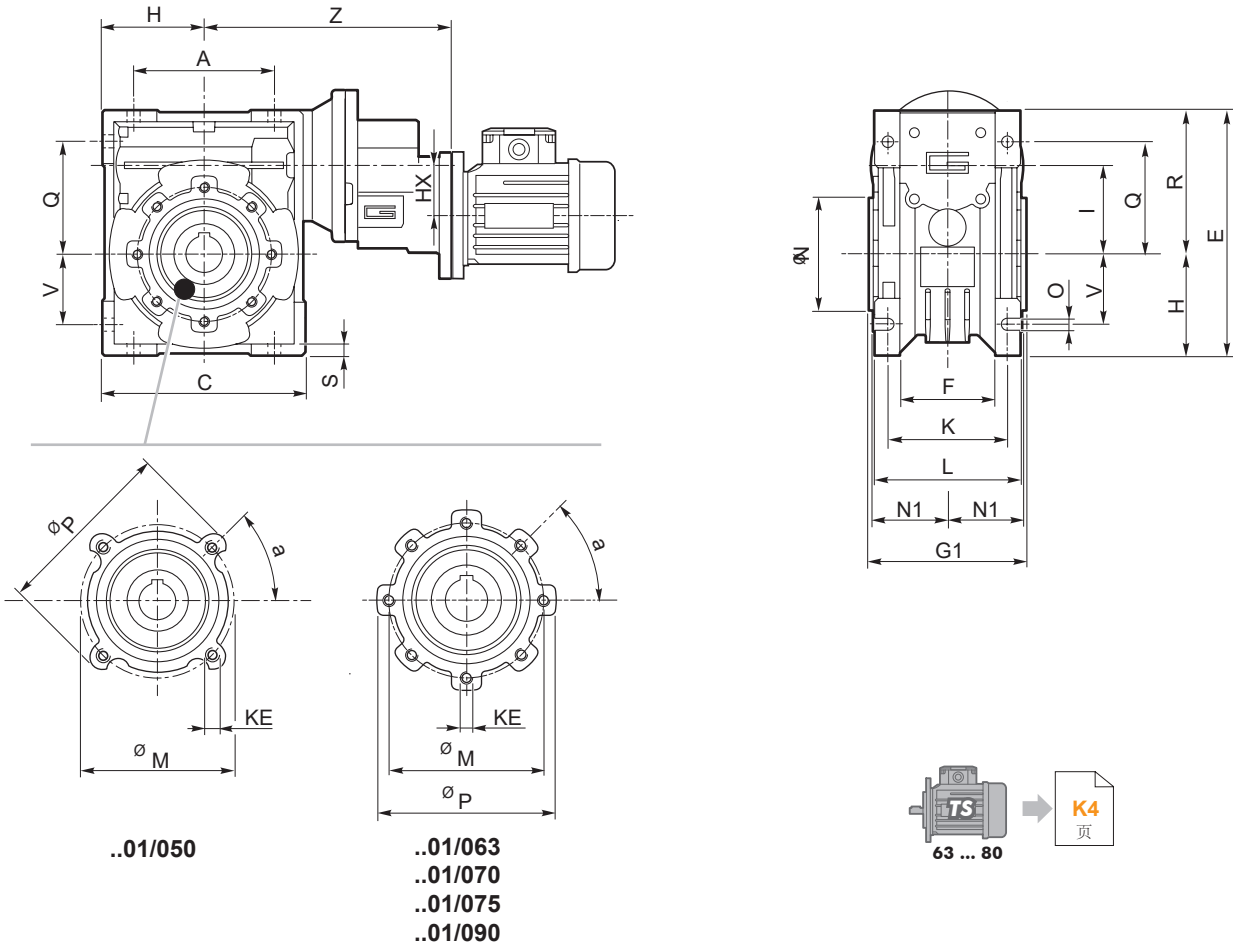

- CMPU..F (..01/050 - .. 01/090)
- CMPU..FB (.. 01/050 - .. 01/063)
- CMPU..FL (.. 01/050 - .. 01/063)

CMPU

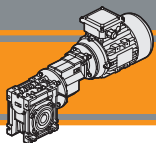

附件

Accessories

单向和双向输出轴

Single and double output shaft

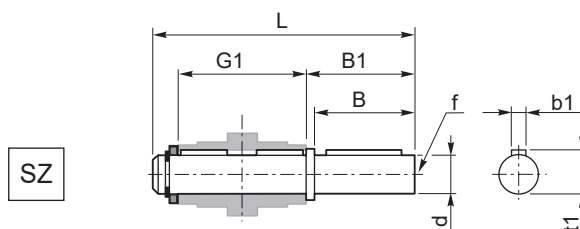
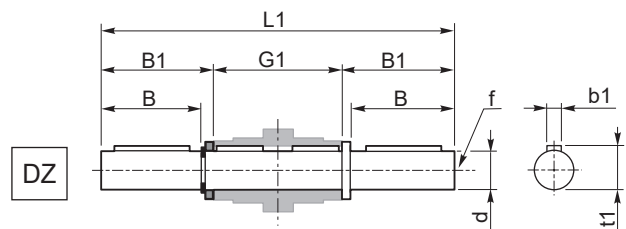

CMPU	d <sub>h7</sub>	B	B1	G1	L	L1	f	b1	t1
01/050	25	50	53.5	92	153	199	M10	8	28
01/063	25	50	53.5	112	173	219	M10	8	28
01/070	28	60	63.5	120	192	247	M10	8	31
01/075	28	60	63.5	120	192	247	M10	8	31
01/090	35	80	84.5	140	234	309	M12	10	38

扭力臂

Torque arm

CMPU	K1	G	KG	KH	R
01/050	100	14	38	10	18
01/063	150	14	47.5	10	18
01/070	200	25	46.5	20	30
01/075	200	25	46.5	20	30
01/090	200	25	56.5	20	30

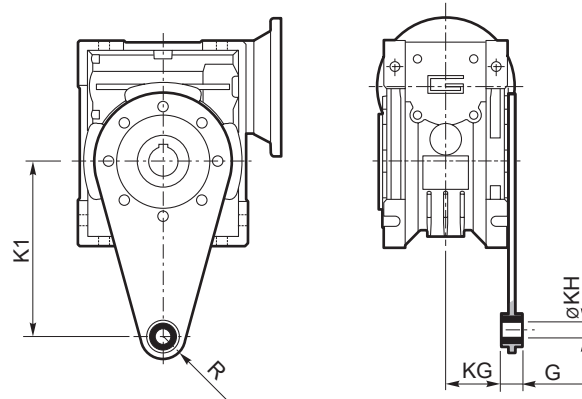

SC - 防护罩 / Safety Cover

CMPU	M
01/050	62.5
01/063	73
01/070	75
01/075	79
01/090	94

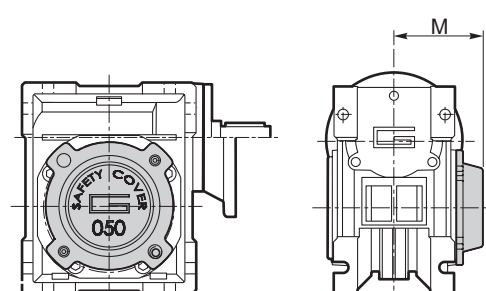

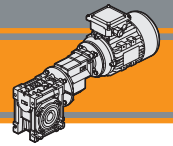

**VS - 加长输入轴 / Extended input shaft**

CMPU	A	B	D <sub>1</sub> j6	E	F	G
01/050	64	30	14	M6	5	16
01/063	75	40	19	M6	6	21.5
01/070	84	40	19	M6	6	21.5
01/075	90	50	24	M8	8	27
01/090	108	50	24	M8	8	27

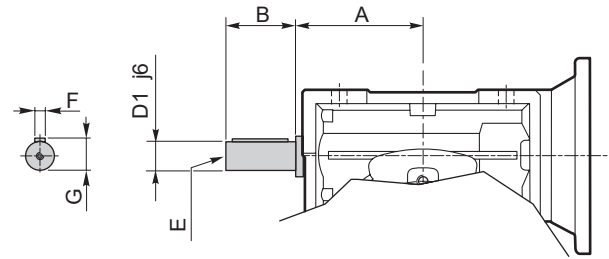

 按需求定制  
Built on request





 **TRANSTECNO SRL**  
**HEADQUARTERS**

Company subject to the management  
and coordination of INTERPUMP GROUP SPA  
Via Caduti di Sabbiano, 11/D-E  
40011 Anzola dell'Emilia (BO)  
ITALY  
T+39 051 64 25 811  
F +39 051 73 49 43  
sales@transtecno.com  
[www.transtecno.com](http://www.transtecno.com)

  
**TRANSTECNO®**  
the modular gearmotor  
MEMBER OF INTERPUMP GROUP



 **HANGZHOU INTERPUMP  
POWER TRANSMISSIONS CO LTD**  
No.4 Xiuyan Road Fengdu Industry Zone  
Pingyao Town Yuhang District  
Hangzhou City, Zhejiang Province  
311115 – CHINA  
T +86 571 86 92 02 60  
info-china@transtecno.cn  
[www.transtecno.cn](http://www.transtecno.cn)

 **TRANSTECNO IBÉRICA  
THE MODULAR GEARMOTOR, S.A.**  
Carrer de la Ciència, 45  
08840 Viladecans (Barcelona) - SPAIN  
T +34 931 598 950  
info@transtecno.es  
[www.transtecno.es](http://www.transtecno.es)

 **TRANSTECNO B.V.**  
Siliciumweg 32  
3812 SX Amersfoort - NETHERLANDS  
T +31(0) 33 45 19 505  
info@transtecno.nl  
[www.transtecno.nl](http://www.transtecno.nl)

 **TRANSTECNO AANDRIJFTECHNIEK B.V.**  
Siliciumweg 32  
3812 SX Amersfoort - NETHERLANDS  
T +31 (0) 33 20 47 006  
info@transtecnoaandrijftechnik.nl  
[www.transtecnoaandrijftechnik.nl](http://www.transtecnoaandrijftechnik.nl)

 **MA TRANSTECNO S.A.P.I. DE C.V.**  
Julián Sepúlveda Dávila #107,  
Parque Industrial SG  
Apodaca, Nuevo León, CP. 66640  
MÉXICO  
T +52 8113340920  
info@transtecno.com.mx  
[www.transtecno.com.mx](http://www.transtecno.com.mx)

 **TRANSTECNO USA**  
8 Creek Parkway,  
Boothwyn PA 19061-8136 - UNITED STATES  
T + 1 (610) 4970154

**TRANSTECNO USA – WEST COAST BRANCH**  
14561 Fryelands Blvd SE  
Monroe, WA 98272 - UNITED STATES  
T +1 360-863-1300  
usaoffice@transtecno.com  
[www.transtecno.com](http://www.transtecno.com)

 **TRANSTECNO CANADA**  
51 B Caldari Road Unit 10  
Vaughan, ON L4K 4G3 - CANADA  
T +1 905 761 0762  
canadaoffice@transtecno.com  
[www.transtecno.com](http://www.transtecno.com)

 **TRANSTECNO INDIA**  
#6A, Sipcot Industrial complex, Phase-1, Elasagiri Road  
Hosur – 635126 Tamilnadu - INDIA  
T +91 4344 274434  
M +91 81443 88800

**TRANSTECNO INDIA – NORTH BRANCH**  
Plot No: 3 A, Sector 2, IIE, Sidcul, Pantnagar  
U.S. Nagar, Uttarakhand – 263153 - INDIA  
indiaoffice@transtecno.com  
[www.transtecno.com](http://www.transtecno.com)

 **TRANSTECNO BRAZIL**  
Rua Gilberto de Zorzi, 525 Forqueta - CEP. 95115-730  
CX Postal 3544 Caxias do Sul RS – BRAZIL

**TRANSTECNO BRAZIL – SÃO PAULO BRANCH**  
R. Mafalda Barnabe Soliane, 314 – CEP. 13347-610  
Indaiatuba, São Paulo - BRAZIL  
T +55 19 3437 2520

**TRANSTECNO BRAZIL – PORTO ALEGRE BRANCH**  
Rua Dr. Freire Alemão 155 / 402 - CEP. 90450-060  
Auxiliadora Porto Alegre RS - BRAZIL  
T +55 51 4042 0916  
M +55 51 811 45 962  
braziloffice@transtecno.com  
[www.transtecno.com.br](http://www.transtecno.com.br)

 **INTERPUMP ANTRIEBSTECHNIK GMBH**  
Büro Stuttgart - GERMANY  
T +49 (0)171 4781909  
germanoffice@transtecno.com  
[www.transtecno.com](http://www.transtecno.com)

 **SALES OFFICE OCEANIA**  
Unit 5, 12 Nyholt Drive, Yatala 4207  
Queensland - AUSTRALIA  
T +61 07 3800 0103  
M +61 04 38060997

UNIT 9, 94 Boundary Rd, Sunshine West 3020  
Victoria - AUSTRALIA  
T +61 9312 4722  
oceaniaoffice@transtecno.com  
[www.transtecno.com.au](http://www.transtecno.com.au)